

Romney Court

Shepherds Bush, London, W12

 LAWSONRUTTER





Romney Court

Shepherds Bush, London, W12

Price Guide: £275,000

A well presented one bedroom flat located on the third floor of a popular Art Deco purpose built block overlooking Shepherds Bush Green. The flat which is bright and airy throughout comprises a 16'1 reception room, a modern kitchen, generous bedroom and a well fitted bathroom.

Romney Court is located on Shepherds Bush Green and is within a 4 – 5 minute walk to Goldhawk Road, Shepherds Bush stations (Central line & London overground) and Shepherds Bush Market station (Circle line and Hammersmith & City line) as well as the amenities of Westfield shopping centre and a variety of local bars and restaurants. The building also benefits from a lift. This would make an ideal pied - a - terre, investment or first time buy. No onward chain.

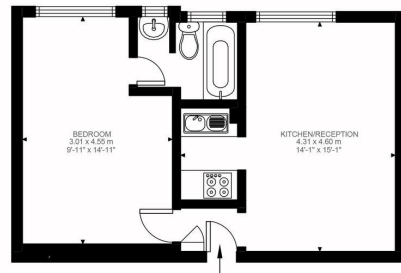

Third Floor
378 ft²

Well presented one bedroom flat located on third floor of popular Art Deco purpose built block

Bright & airy throughout | 16'1 reception room | Modern kitchen | Well fitted bathroom

Overlooking Shepherds Bush Green | Stones throw to Westfield shopping centre | No onward chain

Close to transport & a variety of amenities | 378 Sq. Ft. (35.14 Sq. M.) Leasehold

Full Energy Performance Certificate available on

All viewings by appointment through our **Hammersmith Office:**

T: 020 7385 7000
E: hammersmith@lawsonrutter.com

192 Fulham Palace Road, London W6 9PA

In accordance with the Property Misdescription Act 1991, we wish to emphasise that the information given in these particulars is intended to help you decide whether you wish to view this property. Whilst every care is taken to ensure the accuracy of these particulars please note that all measurements are approximate and we are, for the accuracy of other information, reliant on what the seller has provided. We strongly recommend that you rely on your own inspections and those of your advisors to establish the details of any aspects which are of particular importance. Please note that we have not undertaken any survey of the property or the appliances within it and the buyer must rely on their own investigations prior to exchange of contracts.



Romney Court W12
Approximate Gross Internal Area
35.14 SQ.M / 378 SQ.FT

KEY: CH = Ceiling Height
[Restricted Head Height]

Illustration for identification purposes only. Not to scale.
Floor Plan Drawn According To RICS Guidelines.

