



Berry Lane, SE21
£325,000

020 8702 8111
pedderproperty.com

pedder



In general

- A purpose built apartment located in this quiet residential cul-de-sac in West Dulwich
- Upgraded and modernised to a high standard
- One double bedroom
- Lounge/dining room
- Modern fitted kitchen, utility room
- Contemporary bathroom
- Secure entry
- Residents parking
- Beautifully presented throughout
- Sought after location

In detail

A lovely one bedroom purpose built apartment located in this quiet residential cul-de-sac in West Dulwich.

This light and bright apartment has been upgraded and modernised by the current owner to a high standard creating a beautifully presented interior. The accommodation comprises of one double bedroom, a lounge/dining room, modern fitted kitchen, utility room and contemporary bathroom. There is also secure entry and residents parking.

Berry Lane is well located within easy reach of West Dulwich and Dulwich Village with their numerous parks, outstanding schools, shops and restaurants. Crystal Palace is also close by offering numerous shopping and leisure facilities. Local shops can be found in nearby Gipsy Road and Park Hall Road. Excellent rail links to central London are from nearby West Dulwich (Victoria/Blackfriars), Gipsy Hill (London Bridge/Victoria) and Tulse Hill (London Bridge/Blackfriars via Thameslink).

An early viewing of this fine apartment is recommended.

EPC: C | Council Tax Band C | Lease: 107 Years Remaining | SC: £67.00 pcm | GR: Incl. in SC | BI:



Floorplan

Berry Lane SE21

Approximate Gross Internal Area
47.6 sq m / 512 sq ft

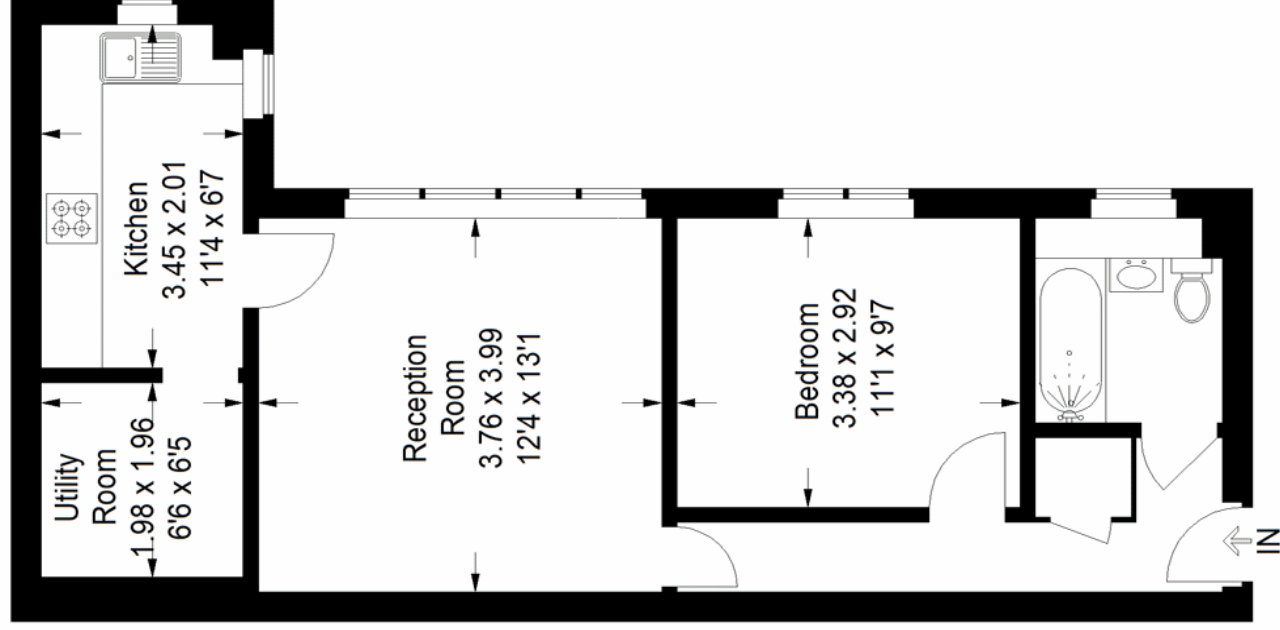

First Floor

Copyright www.pedderproperty.com © 2024

These plans are for representation purposes only as defined by RICS - Code of Measuring Practice. Not drawn to Scale. Windows and door openings are approximate. Please check all dimensions, shapes and compass bearings before making any decisions reliant upon them.