

eddissonwhite



London Road, Morden

Offers In Excess Of £375,000 Leasehold

First-floor apartment - 3 Double bedrooms - Parking spaces
Excellent condition - Modern bathroom - Separate cloakroom
Balcony - Living-dining room - Kitchen breakfast room
Leasehold - EPC Rating C - Central Morden location



Your Area



Your Agent



34 christchurch road • colliers wood • london SW19 2NX

t 020 8540 9828 f 020 8540 9866 e cw@eddissonwhite.co.uk w www.eddissonwhite.co.uk

London Road, Morden

First Floor

Approx. 80.8 sq. metres (869.7 sq. feet)

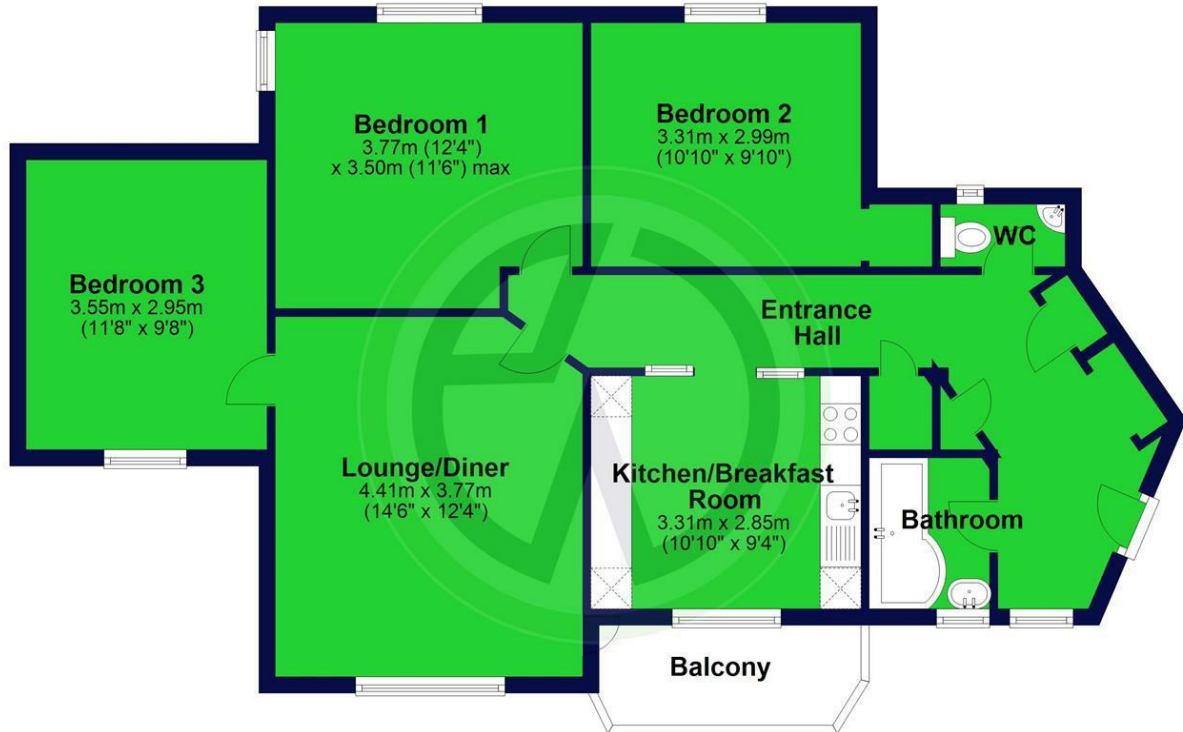

Total area: approx. 80.8 sq. metres (869.7 sq. feet)

Whilst every attempt has been made to ensure the accuracy of the floor plan, measurements of doors, windows and rooms are approximate and no responsibility is taken for any error, omission or misstatement. These plans are for representation only and should be used as such by prospective purchasers. Specifically no guarantee is given on the gross internal floor area of the property if quoted on this plan and any figure given is for guidance only and should not be relied on as a basis of valuation.
Plan produced using PlanUp.

- London Borough of Merton
- Tax Band C - £1,515.00
- Leasehold

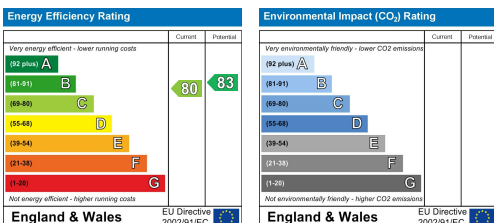

These details and any pictures or plans represent our opinion and are given in good faith for guidance only. They must not be construed as statements or fact. These particulars do not constitute part of an offer or contract. We have not tested the services, appliances or specified fittings and would highly recommend a purchaser to carry out their own survey on the property.

eddisonwhite

