

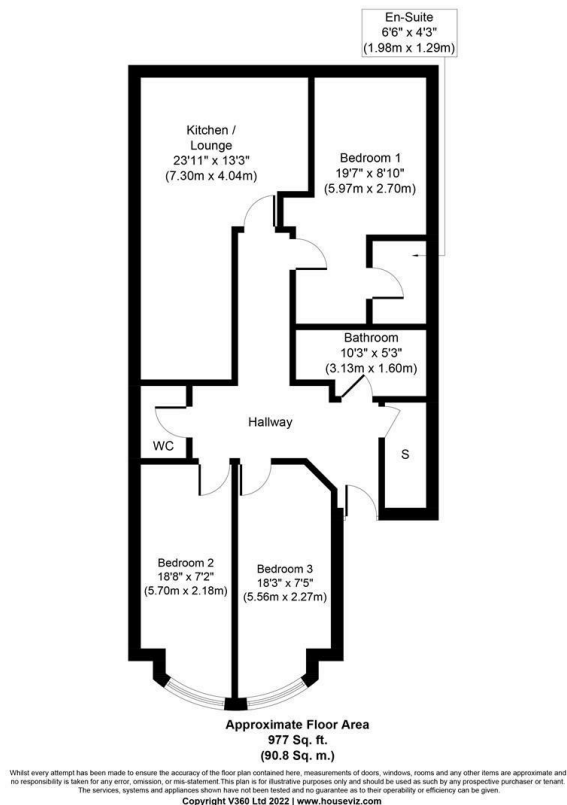

**Capital Homes**
Estate Agents & Valuers

82a Old Park Ridings, London N21 2ES
£499,000





Capital homes are delighted to bring to the market this spacious, three-bedroom, ground floor garden flat, offering fantastic living space throughout.

The flat is situated within an attractive period building and is available for purchase, chain free.

The property has been designed to an exceptionally high standard and offers wooden floors, sufficient storage space, contemporary open-plan kitchen with integrated units and appliances with modern fixtures and fittings. This unique, larger than average home, offers a newly installed En-suite in master bedroom.

The property is situated in the heart of the ever- popular grange park.

This stylish property benefits further from being situated close to Grange Park Railway Station (Zone 5), Winchmore Hill Station (Zone 4), reputable schools, local amenities, and popular parks such as Groveland's and Enfield Town Park.

Ideally, surrounding areas including Palmers Green, Southgate and Enfield are within easy access offering a broader selection of shopping facilities and transport links.

Please contact Capital Homes to arrange your viewing, viewings highly recommended to avoid disappointment!

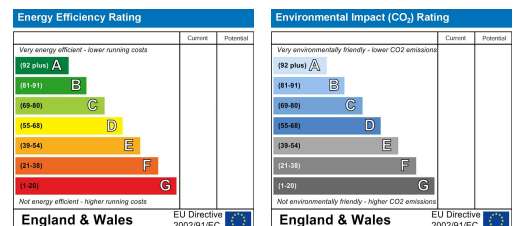

1 Turnpike Lane
London
N8 0EP

0208 342 5555
info@capitalhomesestates.co.uk
www.capitalhomesestates.co.uk

Agents Note: Whilst every care has been taken to prepare these particulars, they are for guidance purposes only. All measurements are approximate are for general guidance purposes only and whilst every care has been taken to ensure their accuracy, they should not be relied upon and potential buyers/tenants are advised to recheck the measurements