



8 Westbeech Road, London N22 6HT
Offers In The Region Of £430,000





Capital Homes are very pleased to offer this spacious, three-bedroom ground floor garden flat, located extremely close to both Wood Green & Turnpike Lane Station (Piccadilly line). Requiring some modernisation, this property offers fantastic living space throughout and consists of a large kitchen diner with direct access to garden, fully fitted bathroom with separate w/c, three large bedrooms & a huge lounge area.

To arrange your viewing, please contact Capital Homes on 0208-342-5555, early viewings highly recommended to avoid disappointment!

Attention First Time Buyers
Front Garden
Ideal for investment
Three Bedrooms
Garden Flat
Leasehold
Near Local Amenities
Close to Transport Links
In need of modernisation

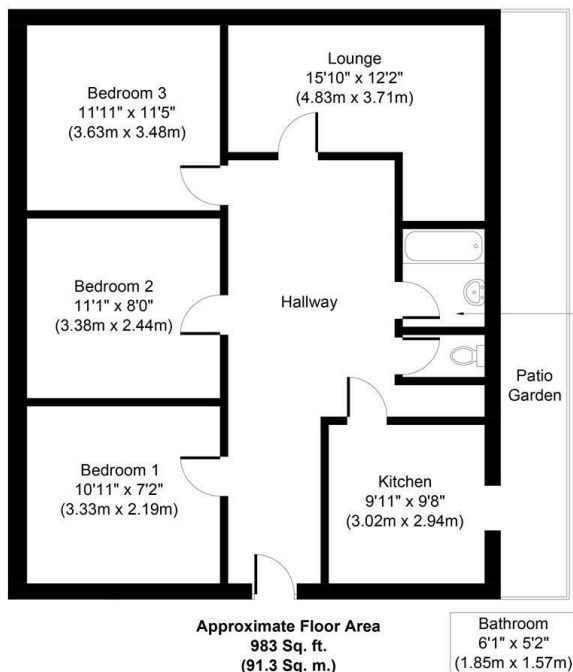

Whilst every attempt has been made to ensure the accuracy of the floor plan contained here, measurements of doors, windows, rooms and any other items are approximate and no responsibility is taken for any error, omission, or mis-statement. This plan is for illustrative purposes only and should be used as such by any prospective purchaser or tenant. The services, systems and appliances shown have not been tested and no guarantee as to their operability or efficiency can be given.
Copyright V360 Ltd 2021 | www.houseviz.com

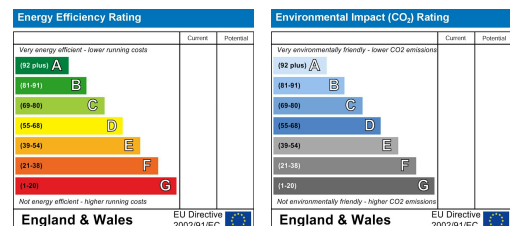

1 Turnpike Lane
London
N8 0EP

0208 342 5555
info@capitalhomesestates.co.uk
www.capitalhomesestates.co.uk

Agents Note: Whilst every care has been taken to prepare these particulars, they are for guidance purposes only. All measurements are approximate are for general guidance purposes only and whilst every care has been taken to ensure their accuracy, they should not be relied upon and potential buyers/tenants are advised to recheck the measurements