



18 Old Oak Common Lane
Acton
London
W3 7EL
T: 020 8749 9798
E: sales@churchillmathesons.com
www.churchillmathesons.com

Churchill & Mathesons

Coronation Road, London, NW10 7QP

Realistic Offers Considered £2,100,000 Freehold



KEY FEATURES:

- Excellent Location
- Excellent Transport Links
- 3-Phase Power
- Loading Bay
- CCTV
- On-Site Parking

Churchill & Mathesons want to present this industrial unit to let. Located at the heart of Park Royal, this freehold industrial unit is comprised of two floors, measuring 3,845sqft each.

The property comprises an industrial / warehouse unit of steel portal frame construction with blockwork walls and profile metal cladding. The full height of the unit is 5.65m to the eaves, whilst the height to the underside of the first-floor mezzanine is 2.293m. Access to the property is via a manual full height up and over shutter door (height 4.8m and width 4.3m) or separate staff entrance. The ground floor space benefits from W.C. facilities, strip lighting, 3 phase power and CCTV.

The unit benefits from being closely situated to Park Royal and North Acton Underground stations.

For more information please enquire within.

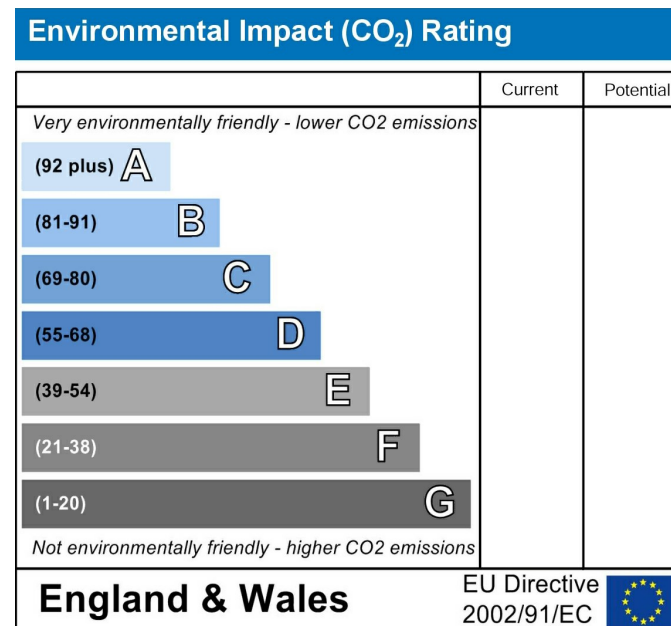
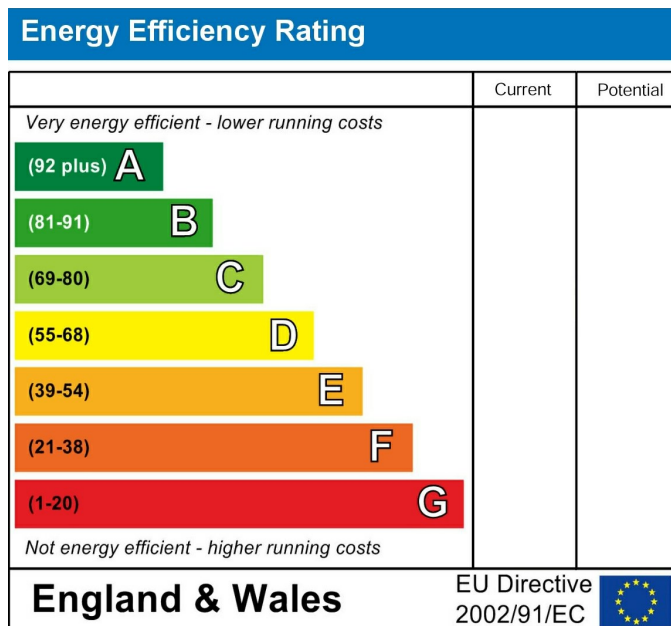
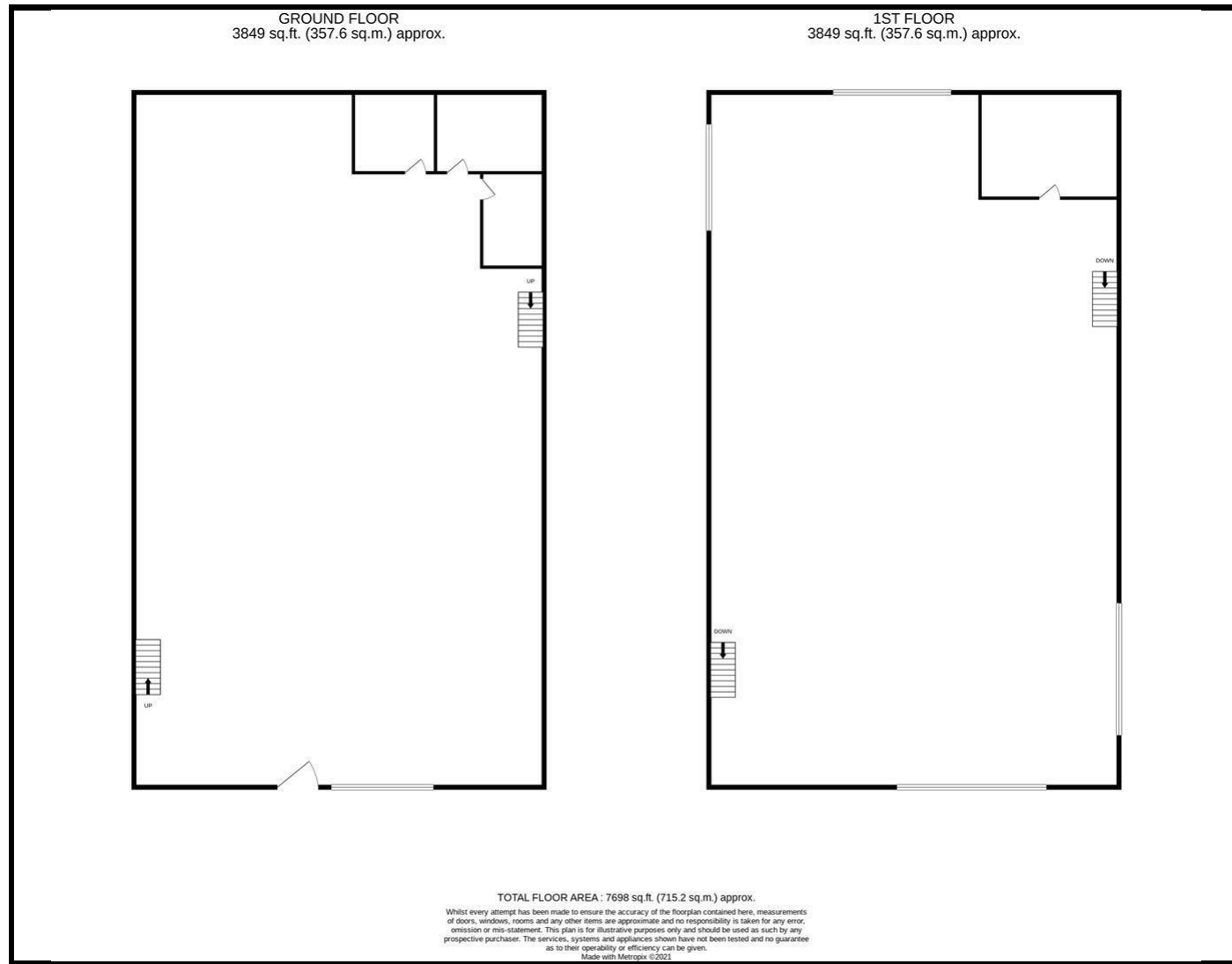

Whilst every effort is made to give a fair description, the accuracy of these particulars is not guaranteed, neither do they constitute an offer or contract.

CHURCHILL ESTATE AGENTS have not tested any apparatus, equipment, fitting or services and so cannot verify that they are in working order. The buyer is advised to obtain verification from their solicitor or surveyor. Measurements are correct to within +/- 6 A sonic tape is used. None of the statements contained in these particulars or any of our properties are to be relied upon as a representation of fact.