



**Craven Park Road, Harlesden NW10**

**£799,950 Freehold**

# Craven Park Road, Harlesden NW10

£799,950 Freehold

Freehold Investment Opportunity | Ground Floor A1 Shop | Three Bedroom Flat | Good Decorative Order | Close To Amenities | Close To Transport

Empire Estates are proud to offer for sale this Freehold investment opportunity comprising of a spacious Ground Floor Shop (currently with an A1 usage), parking to rear with a residential upper, comprising of a 3 bed flat with own entrance to the front. The property is situated in a busy Craven Park Road Harlesden and within walking distance to Harlesden Station along with a plethora of shops, fast food and restaurants. An ideal opportunity for someone looking for investment or established use. For viewing and further details Contact Agent Empire Estates.

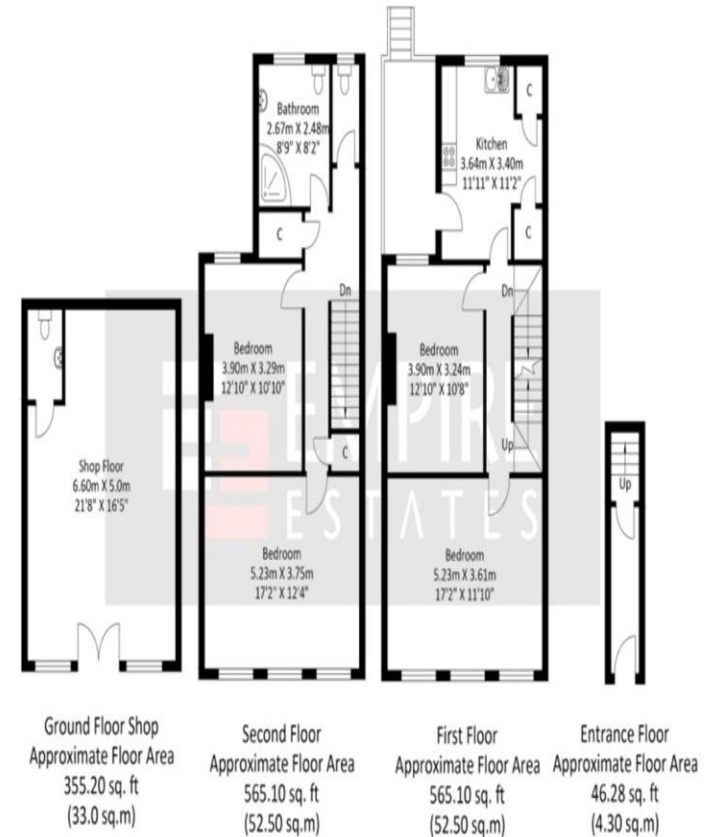

Approximate Gross Internal Area = 142.30 sq m / 1531.70 sq ft  
Illustration for identification purposes only, measurements are approximate, not to scale.



12-14 High Road | Willesden | NW 10 2QG

Sales | 020 8459 7777 Lettings | 020 8459 2600

sales@empire-estates.com lettings@empire-estates.com

[www.empire-estates.com](http://www.empire-estates.com)