



Jodane Street, Deptford

Asking Price £285,000 Leasehold





Jodane Street, Deptford

Moments from the river's edge in a rapidly appreciating corner of Deptford, this spacious apartment enjoys a peaceful position in a secure development with entry-phone system. Dating from the 1990s the property has been well cared for by the current owners and enjoys double glazing throughout, gas central heating and sleek modern interiors. The lease has been extended and has approximately 162 years unexpired. Ideally located to benefit from the Thames Clipper service to Canary Wharf and beyond, the property is likely to appeal to commuting first time buyers looking for a peaceful retreat.

- Modern One Bedroom Apartment
- Peaceful Residential Location
- Modern Interiors
- Double Glazing & Gas Central Heating
- Extended Lease
- 7 min Walk to Greenland Pier

South East London
020 7231 5050

Email southeast@o-j.co.uk

229-231 Lower Road, London, SE16 2LW

web www.o-j.co.uk

Every care has been taken with the preparation of this brochure but it is for general guidance only and complete accuracy cannot be guaranteed. If there is any point, which is of importance professional verification should be sought. This brochure does not constitute a contract or part of a contract. We are not qualified to verify tenure of property. Prospective purchasers should seek clarification from their solicitor or verify the tenure of this property for themselves by visiting www.landregisteronline.gov.uk. The mention of any appliances, fixtures or fittings does not imply they are in full working order. Photographs are reproduced for general information and it cannot be inferred that any item shown is included in the sale. All dimensions are approximate. Walking times are taken from Google Maps and measured from the centre of the postcode, which may differ slightly from the individual property.

James House, Jodane Street, London, SE8

APPROX. GROSS INTERNAL FLOOR AREA 462 SQ FT 42.9 SQ METRES

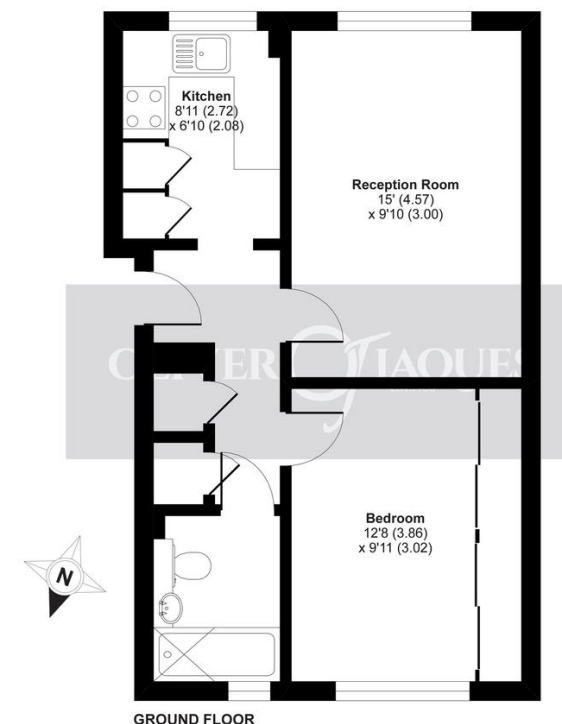

Whilst every attempt has been made to ensure the accuracy of the floor plan contained here, measurements of doors, windows and rooms are approximate and no responsibility is taken for any error, omission or misstatement. These plans are for representation purposes only as defined by RICS Code of Measuring Practice and should be used as such by any prospective purchaser. Specifically no guarantee is given on the total square footage of the property if quoted on this plan. Any figure given is for initial guidance only and should not be relied on as a basis of valuation.

Copyright nichecom.co.uk 2019 Produced for Oliver Jaques REF : 442485

