

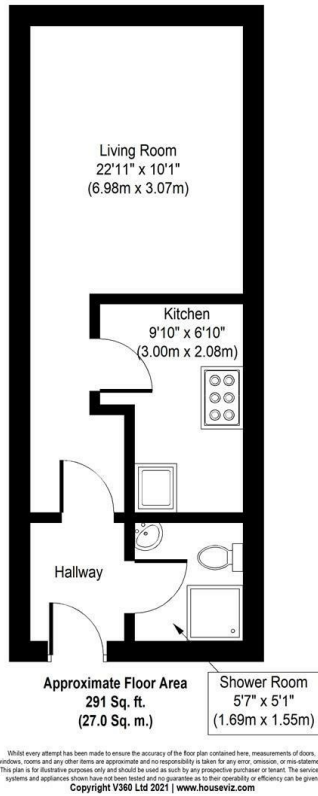



Estate Agents & Valuers

Turnpike Lane, London N8 0EP
Asking Price £234,995





Capital Homes are pleased to offer for sale this well-proportioned, top floor, studio flat, situated above a commercial building. This ideal investment/first time purchase contains a fully fitted kitchen within dining space, separate fully equipped bathroom, large living area, laminate floors, sufficient storage space and laminate floors.

The property is located conveniently near to an array of desired amenities including excellent transportation links into the City and West End via Turnpike Lane station (Piccadilly Line) and Hornsey British Rail (links to Moorgate) and extensive shopping facilities within walking distance.

To arrange your viewing, please contact Capital Homes, early viewings highly recommended in order to avoid disappointment!

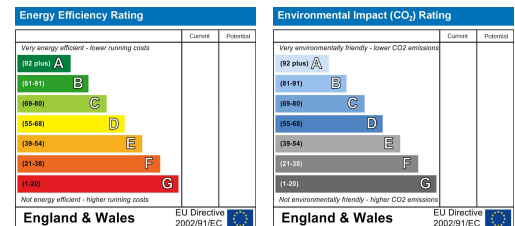

1 Turnpike Lane
London
N8 0EP

0208 342 5555
info@capitalhomesestates.co.uk
www.capitalhomesestates.co.uk

Agents Note: Whilst every care has been taken to prepare these particulars, they are for guidance purposes only. All measurements are approximate and for general guidance purposes only and whilst every care has been taken to ensure their accuracy, they should not be relied upon and potential buyers/tenants are advised to recheck the measurements