



Linhope Street, Marylebone, London NW1

Subject To Contract £750,000 | Leasehold

Contact us about this property

337 West End Lane, West Hampstead, London, NW6 1RS

E: nw6@alexanders-uk.com

T: 0207 431 0666

www.alexanders-uk.com

Alexanders

Property Consultants



About This Property

A chance to purchase a very spacious two bedroom ground and lower ground floor maisonette, situated in this quiet street on the imposing and popular Dorset Square Conservation Area.





Regent's Park and Baker Street are within easy access, this property offers excellent accommodation of 865 Sq feet, two double bedrooms, 20' reception room, kitchen, small patio , allocated parking. long leasehold .

Location is second to none and is well priced to sell in today's very competitive market place.



Alexanders

Property Consultants

 2 Bedroom |  1 Reception |  1 Bathroom |  63 D

Property Features

- TWO DOUBLE BEDROOMS
- 20' RECEPTION ROOM
- KITCHEN
- 157 Year Lease
- 865 SQ.FEET
- BATHROOM
- ALLOCATED PARKING
- PRIME LOCATION

Property Size

sq ft

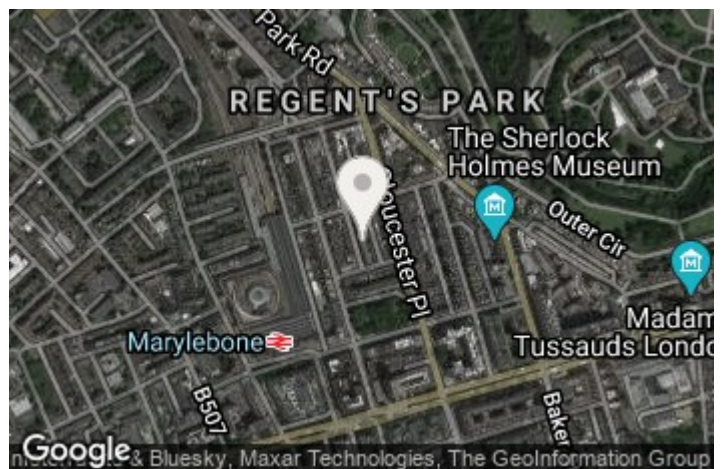
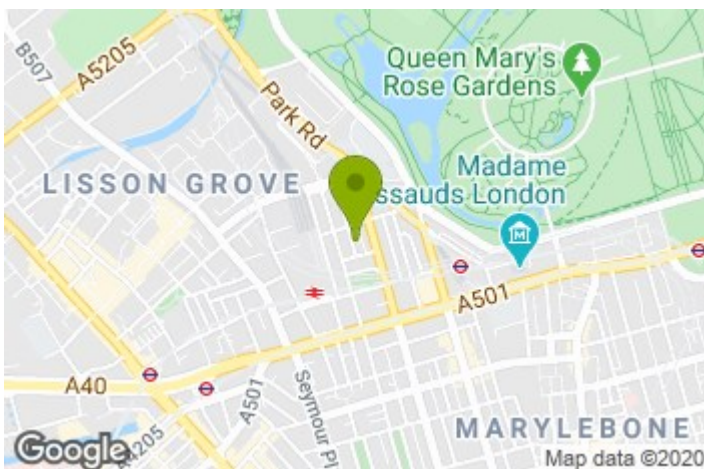

Nearest Transport Links

Alexanders

Property Consultants

Linhope Street, NW1

Approximate Gross Internal Floor Area : 865 sq ft / 80.4 sq m

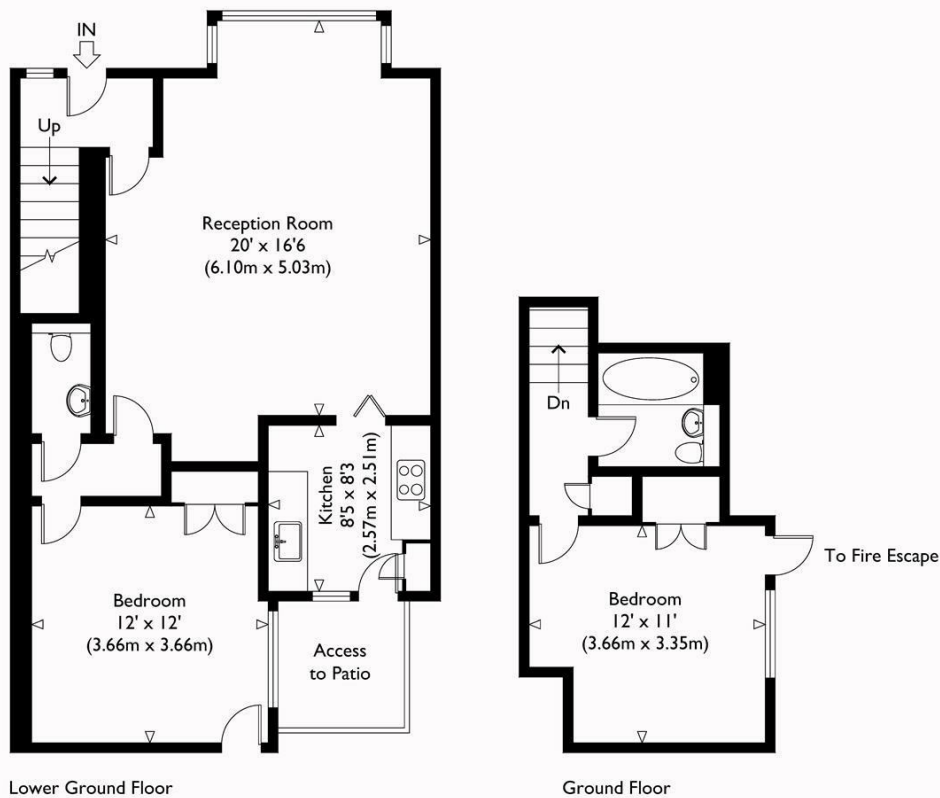

Illustration for identification purposes only, measurements are approximate, not to scale.

Contact us about this property

337 West End Lane, West Hampstead, London, NW6 1RS

E: nw6@alexanders-uk.com

T: 0207 431 0666

www.alexanders-uk.com