

Stamford Court,  
Goldhawk Road, W6  
Approx. Gross Internal Area  
503 Sq Ft - 46.73 Sq M

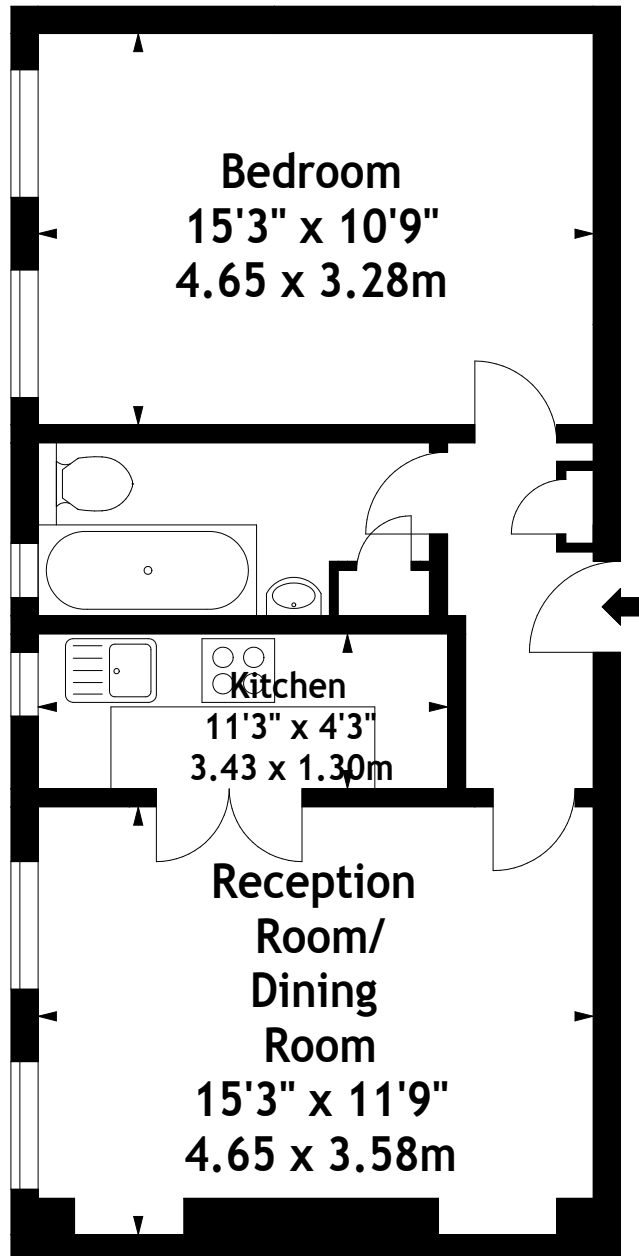

Fourth Floor



Measured in accordance with RICS guidelines. Every attempt is made to ensure accuracy, however all measurements are approximate.

This floor plan is for illustrative purposes only and is not to scale.

© Datagraphy Ltd 2017

Photographs \* Floorplans \* Virtual Tours  
Tel: 0845 643 4401 [www.datagraphy.com](http://www.datagraphy.com)