



Jamaica Road, Bermondsey

Asking Price £350,000, Leasehold

OLIVER *OJ* JAQUES
EST. 1986



Jamaica Road, Bermondsey

A literal 53 metres door-to-door from Bermondsey's Jubilee Line station, this two bedroom property in Spenlow House could hardly be more conveniently located. The property provides a blank canvas and the opportunity for a homeowner to make it their own without having to pay for someone else's décor on the way in. Two double bedrooms are complemented by a naturally bright south facing reception room, a separate kitchen and a sunny balcony. Spenlow House is a six storey building of standard brick construction, secure entry-com system and serviced lifts. A programme of works was carried out recently providing a cavity wall 'skin' for insulation and double glazing, making this property energy efficient and hassle free for years to come.

- Two Double Bedrooms
- Sunny Balcony
- Opposite Bermondsey Station
- Secure Entry Phone System
- South facing Reception Room
- Residents' Parking Available

South East London
020 7231 5050

Email southeast@o-j.co.uk

229-231 Lower Road, London, SE16 2LW

web www.o-j.co.uk

Every care has been taken with the preparation of this brochure but it is for general guidance only and complete accuracy cannot be guaranteed. If there is any point, which is of importance professional verification should be sought. This brochure does not constitute a contract or part of a contract. We are not qualified to verify tenure of property. Prospective purchasers should seek clarification from their solicitor or verify the tenure of this property for themselves by visiting www.gov.uk/government/organisations/land-registry. The mention of any appliances, fixtures or fittings does not imply they are in full working order. Photographs are reproduced for general information and it cannot be inferred that any item shown is included in the sale. All dimensions are approximate. Walking times are taken from Google Maps and measured from the centre of the postcode, which may differ from the individual property. We always refer prospective buyers to our panelled conveyancers and Chancery Mortgage Services Ltd. It is your decision whether to use them. Should you decide to do so you should know that we could receive a referral fee from them for recommending them to you.

Jamaica Road, London, SE16

Approximate Area = 655 sq ft / 60.8 sq m

For identification only - Not to scale

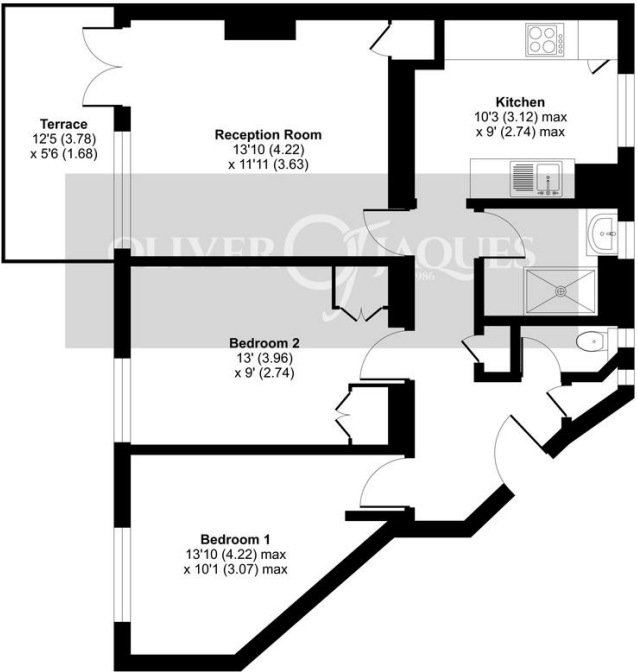

GROUND FLOOR

RICS Certified Property Measurer
Floor plan produced in accordance with RICS Property Measurement Standards incorporating International Property Measurement Standards (IPMS2 Residential). © richcom 2021. Produced for Oliver Jacques - REF: 707009

