

# Davidson



- Three bedroom mansion apartment
- 1st Floor with lift access
- Residents Car Park
- No chain

Calthorpe Road, Edgbaston, Birmingham, B15 1QS

Offers In Region Of £250,000

| CALTHORPE MANSIONS | Three bedrooms | Refurbished throughout | 1st Floor | No chain | Residents parking



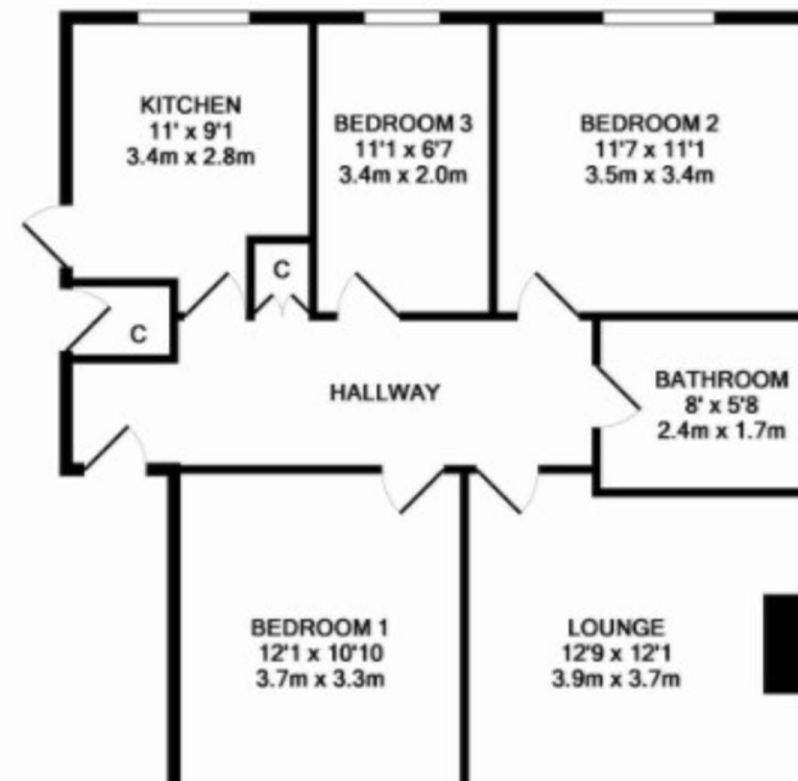

Energy Efficiency Rating		
	Current	Potential
Very energy efficient - lower running costs		
(92-100) <b>A</b>		
(81-91) <b>B</b>		
(69-80) <b>C</b>		
(55-68) <b>D</b>		
(39-54) <b>E</b>		
(21-38) <b>F</b>		
(1-20) <b>G</b>		
Not energy efficient - higher running costs		
England, Scotland & Wales	61	71
EU Directive 2002/91/EC		

Environmental Impact (CO <sub>2</sub> ) Rating		
	Current	Potential
Very environmentally friendly - lower CO <sub>2</sub> emissions		
(92-100) <b>A</b>		
(81-91) <b>B</b>		
(69-80) <b>C</b>		
(55-68) <b>D</b>		
(39-54) <b>E</b>		
(21-38) <b>F</b>		
(1-20) <b>G</b>		
Not environmentally friendly - higher CO <sub>2</sub> emissions		
England, Scotland & Wales	53	67
EU Directive 2002/91/EC		

Unit 2 Liberty Place, 26-38  
Sheepcote Street, Birmingham,  
West Midlands, B16 8AE

[www.davidsonstates.co.uk](http://www.davidsonstates.co.uk)  
0121 455 7727  
[info@davidsonstates.co.uk](mailto:info@davidsonstates.co.uk)

Agents Note: Whilst every care has been taken to prepare these particulars, they are for guidance purposes only. All measurements are approximate and for general guidance purposes only and whilst every care has been taken to ensure their accuracy, they should not be relied upon and potential buyers/tenants are advised to recheck the measurements.