



Harefield Mews SE4  
£1,400 PCM

0207 781 9888  
[pedderproperty.com](https://pedderproperty.com)

**pedder**





# In general

- Spacious kitchen/reception room
- Modern bathroom suite
- One double bedroom
- Fitted wardrobes
- Double glazing
- Wooden flooring
- Close to excellent transport links

# In detail

A very well presented one double bedroom apartment to let in Harefield Mews.

This property comprises a spacious kitchen/reception room, modern bathroom suite and one double bedroom. Further benefits include fitted wardrobes, double glazing, gas central heating, wooden flooring and a modern finish throughout.

This property is situated approximately just 0.1 miles to Brockley station offering excellent transport links into London Bridge, Highbury & Islington and many other locations. It is also just a short walk to various local amenities including a variety of restaurants, coffee shops, cafes and gastro pubs. EPC C.

Viewings are highly recommended, call the Pedder Brockley lettings team to arrange a viewing today.

Available end of May.



# Floorplan

Harefield Mews, SE4

Approximate Gross Internal Area = 42.6 sq m / 458 sq ft

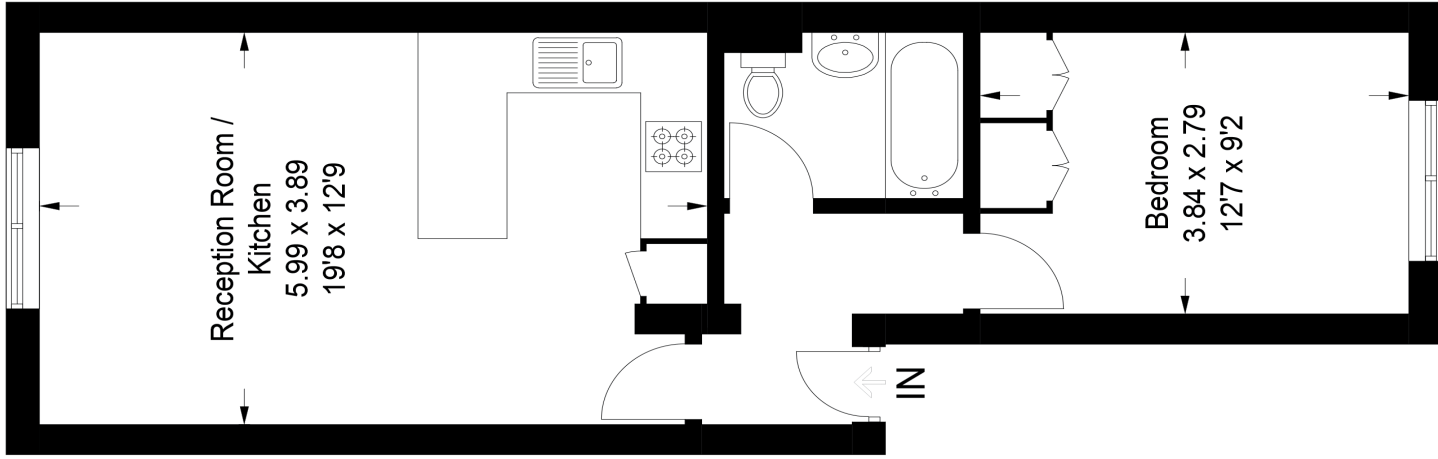

First Floor

Copyright www.pedderproperty.com © 2021  
These plans are for representation purposes only as defined by RICS - Code of Measuring Practice.  
Not drawn to Scale. Windows and door openings are approximate. Please check all dimensions,  
shapes and compass bearings before making any decisions reliant upon them.

Score	Energy rating	Current	Potential
92+	A		
81-91	B		
69-80	C	78   C	78   C
55-68	D		
39-54	E		
21-38	F		
1-20	G		

Pedder Property Ltd trading as Pedder for themselves and for the vendor/landlord of this property whose agents they are, give notice that (1) these particulars do not constitute any part of an offer or contract, (2) all statements contained within these particulars are made without responsibility on the part of Pedder or the vendor/landlord, (3) whilst made in good faith, none of the statements contained within these particulars are to be relied upon as a statement of representation or fact, (4) any intending purchaser/tenant must satisfy him/herself by inspection or otherwise as to the correctness of each of the statements contained within these particulars, (5) the vendor/landlord does not make or give either Pedder or any person in their employment any authority to make or give representation or warranty whatsoever in relation to this property.