



Homecross House, London, W4 1YB

Asking Price £430,000

WHITMAN & CO.

SALES · LETTINGS · COMMERCIAL

- Retirement flat
- Two double bedrooms
- Residents living room and gardens
- Top floor with lift access
- Off-street parking
- No chain

Tenure - Leasehold
 Lease Length - 122 years remaining
 Ground rent - £600
 Service Charge - £3500pa
 Local Authority - Hounslow
 Council Tax - Band D

Homecross House, W4

Approximate gross internal area

55.93 sq m / 602 sq ft

Key :
 CH - Ceiling Height

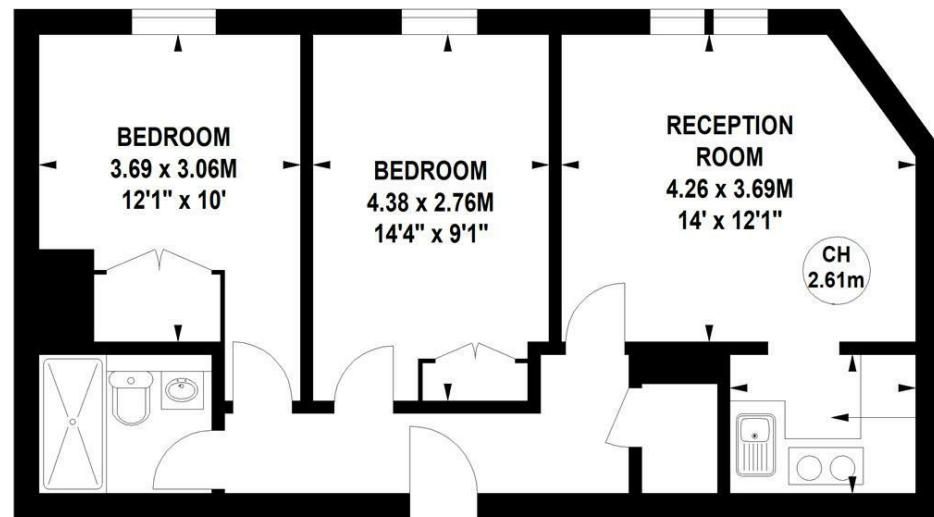

Third Floor

Not to scale, for guidance only and must not be relied upon as a statement of fact.
 All measurements and areas are approximate only

THE PROPERTY

RETIREMENT FLAT - An immaculately presented top floor (with lift) two-bedroom apartment set within this sought after development in the centre of Chiswick offering close proximity to all amenities. This superb flat refurbished to a very high standard, comprises two double bedrooms, 14' reception room, fully fitted kitchen, luxury shower room, residents living room and gardens, house manager, laundry room, residents parking, long lease of 122 years and ideally located with only one neighbour. Fantastically located near Chiswick High Road, close to numerous transport facilities and an extensive range of shops, bars, and restaurants. No Chain.

SITUATION



5-7 Turnham Green Terrace, Chiswick, London, W4 1RG

Tel 020 8747 8800

E-mail sales@whitmanandco.com

Website www.whitmanandco.com