



149 Upper Richmond Road, Putney, London, SW15 2TX

t: 0208 788 8822

e: putney@allanfuller.co.uk

www.allanfuller.co.uk

Evenwood Close London, SW15

Great value is offered in this ground floor double bedroom purpose built flat, the interior offers lovely bright living space with a good size kitchen This is a real opportunity as first-time purchase or investment for renting out.

Copse Close is conveniently positioned just off Carlton Drive which allows easy access to most if not all of Putney's fantastic amenities including an array of shops, bars and restaurants not forgetting excellent transport links in and out of London.

Besides the fantastic transport on offer, Putney has a vibrant and buzzing lifestyle with the Thames on your doorstep and some of the most popular bars and restaurants in South West London. not to mention the green open spaces of Putney and Wimbledon Commons. The local area is renowned for its easy transport links to and from the city and West End. EPC- C Council Tax: Band C



Asking Price £350,000
Leasehold





Copse Court, SW15



Approx. Gross Internal Area 483 Sq Ft - 44.87 Sq M

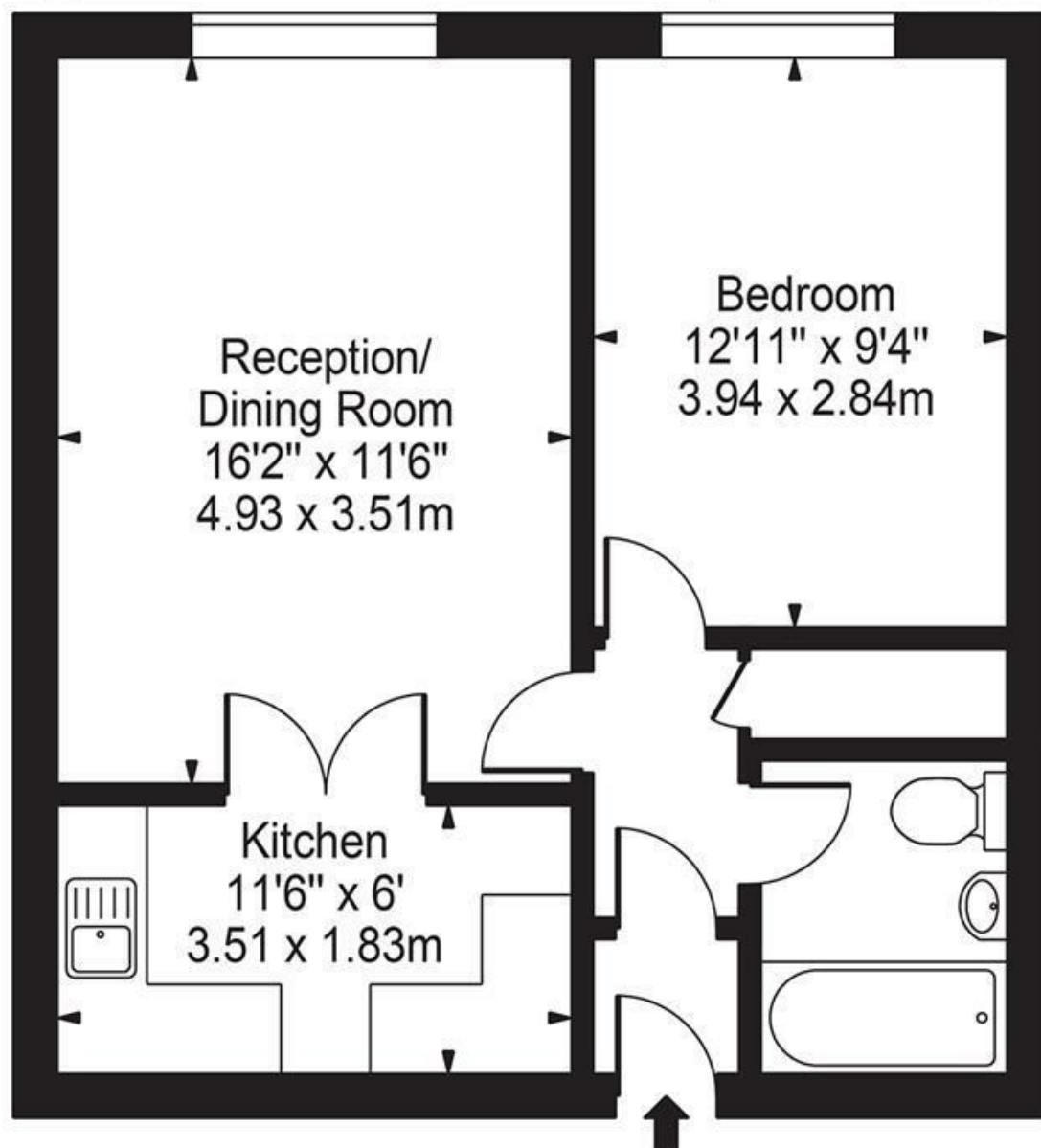

Ground Floor



For Illustration Purposes Only - Not To Scale Floor Plan by Mira Nikolova Photography

This floor plan should be used as a general outline for guidance only and does not constitute in whole or in part an offer or contract. Any intending purchaser or lessee should satisfy themselves by inspection, searches, enquiries and full survey as to the correctness of each statement. Any areas, measurements or distances quoted are approximate and should not be used to value a property or be the basis of any sale or let.

With regards to any information supplied by us in relation to lease, ground rent and service charge it is essential that you have this information checked by your solicitor. We have transmitted information supplied to us by the vendor of the property but we have not been able to inspect the lease to check its accuracy. Please note that we have not tested any of the equipment or utilities at this property, nothing in these particulars shall be deemed a statement that the property is in good condition or otherwise nor that any of the services or facilities are in good working order. Measurements are approximate they were taken with a sonic tape, are as accurate as possible and usually measured from the widest point of any room. Description provided herein represents the opinion of the author, is given in good faith but should not be constructed as statements of fact. The particulars and photograph are for guidance only.