

NOAHS



Garden House, 86-92 Kensington Gardens Square, London

£2,773 Per month

- 1 bedroom
- 1 bathroom
- Crestron home automation system
- Communal gardens
- Part furnished

THE PROPERTY

A superbly refurbished one bedroom one-bathroom apartment 477sqft located on the lower ground floor within a stunning Grade II listed building with access to beautiful communal gardens.

The apartment has been interior designed and finished to the highest of standards whilst retaining its original Grade II listed features from the original building. The apartment comprises a splendid bedroom with built in custom wardrobes, an exquisite polished marble bathroom, a luxurious reception room with bespoke furniture and a fully fitted bespoke Miele kitchen. The apartment has access to the stunning communal gardens which is one of London's few remaining traditional Garden squares.

The building hosts 24-hour security, lift service, unique private access to Kensington Garden Square gardens and an emergency out of hour's maintenance service.

Garden House is located in a quiet residential part of W2 and close to the amenities of Westbourne Grove, Notting Hill and the beautiful Hyde Park including Whitley shopping mall. It is also perfectly located for easy access to transport links with Bayswater and Queensway tube station just 5 minutes walk away.

Quality and comfort are the hallmarks of these prestigious apartments. The living space features beautiful traditional architraves and fittings blending seamlessly with modern comforts such as American walnut timber flooring, remotely operated handmade roller blinds, a 47" smart TV, integrated speakers and controlled mood lighting throughout.

Garden House is located in a quiet residential part of W2 and close to the amenities of Westbourne Grove, Notting Hill and the beautiful Hyde Park. It is also perfectly located for easy access to transport links with Bayswater and

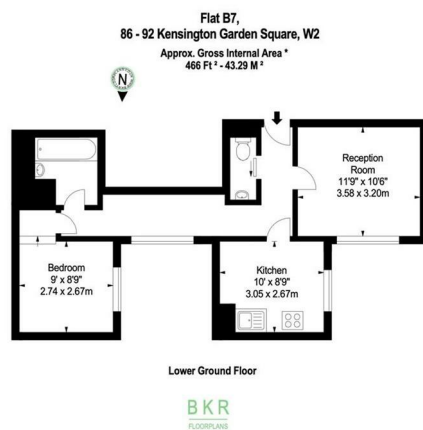

SITUATION

Directions