



## Flat 1, 12 Elgin Avenue

, London, W9 3QP

£1,025,000

This bright and spacious duplex apartment benefits from floor to ceiling windows and modern specifications throughout.

The flat comprises of a good sized open plan reception room with fully fitted white gloss kitchen, engineered oak flooring, three large double bedrooms (two with en-suite bathrooms), a private garden and stylish modern bathroom suite in the well apportioned family bathroom.

The property further benefits from video entry phone, communal satellite TV access and bike storage.

The development is designed to meet the highest standards of contemporary styling and taste. Located close to transport connections, within walking distance to Maida Vale Underground station linking it to Paddington, the West End, shops, restaurants and parks.

- Private Garden
- Wood Flooring
- Fully Integrated Kitchen
- Double Glazing

### Viewing

Please contact our Hampstead Sales Office on 020 7431 4488 if you wish to arrange a viewing appointment for this property or require further information.



3



3



1



B

Floor Plan

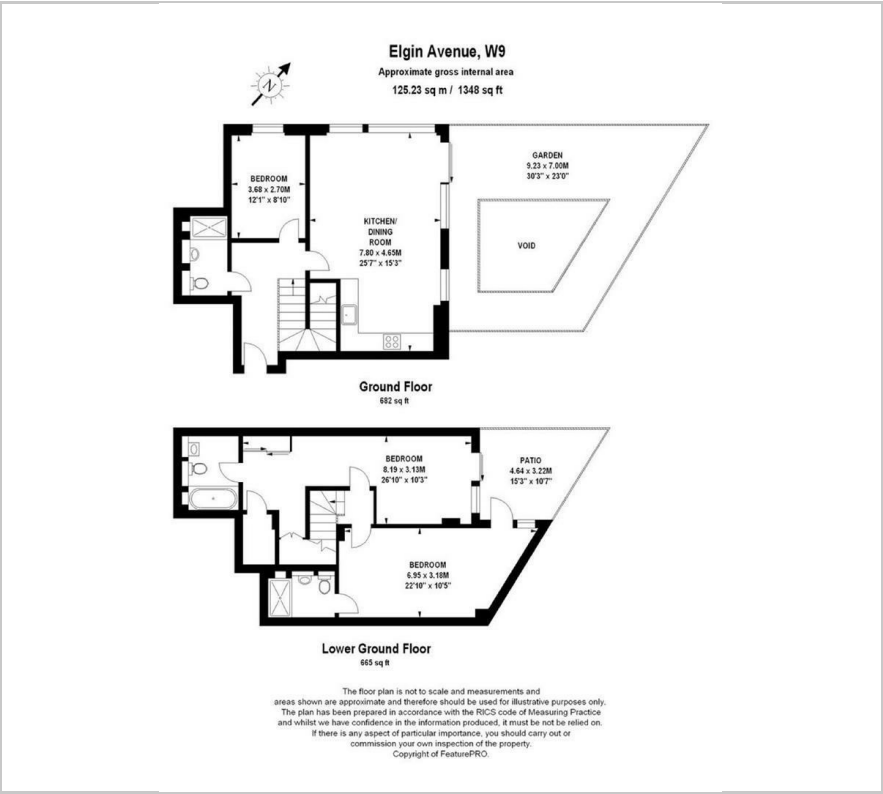

Area Map

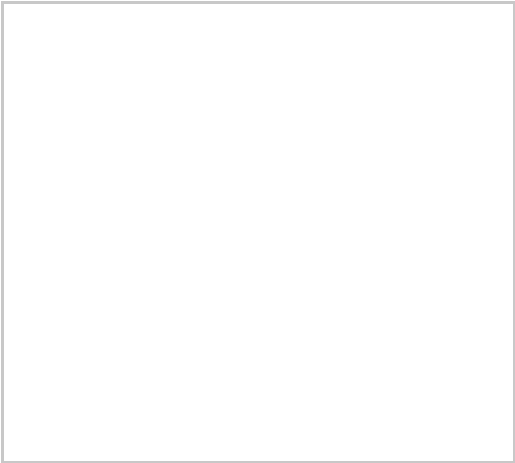

Energy Efficiency Graph

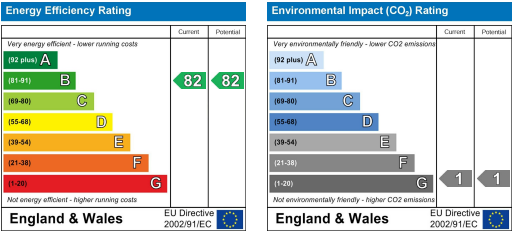

These particulars, whilst believed to be accurate are set out as a general outline only for guidance and do not constitute any part of an offer or contract. Intending purchasers should not rely on them as statements of representation of fact, but must satisfy themselves by inspection or otherwise as to their accuracy. No person in this firms employment has the authority to make or give any representation or warranty in respect of the property.