

High Street, Leiston, Suffolk, IP16 4EJ

Asking Price: £495,000



- New build / Conversion
- No Onward Chain
- High Street Location
- Spacious Semi-Detached House
- Three Good Size Double Bedrooms
- Family Bathroom & Two En-Suites
- Open Plan Kitchen/Dining/Living Room
- Two Parking Spaces
- Low-Maintenance Garden
- 10 Year Structural Warranty

*** Show Home has now been released ***

1 High Street is an exceptionally spacious three bedroom, three bathroom semi-detached property situated within this exclusive High Street development. The project is being carried out by the award winning Western Homes Developments, a highly experienced property and development company; for further details please call Lucy or Jan.

The original part of the building is Georgian and the developers have divided and extended it to create a pair of substantial semi-detached houses which provide a contemporary feel whilst retaining many character features including some original windows and lovely high ceilings. The accommodation is incredibly spacious and well-proportioned with the entrance door opening into a magnificent 26ft open plan kitchen / living/ dining room with integrated appliances and centre island in the kitchen area; also on the ground floor is a pantry, inner lobby with utility cupboard, cloakroom, and second reception room; whilst on the first floor there is a family shower room and three good size double bedrooms, two of which have en-suite shower rooms; also with this particular property is a good size cellar which has its own independent access to the garden.

This property comes with a 10 year structural warranty, fully enclosed rear garden and two parking spaces, and purchasers will have some choice over the internal fixtures and fittings including kitchen and bathrooms, flooring, etc.

AGENTS NOTE:

Any interested parties will be required to secure their plot with a £3,000 non-refundable deposit.

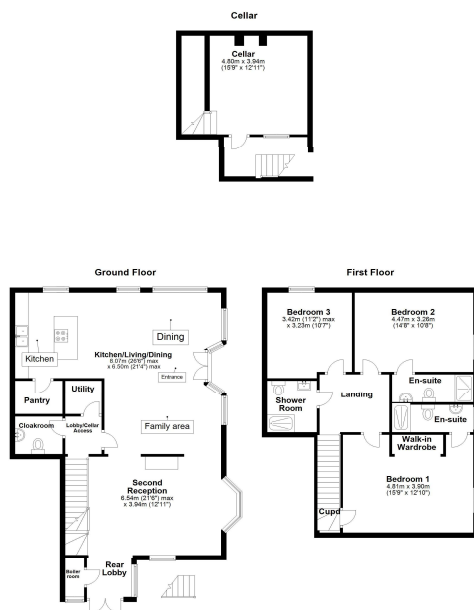

FLOORPLAN:

The floorplan is for guidance purposes only and may be subject to change.

Disclaimer

Every attempt has been made to ensure accuracy, however these property particulars are approximate and for illustrative purposes only. They have been prepared in good faith and they are not intended to constitute part of an offer of contract. We have not carried out a structural survey and the services, appliances and specific fittings have not been tested. All photographs, measurements, floor plans and distances referred to are given as a guide only and should not be relied upon for the purchase of any fixture or fittings. Lease details, service charges and ground rent (where applicable) are given as a guide only and should be checked prior to agreeing a sale.