

NOAHS



Dorchester House, 288 Great Western Road, London

£350,000

- One Bedroom | One Bathroom
- Ground Floor Flat | Communal Garden
- A Great Investment Opportunity | Perfect for First Time Buyers
- Walking Distance to Westbourne Park Tube Station
- Open Plan Reception Room | Well Presented

THE PROPERTY

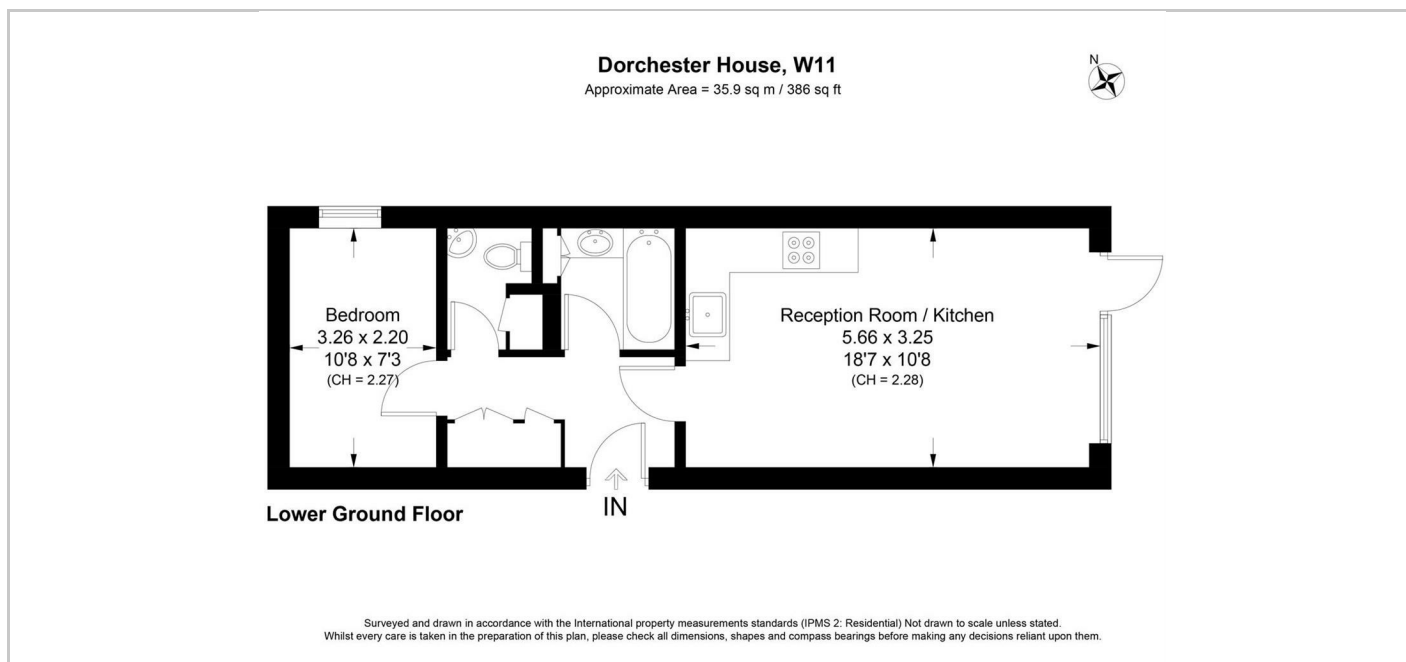

SITUATION

Directions