



Manhattan Building, Fairfield Road
Offers in Excess Of £340,000 Leasehold

OLIVER & JACQUES
ESTD 1986



Manhattan Building, Fairfield Road

An eloquent one bedroom mezzanine apartment, located within the sought-after gated Bow Quarter development. The property boasts an open-plan reception, a modern kitchen with a breakfast bar and bathroom. The mezzanine bedroom is complimented by a walk-in wardrobe and the reception is greeted with an abundance of natural light. The development offers modern urban living within an historic setting. Onsite benefits include a leisure centre with swimming pool and gymnasium, a 24 hour concierge, as well as a convenience store. The complex is conveniently located a short walk from Bow Church DLR and Bow Road underground stations, as well as Victoria Park and the Queen Elizabeth Olympic Park

- Modern Bathroom/ Kitchen
- High Ceilings
- Mezzanine Bedroom
- Ample Storage Space
- 24 Hour Concierge & Leisure Centre
- Close To Bow Road/ Bow Church Stations

East London
020 8980 0999

Email east@o-j.co.uk

229-231 Lower Road, London, SE16 2LW

web www.o-j.co.uk

Every care has been taken with the preparation of this brochure but it is for general guidance only and complete accuracy cannot be guaranteed. If there is any point, which is of importance professional verification should be sought. This brochure does not constitute a contract or part of a contract. We are not qualified to verify tenure of property. Prospective purchasers should seek clarification from their solicitor or verify the tenure of this property for themselves by visiting www.gov.uk/government/organisations/land-registry. The mention of any appliances, fixtures or fittings does not imply they are in full working order. Photographs are reproduced for general information and it cannot be inferred that any item shown is included in the sale. All dimensions are approximate. Walking times are taken from Google Maps and measured from the centre of the postcode, which may differ from the individual property. We always refer prospective buyers to our panelled conveyancers and Chancery Mortgage Services Ltd. It is your decision whether to use them. Should you decide to do so you should know that we could receive a referral fee from them for recommending them to you.

Bow Quarter, Fairfield Road, London, E3

APPROX. GROSS INTERNAL FLOOR AREA 485 SQ FT 45 SQ METRES (EXCLUDES VOID)

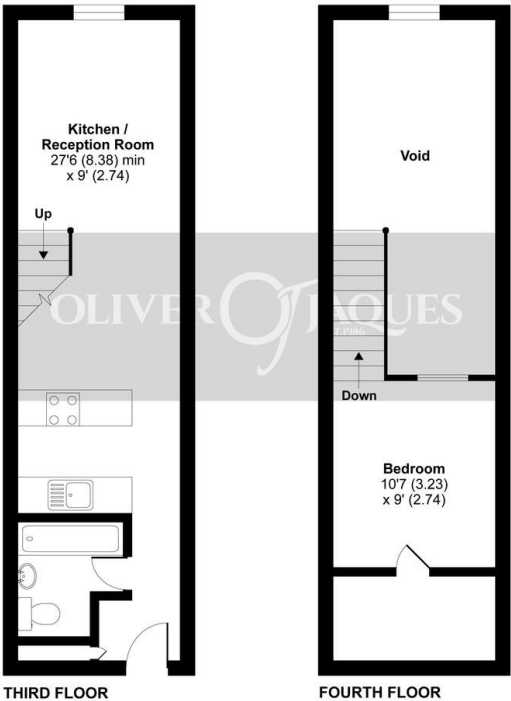

Whilst every attempt has been made to ensure the accuracy of the floor plan contained here, measurements of doors, windows and rooms are approximate and no responsibility is taken for any error, omission or misstatement. These plans are for representation purposes only as defined by RICS Code of Measuring Practice and should be used as such by any prospective purchaser. Specifically no guarantee is given on the total square footage of the property if quoted on this plan. Any figure given is for initial guidance only and should not be relied on as a basis of valuation.
Copyright nichecom.co.uk 2018 Produced for Oliver Jaques REF : 250679

