



Regents Park Road, London NW1 7SX

WAYNE
& SILVER

Regents Park Road, London NW1 7SX

An immaculately presented two bedroom apartment situated on the raised ground floor of this handsome Victorian Conversion in the heart of Primrose Hill. This two bedroom property has a sumptuous principal bedroom with en suite bathroom and French doors leading to a balcony. There is a further double bedroom with generous storage and a second bathroom. The large living space has high ceilings, floor to ceiling windows with attractive bespoke shutters. The modern kitchen is well appointed and has its own door leading out to second balcony. The property benefits from a share of freehold and has low outgoings. The location is less than two hundred yards to Primrose Hill Park and close to all the local shops and amenities.

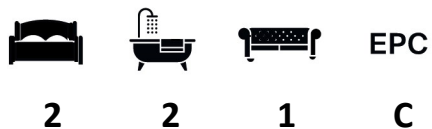

Guide price: £1,850,000

Tenure: Freehold

Service Charge: Add text here

Local Authority:

Council Tax Band:





Features include:

- Raised Ground Floor
- Floor to Ceiling Windows
- Share of Freehold
- Bespoke Shutters





Regent's Park Rd, London, NW1 7SX

Raised Ground Floor
GROSS INTERNAL FLOOR AREA
APPROX. 95.0 SQ M / 1023 SQ FT

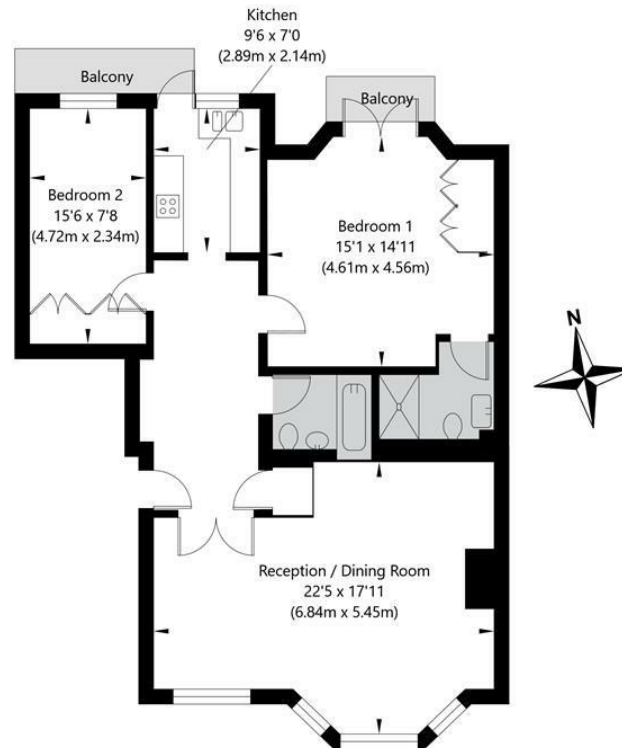

APPROXIMATE GROSS INTERNAL FLOOR AREA 95.0 SQ M / 1023 SQ FT
THIS FLOOR PLAN IS FOR ILLUSTRATIVE PURPOSES ONLY AND
SHOULD BE USED FOR THIS PURPOSE BY PROSPECTIVE APPLICANTS AS ITS NOT TO SCALE.

(c) AMBERSHORE PIX LIMITED / PHOTO - VIDEO - FLOOR PLANS / 0800 999 1577 / WWW.AMBERSHOREPIX.CO.UK

41 Heath Street
Hampstead
London
NW3 6UA

We would be delighted to tell you more
020 7431 4488
info@wayne-silver.com

wayne-silver.com