



Rotherhithe Street, Rotherhithe

Asking Price £650,000 Freehold

OLIVER  JACQUES
EST. 1986



Rotherhithe Street, Rotherhithe

Occupying a peaceful spot on the riverside Rotherhithe Street, this 1920s built end of terrace home offers a rare slice of period charm set against the backdrop of post-dock Rotherhithe. The property enjoys three double bedrooms upstairs, a contemporary, fully tiled bathroom, naturally bright kitchen/diner at the rear and a cosy front living room with chimney-breast, fireplace surround and fitted carpet. The conservatory offers additional space for a family sized dining table and the orientation floods the space with light all day. The garden to the rear is south facing and laid to flagstone and artificial grass giving all the enjoyment of the outside space without the maintenance worries.

- Three Double Bedrooms
- Fully Double Glazed
- Rear Conservatory
- South Facing Garden
- Period Style End of Terrace
- Loft Storage

South East London
020 7231 5050

Email southeast@o-j.co.uk

229-231 Lower Road, London, SE16 2LW

web www.o-j.co.uk

Every care has been taken with the preparation of this brochure but it is for general guidance only and complete accuracy cannot be guaranteed. If there is any point, which is of importance professional verification should be sought. This brochure does not constitute a contract or part of a contract. We are not qualified to verify tenure of property. Prospective purchasers should seek clarification from their solicitor or verify the tenure of this property for themselves by visiting www.gov.uk/government/organisations/land-registry. The mention of any appliances, fixtures or fittings does not imply they are in full working order. Photographs are reproduced for general information and it cannot be inferred that any item shown is included in the sale. All dimensions are approximate. Walking times are taken from Google Maps and measured from the centre of the postcode, which may differ from the individual property. We always refer prospective buyers to our panelled conveyancers and Chancery Mortgage Services Ltd. It is your decision whether to use them. Should you decide to do so you should know that we could receive a referral fee from them for recommending them to you.

Rotherhithe Street, London, SE16
Total = 870 sq ft / 80.82 sq m
For identification only - Not to scale

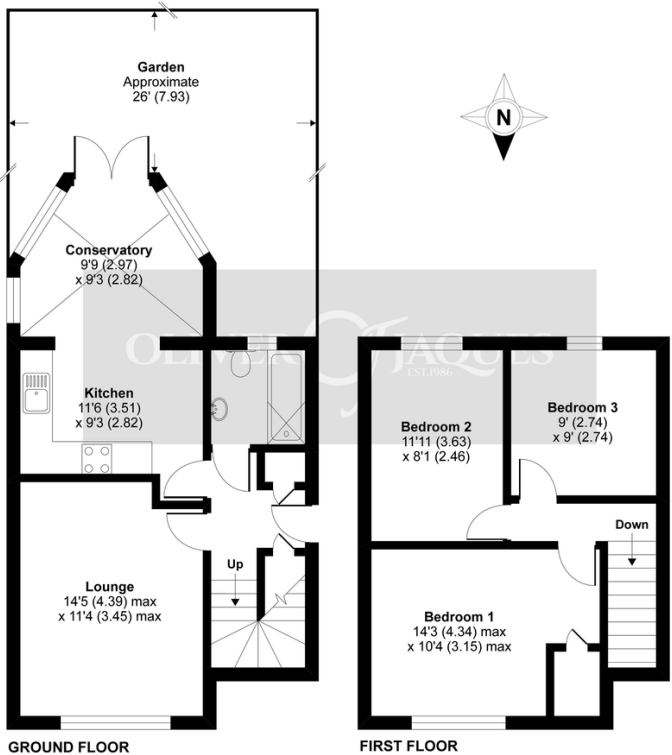

Certified Property Measurer Floor plan produced in accordance with RICS Property Measurement Standards incorporating International Property Measurement Standards (IPMS2 Residential). © richrecom 2021. Produced for Oliver Jacques - REF: 689625

