

NOAHS



Bowling Green Close, London

£2,800,000

- Five bedrooms | four bathrooms
- Two reception rooms
- Superb plot width
- Cul de sac
- Off street parking
- Potential to extend STP

THE PROPERTY

Coming to the market for the first time in almost 50 years, this 1930's traditional family house is arranged over two floors and retains a wealth of the original character and sits on quarter of an acre.

The ground floor retains a wealth of the original character and comprises a 21 foot formal reception room with windows to the front and French doors to rear, dining room and further study overlooking the garden and the kitchen which opens to the side of the house. There is currently a bedroom with en-suite shower room to the front, a further downstairs WC and an integrated garage opening to the front driveway.

The first floor comprises a principal suite including a large dressing room and en-suite bathroom. The second bedroom is also en-suite and a family bathroom serves the remaining two double bedrooms. Each additional bedroom has built-in wardrobe storage and from the hall is another small store room.

Offering approximately 60 feet of frontage and a carriage driveway, the front garden has mature trees and hedges. To the rear is a tree-lined, secluded garden which allows the house to sit in a plot of a quarter of an acre.

Refurbishment is required and the potential to extend, subject to the usual consents, is vast.

SITUATION

Pitt Cottage is situated at the end of a cul de sac nestled in Putney Heath. The renowned Telegraph Pub is within a short walk away, a little further still are the buses at the Green Man Putney terminus.

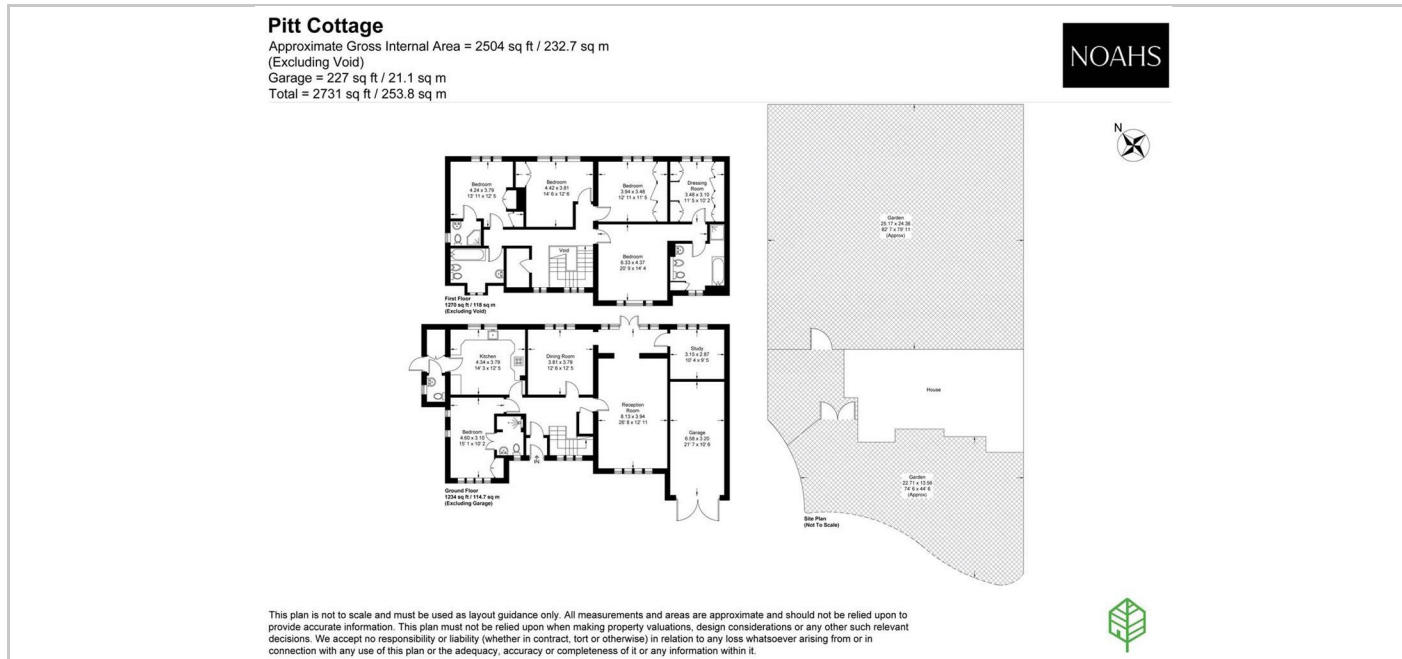

Directions

East Putney underground is 1.5 miles away and the A3 is easily accessed to the south for journeys into and out of London. An entrance to Putney Common is a little over 100 metres away and Wimbledon Common and Richmond Park are just beyond to the west and the south respectively.