

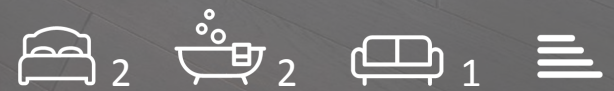

Flat 2109, 8 Casson Square, London, SE1 7GU

£1,300 Per Week





£1,300 Per Week

Flat 2109, 8 Casson Square

London, SE1 7GU

A brand new and luxurious 2 bedroom apartment offered to rent on the 21st floor in the beautifully designed Eight Casson Square development. The apartment features: 2 double bedrooms, 2 bathrooms, a bespoke open plan kitchen/reception room with amazing views overlooking The Shard.

Welcome to central riverside living in the city's most vibrant destination. Eight Casson Square is in the heart of the city, next door to Waterloo Station and adjacent to the London Eye & Jubilee Gardens. The building has 24-hour concierge, a fully equipped gym, Olympic sized swimming pool, sauna and treatment rooms available to the residence.

The location is ideal as it is close to all the attractions and amenities of Central London



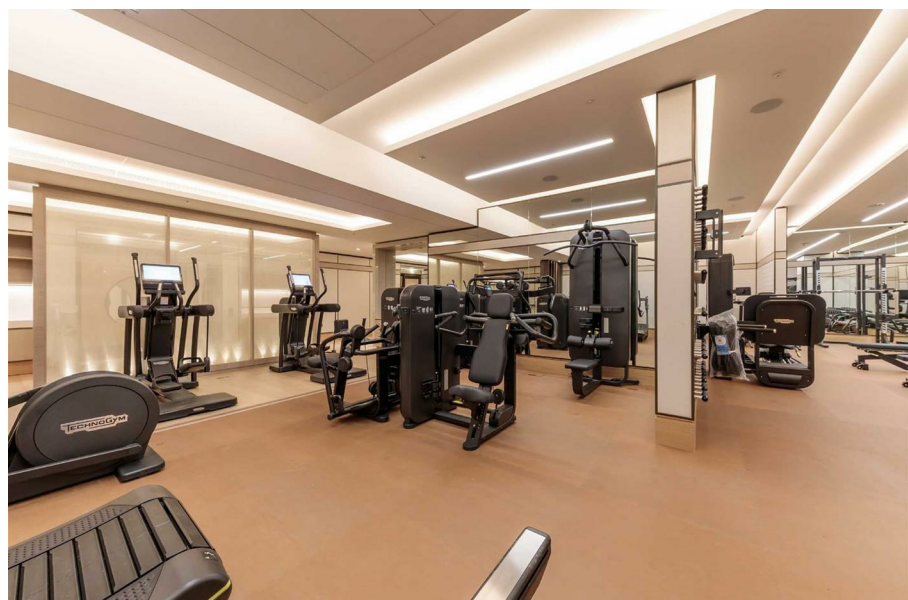



Floor Plans

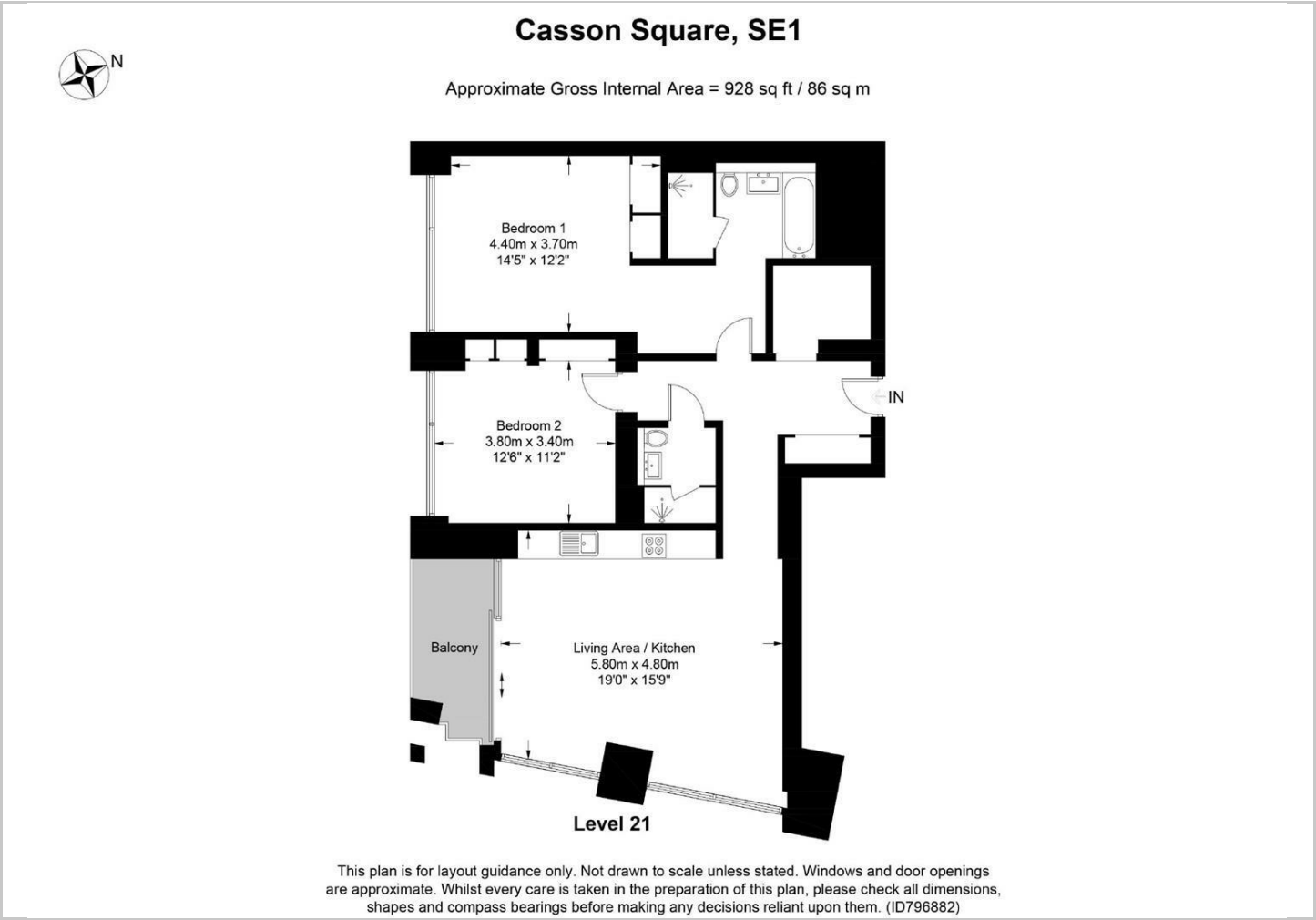

Viewing

Please contact our Hampstead Lettings Office on 020 7431 4488 if you wish to arrange a viewing appointment for this property or require further information.

The particulars are set out as a general outline only for the guidance of intended purchasers or lessees, and do not constitute, any part of a contract. Nothing in these particulars shall be deemed to be a statement that the property is in good structural condition or otherwise nor that any of the services, appliances, equipment or facilities are in good working order. Purchasers should satisfy themselves of this prior to purchasing.

92 Heath Street, Hampstead, London, NW3 1DP
Tel: 020 7431 4488 Email: info@wayne-silver.com wayne-silver.com

Location Map

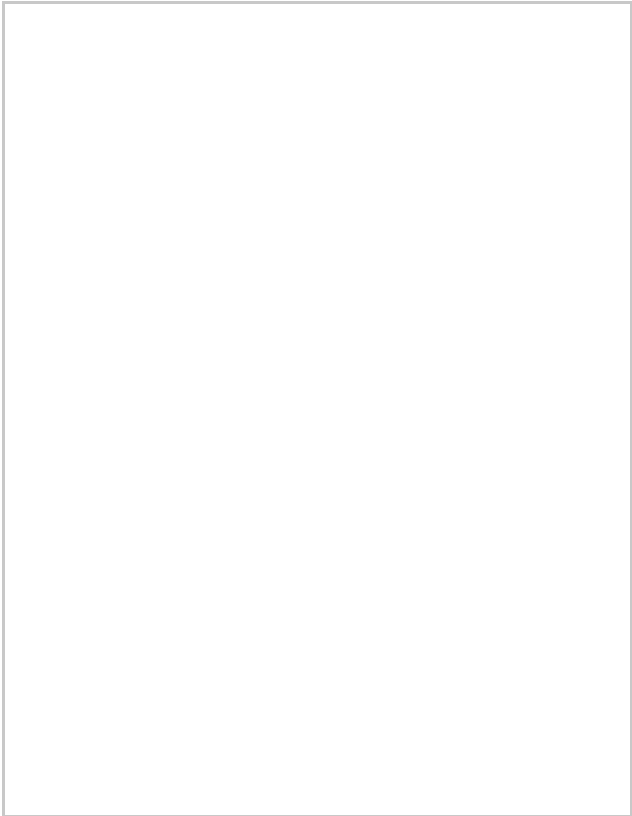

Energy Performance Graph

