



## Edward Square, Rotherhithe

Asking Price £375,000 Leasehold

OLIVER  JACQUES  
EST. 1986





# Edward Square, Rotherhithe

A one bedroom property in Edward Square occupying the first floor of a mock-Georgian riverside building. Forming part of Sovereign View, the property enjoys more generous proportions than you might expect in similar properties, spanning 49.9sqm (538sqft) and enjoying large double-glazed sash windows, looking across the river towards the City and the afternoon sun, which fill the space with light. Edward Square is a small gated square with well maintained foliage and access to the Thames Path. This property benefits from allocated off street parking and gas central heating, with an enviable location just a 6 minute stroll from the Riverboat service to Canary Wharf and beyond.

- One Bedroom Apartment
- First Floor Position
- West Facing River Views
- Allocated Parking
- Gas Central Heating
- 48.6sqm (523sqft)

South East London  
020 7231 5050

Email [southeast@o-j.co.uk](mailto:southeast@o-j.co.uk)

229-231 Lower Road, London, SE16 2LW

web [www.o-j.co.uk](http://www.o-j.co.uk)

Every care has been taken with the preparation of this brochure but it is for general guidance only and complete accuracy cannot be guaranteed. If there is any point, which is of importance professional verification should be sought. This brochure does not constitute a contract or part of a contract. We are not qualified to verify tenure of property. Prospective purchasers should seek clarification from their solicitor or verify the tenure of this property for themselves by visiting [www.gov.uk/government/organisations/land-registry](http://www.gov.uk/government/organisations/land-registry). The mention of any appliances, fixtures or fittings does not imply they are in full working order. Photographs are reproduced for general information and it cannot be inferred that any item shown is included in the sale. All dimensions are approximate. Walking times are taken from Google Maps and measured from the centre of the postcode, which may differ from the individual property. We always refer prospective buyers to our panelled conveyancers and Chancery Mortgage Services Ltd. It is your decision whether to use them. Should you decide to do so you should know that we could receive a referral fee from them for recommending them to you.

Edward Square, London, SE16  
Approximate Area = 538 sq ft / 49.9 sq m  
For identification only - Not to scale

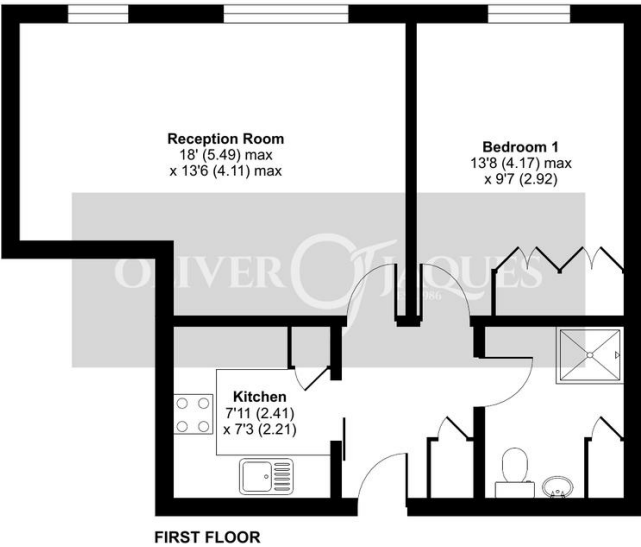

**RICS Certified Property Measurer**  
Floor plan produced in accordance with RICS Property Measurement Standards incorporating International Property Measurement Standards (IPMS2 Residential). © richcom 2022. Produced for Oliver Jacques. REF: 813565

