



College Road SE19
£385,000

0208 702 9333
[pedderproperty.com](https://www.pedderproperty.com)

pedder



In general

- 756 sq ft / 70.2 sq m
- No onward chain
- Sought after location
- Covered balcony with views
- 22ft reception room
- Residents parking
- Two double bedrooms

In detail

A light bright and well presented two double bedroom second floor apartment conveniently positioned for central Crystal Palace and transport links.

This spacious property totals 756 sq ft / 70.2 sq m and benefits from a covered balcony (with a south westerly aspect) offering pleasant green views and no onward chain. Other notable features include parquet flooring, a 22ft living area, fitted bedroom storage, a lift, residents parking, and a separate kitchen.

College Road is well placed for Gipsy Hill, Sydenham Hill and Crystal Palace rail links, also shopping and leisure options at the Crystal Palace Triangle, Gipsy Parade, and West Dulwich.

EPC: C



Floorplan

Princess Court SE19

Approximate Gross Internal Area
70.2 sq m / 756 sq ft

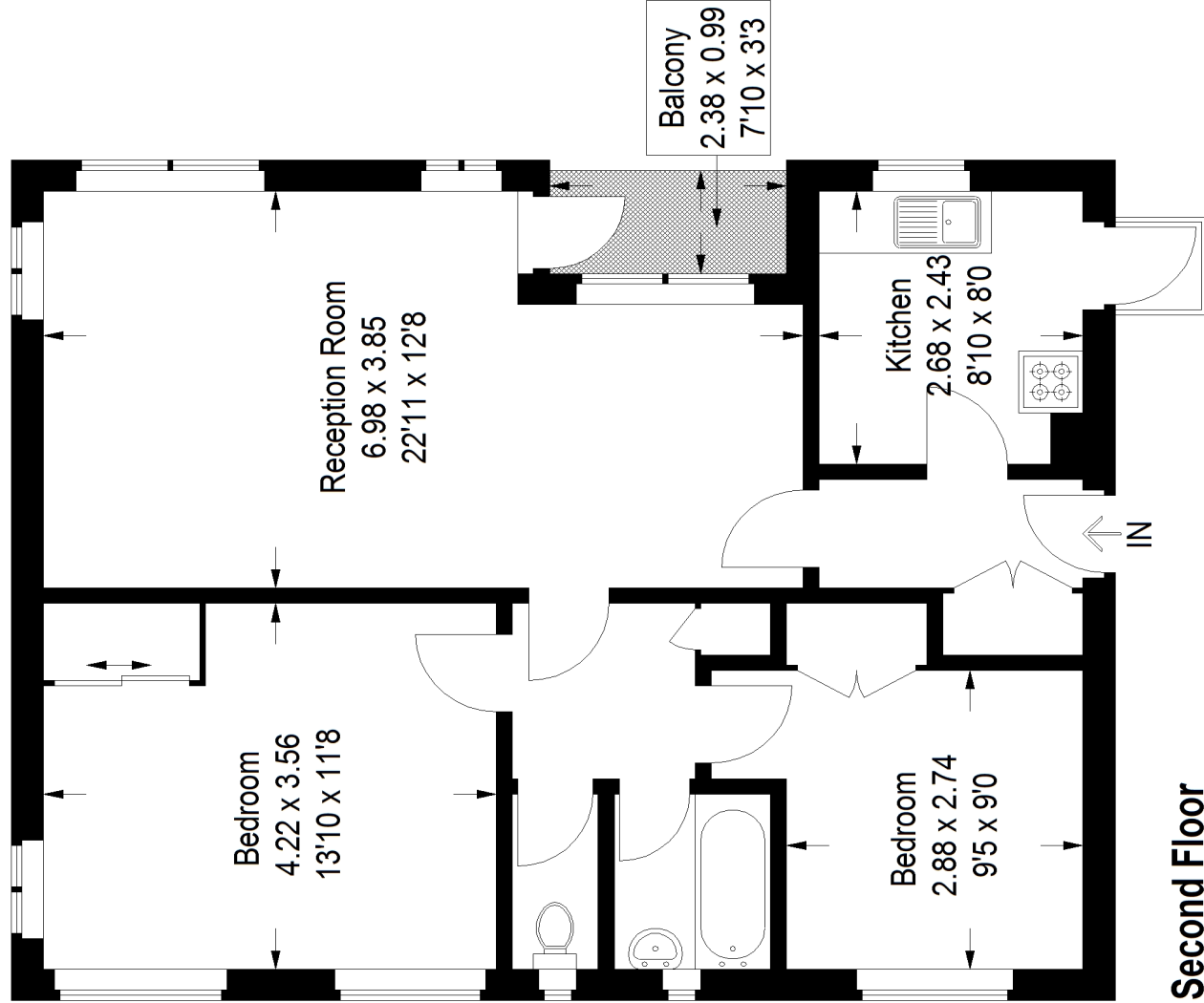

Second Floor

Copyright www.pedderproperty.com © 2021
These plans are for representation purposes only
as defined by RICS - Code of Measuring Practice.
Not drawn to Scale. Windows and door openings are
approximate. Please check all dimensions, shapes and
compass bearings before making any decisions reliant upon them.

Score	Energy rating	Current	Potential
92+	A		
81-91	B		
69-80	C	70 c	78 c
55-68	D		
39-54	E		
21-38	F		
1-20	G		

Pedder Property Ltd trading as Pedder for themselves and for the vendor/landlord of this property whose agents they are, give notice that (1) these particulars do not constitute any part of an offer or contract, (2) all statements contained within these particulars are made without responsibility on the part of Pedder or the vendor/landlord, (3) whilst made in good faith, none of the statements contained within these particulars are to be relied upon as a statement of representation or fact, (4) any intending purchaser/tenant must satisfy him/herself by inspection or otherwise as to the correctness of each of the statements contained within these particulars, (5) the vendor/landlord does not make or give either Pedder or any person in their employment any authority to make or give representation or warranty whatsoever in relation to this property.