

# WAYNE & SILVER



Maurice Walk, London, NW11 6JX  
Asking Price £1,300,000





Asking Price £1,300,000

# Maurice Walk

London, NW11 6JX

Positioned in a quiet crescent on the North side of Hampstead Garden Suburb is this three double bedroom semi-detached house. The property is situated within the Brooklands Primary school catchment area and within close proximity to the amenities of market place.

The property is in need of full refurbishment and offers ample living accommodation over two floors the house comprises a large entrance hall with guest W/C and cloakroom, kitchen, study and double aspect living room. To the first floor there are three double bedrooms (one en-suite) and family bathroom. The property further benefits from off street parking for 2 cars and a large west facing rear garden.

Planning permission has been granted for both a loft and single story rear extension to create a large 4 bedroom, 3 bathroom home. The majority of the loft conversion has already been completed, with the side and rear dormers already having been added.

Sole Agents.







# Floor Plans

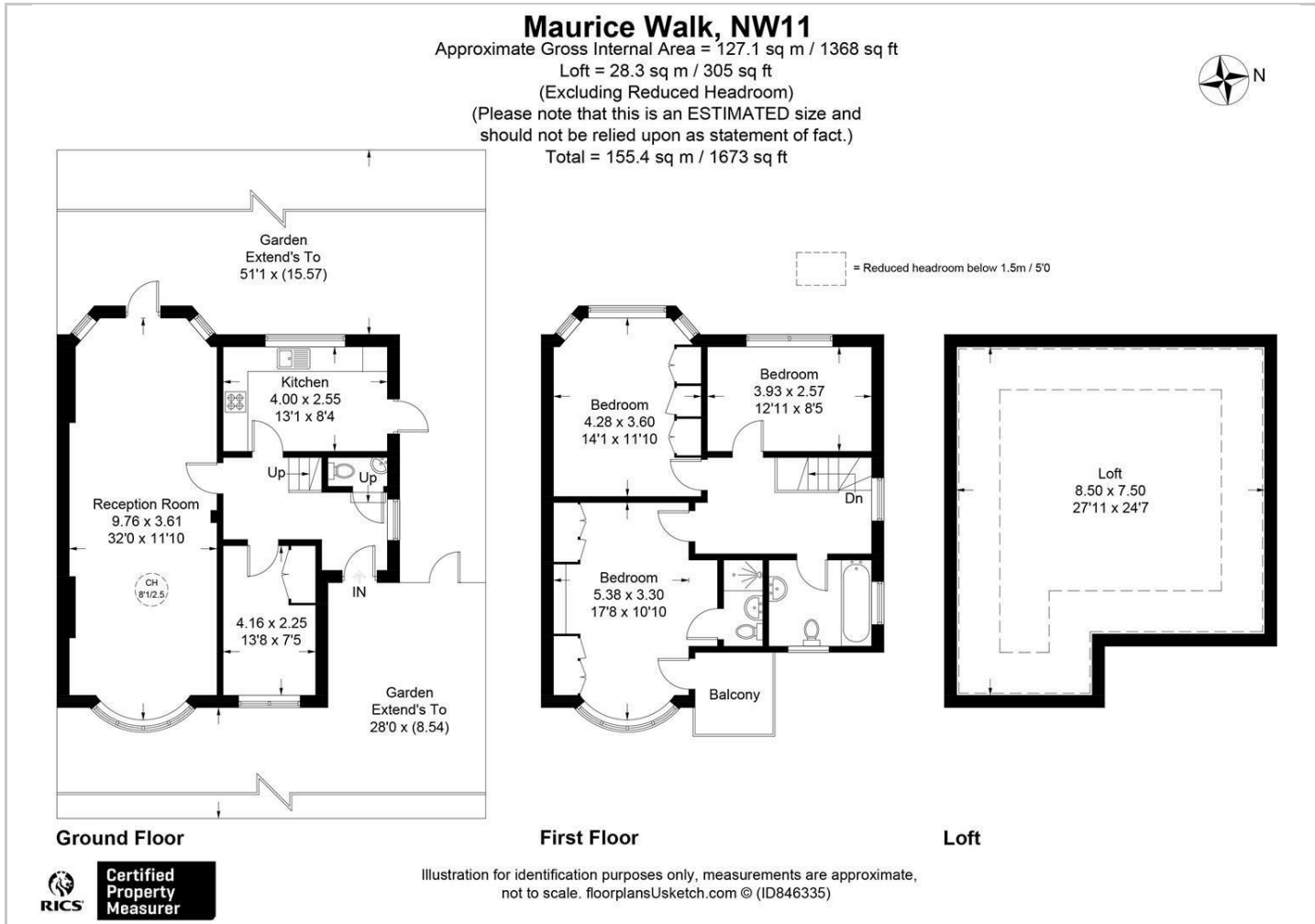

# Location Map

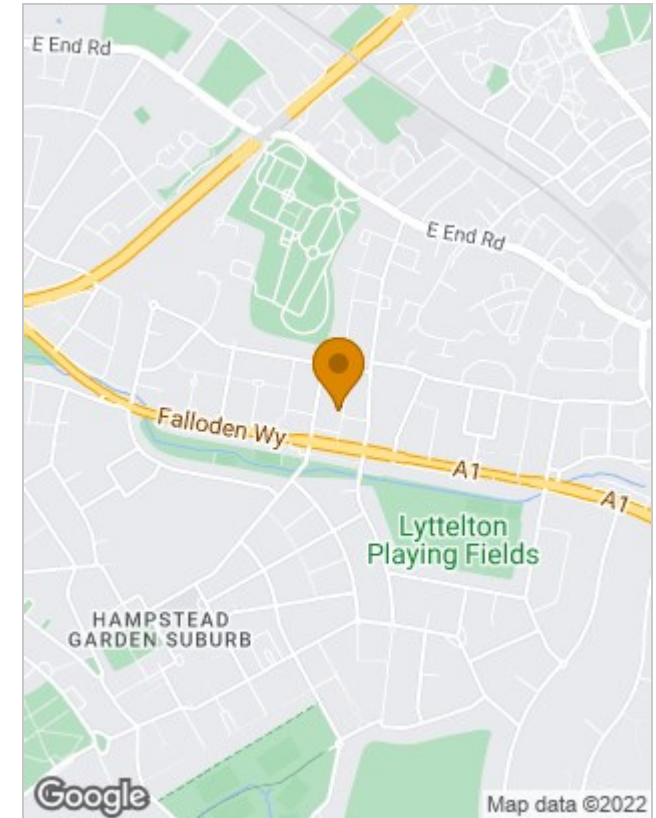

# Energy Performance Graph

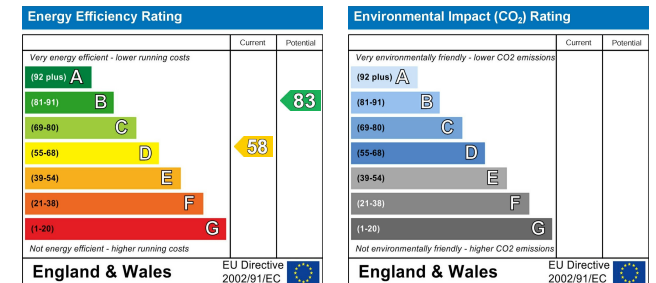

The particulars are set out as a general outline only for the guidance of intended purchasers or lessees, and do not constitute, any part of a contract. Nothing in these particulars shall be deemed to be a statement that the property is in good structural condition or otherwise nor that any of the services, appliances, equipment or facilities are in good working order. Purchasers should satisfy themselves of this prior to purchasing.