

ALLAN FULLER
— EST. 1983 —

149 Upper Richmond Road, Putney, London, SW15 2TX

t: 0208 788 8822

e: putney@allanfuller.co.uk

www.allanfuller.co.uk

Putney Hill London, SW15

Truly spacious, two double bedroom apartment, which offers fantastic living space with doors onto a Juliet balcony, separate kitchen & modern bathroom. This well presented home offers great storage and is set on the second floor of this private development, benefitting from lift and on street parking with permit.

Sylva Court is located just off the top off Putney Hill, within striking distance of Putney Town Centre, as well as both Putney Mainline Station and East Putney Underground (District Line). The Green Man Bus Terminus offers regular services to Putney, Fulham, Roehampton and Wimbledon. Wimbledon Common and Putney Heath are on the doorstep and, with Richmond Park close by, there is easy access to some of South West London's best green spaces.

Available furnished from the 4th July.



£1,625





Sylva Court, SW15

Approx. Gross Internal Area 789 Sq Ft - 73.30 Sq M

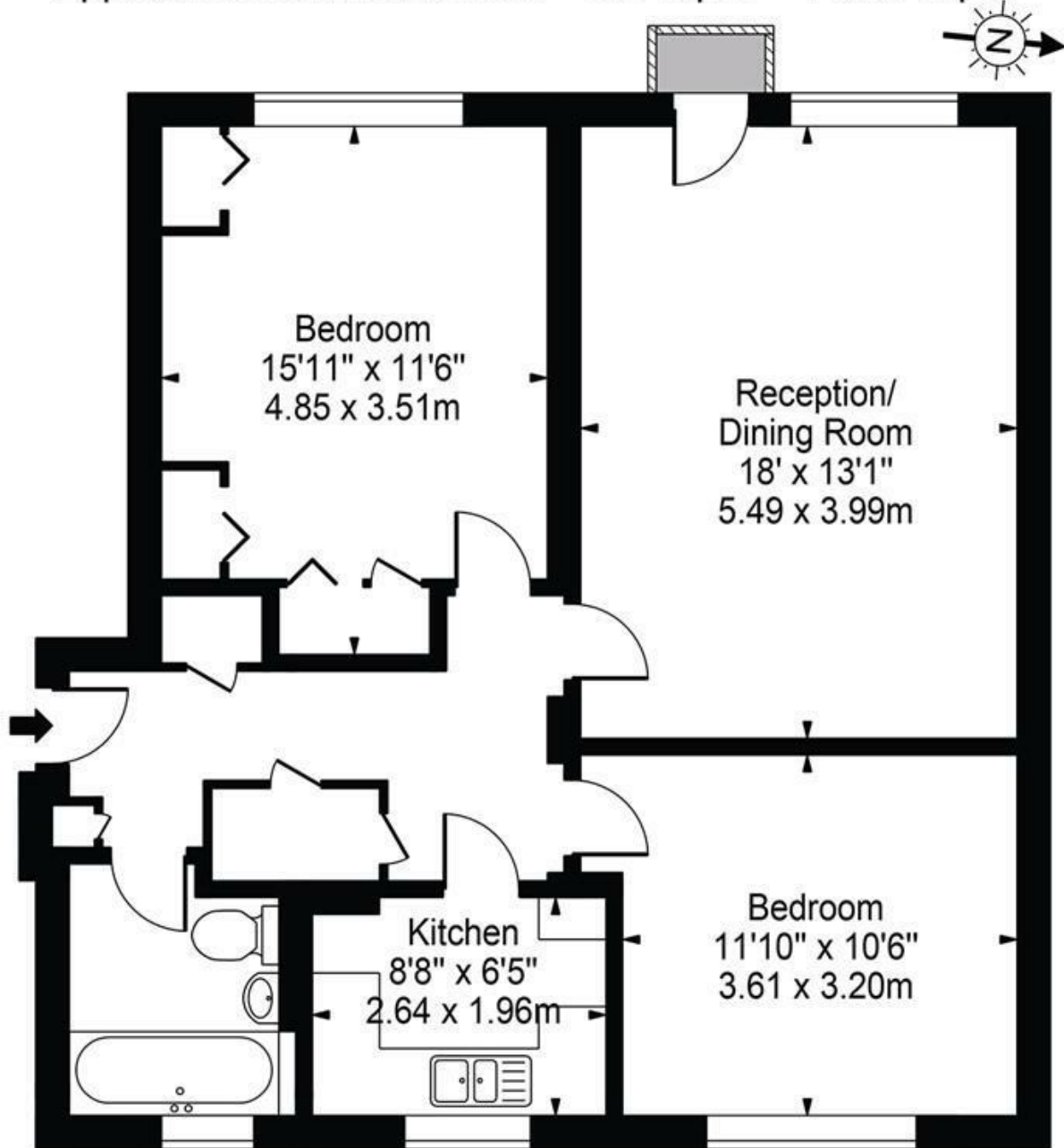

Second Floor



For Illustration Purposes Only - Not To Scale Floor Plan by Mira Nikolova Photography

This floor plan should be used as a general outline for guidance only and does not constitute in whole or in part an offer or contract. Any intending purchaser or lessee should satisfy themselves by inspection, searches, enquiries and full survey as to the correctness of each statement. Any areas, measurements or distances quoted are approximate and should not be used to value a property or be the basis of any sale or let.

With regards to any information supplied by us in relation to lease, ground rent and service charge it is essential that you have this information checked by your solicitor. We have transmitted information supplied to us by the vendor of the property but we have not been able to inspect the lease to check its accuracy. Please note that we have not tested any of the equipment or utilities at this property, nothing in these particulars shall be deemed a statement that the property is in good condition or otherwise nor that any of the services or facilities are in good working order. Measurements are approximate they were taken with a sonic tape, are as accurate as possible and usually measured from the widest point of any room. Description provided herein represents the opinion of the author, is given in good faith but should not be constructed as statements of fact. The particulars and photograph are for guidance only.