



Mitchell House, W4 4DT

UNDER OFFER A nicely presented purpose-built one bedroomed apartment situated within this private development just moments from Chiswick High Road with is an array of boutique shops and restaurants, retailers include M&S, Waitrose, Sainsburys & Tesco. The accommodation provides reception room with dual aspect, a fitted separate kitchen with integrated appliances, a double bedroom with custom-built wardrobes, a fitted bathroom, private designated parking, communal gardens. Local transport links include both Chiswick park & Gunnersbury tube Stations, numerous local bus routes with convenient vehicular access via A4/M4 Central London, Heathrow & The West the property is offered as furnished and is available 5th March

- Nicely presented one bedroomed apartment
- Pleasant central Chiswick location
- Great for transport links
- Dual aspect reception room
- Fitted modern kitchen with integrated appliances
- Double bedroom with custom built wardrobes
- Bathroom with shower over
- Private designated parking space
- Communal gardens
- Available 5th March, furnished

£1,330 PCM

Mitchel House, Oxford Road North, W4

Key :
CH - Ceiling Height

Approximate gross internal area
41.62 sq m / 448 sq ft

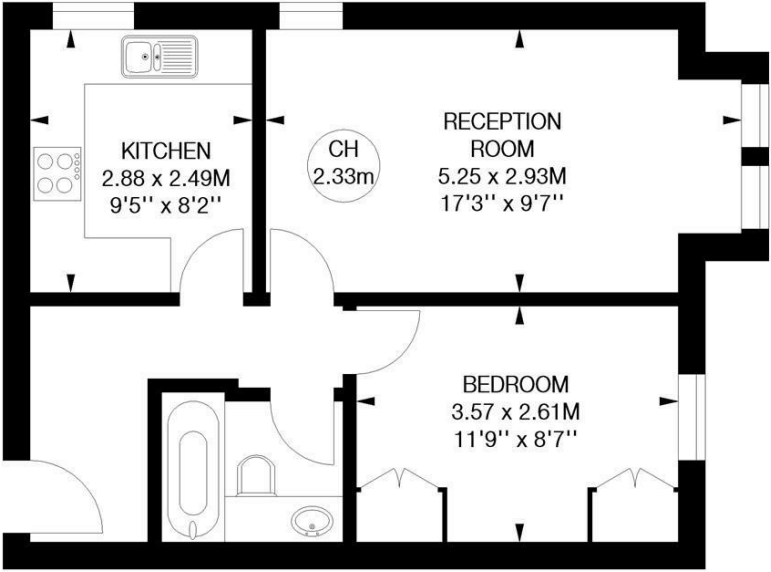

Second Floor

Not to scale, for guidance only and must not be relied upon as a statement of fact.
All measurements and areas are approximate only

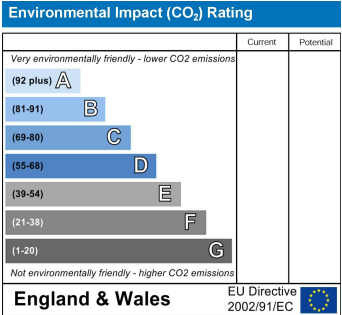
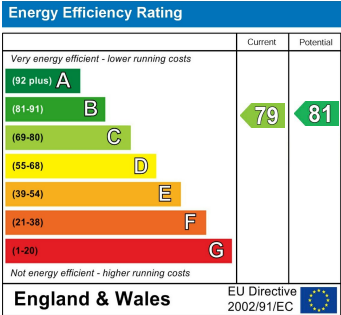

5-7 Turnham Green Terrace, Chiswick, London, W4 1RG
Tel 020 8747 8800
E-mail lettings@whitmanandco.com
Website www.whitmanandco.com