



18 Old Oak Common Lane
Acton
London
W3 7EL
T: 020 8749 9798
E: sales@churchillmathesons.com
www.churchillmathesons.com

Churchill & Mathesons

Glynfield Road, London, NW10 9LD

Asking Price £365,000 Leasehold



KEY FEATURES:

- TWO BEDROOMS
- GROUND FLOOR FLAT
- OPEN PLAN LOUNGE/KITCHEN
- SHOWER ROOM
- NO THROUGH ROAD
- CLOSE TO SHOPS
- CLOSE TO STATION

A TWO BEDROOM GROUND FLOOR FLAT WITH REAR GARDEN.

The property comprises of entrance hall, open plan lounge/kitchen with doors leading to a private rear garden, two double bedrooms and shower room.

Glynfield Road is located close to local shops, independent cafes and schools. Roundwood Park is a 15 minute walk and local transport links including a wide range of bus routes and Harlesden Station (London Overground & Bakerloo Line - Zone 3) is just a short walk away. London Borough of Brent. Council Tax Band B.

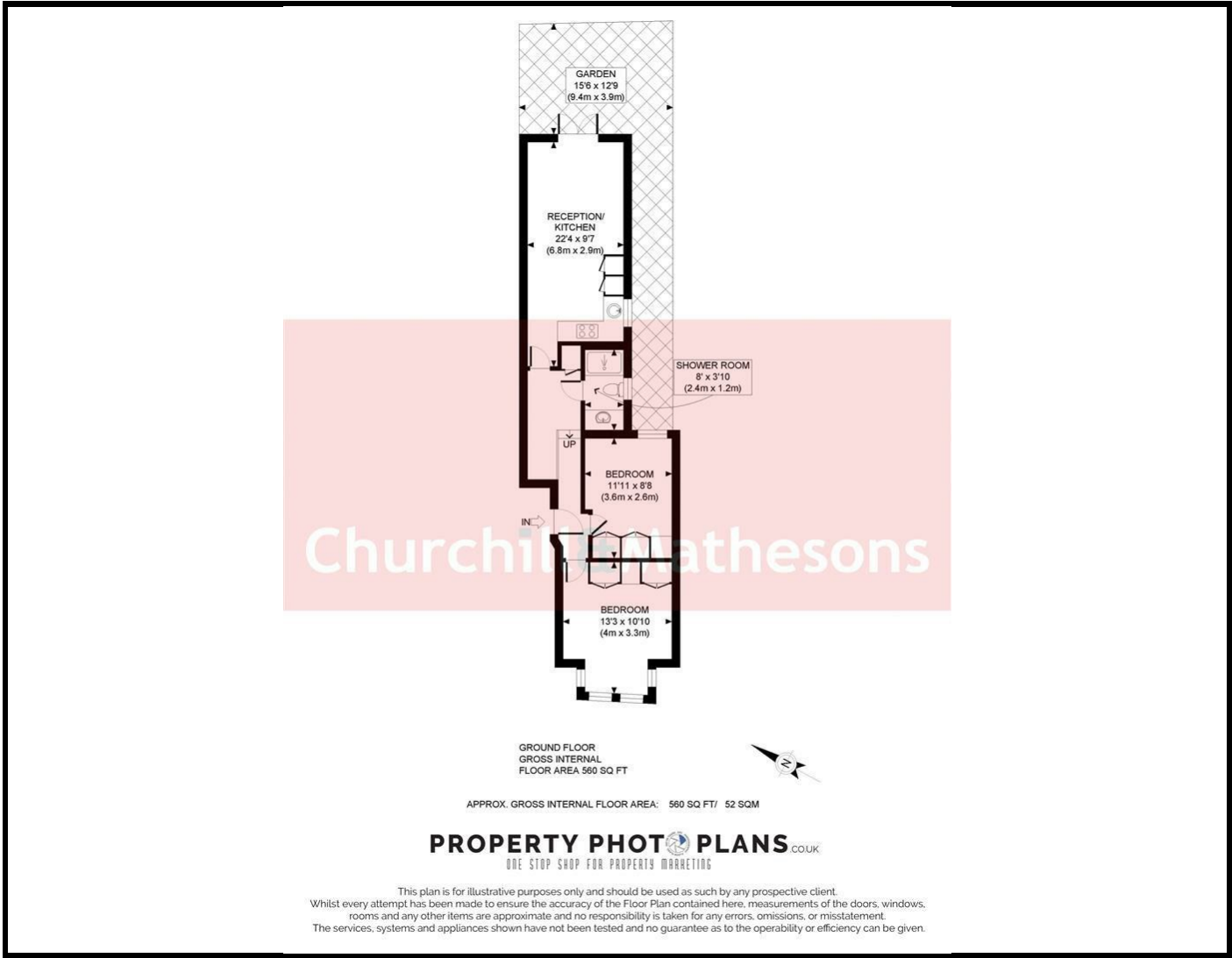

Energy Efficiency Rating		
	Current	Potential
Very energy efficient - lower running costs		
(92 plus) A		
(81-91) B		
(69-80) C	69	76
(55-68) D		
(39-54) E		
(21-38) F		
(1-20) G		
Not energy efficient - higher running costs		
England & Wales	EU Directive 2002/91/EC	

Environmental Impact (CO ₂) Rating		
	Current	Potential
Very environmentally friendly - lower CO ₂ emissions		
(92 plus) A		
(81-91) B		
(69-80) C		
(55-68) D		
(39-54) E		
(21-38) F		
(1-20) G		
Not environmentally friendly - higher CO ₂ emissions		
England & Wales	EU Directive 2002/91/EC	

Whilst every effort is made to give a fair description, the accuracy of these particulars is not guaranteed, neither do they constitute an offer or contract.

CHURCHILL & MATHESONS ESTATE AGENTS have not tested any apparatus, equipment, fitting or services and so cannot verify that they are in working order. The buyer is advised to obtain verification from their solicitor or surveyor. Measurements are correct to within +/-6 A sonic tape is used. None of the statements contained in these particulars or any of our properties are to be relied upon as a representation of fact.