



# Coopers Close, London

Asking Price £270,000 Leasehold

OLIVER  JACQUES  
EST. 1986





# Coopers Close, London

This wonderfully presented studio apartment is now available for sale. Offering a modern integrated kitchen with all white goods, a well presented three piece bathroom suite and a naturally bright living/bedroom area. With ample built in storage this studio is equipped with a store away double bed, allowing for more living space to entertain guests. Further benefits include allocated parking in a gated car park and is within walking distance to a variety of amenities and public transport at Stepney Green Station.

Video tour available upon request

- Studio Apartment
- Modern Kitchen
- Naturally Bright
- Ample Storage
- Gated Parking
- Close To Amenities

East London  
020 8980 0999

Email [east@o-j.co.uk](mailto:east@o-j.co.uk)

229-231 Lower Road, London, SE16 2LW

web [www.o-j.co.uk](http://www.o-j.co.uk)

Every care has been taken with the preparation of this brochure but it is for general guidance only and complete accuracy cannot be guaranteed. If there is any point, which is of importance professional verification should be sought. This brochure does not constitute a contract or part of a contract. We are not qualified to verify tenure of property. Prospective purchasers should seek clarification from their solicitor or verify the tenure of this property for themselves by visiting [www.gov.uk/government/organisations/land-registry](http://www.gov.uk/government/organisations/land-registry). The mention of any appliances, fixtures or fittings does not imply they are in full working order. Photographs are reproduced for general information and it cannot be inferred that any item shown is included in the sale. All dimensions are approximate. Walking times are taken from Google Maps and measured from the centre of the postcode, which may differ from the individual property. We always refer prospective buyers to our panelled conveyancers and Chancery Mortgage Services Ltd. It is your decision whether to use them. Should you decide to do so you should know that we could receive a referral fee from them for recommending them to you.

## Coopers Close, London, E1

Approximate Area = 244 sq ft / 22.7 sq m  
For identification only - Not to scale

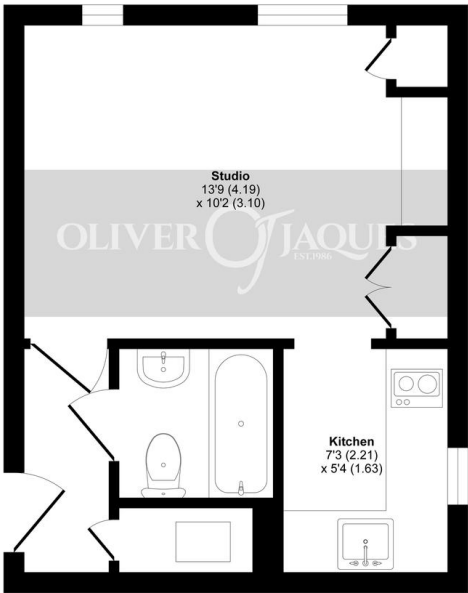

GROUND FLOOR

Floor plan produced in accordance with RICS Property Measurement Standards incorporating International Property Measurement Standards (IPMS2 Residential). © richhcom 2021. Produced for Oliver Jacques - REF: 788925

