



Chester Court, Deptford

Offers in Excess of £310,000 Leasehold

OLIVER *OJ* JAKES
EST. 1986



Chester Court, Deptford

A beautifully presented apartment with garage, located within a secure development with intercom operated entry gates, a short stroll from Surrey Quays and Canada Water stations. The property boasts approximately 500sqft of internal accommodation in addition to a private balcony. Located on the first floor of a two-storey building, this well-loved home has benefitted from the recent addition of uPVC double glazed windows, wooden flooring throughout and updated kitchen. Further benefits include a 970 year lease, low service charge (relative to the market) and a quiet situation away from the main road. The property would make a great starter home for a first-time buyer.

- First Floor Apartment
- en Bloc Garage
- Private Balcony
- uPVC Double Glazed Windows
- High Decorative Order
- Secure Gated Development

South East London
020 7231 5050

Email southeast@o-j.co.uk

229-231 Lower Road, London, SE16 2LW

web www.o-j.co.uk

Every care has been taken with the preparation of this brochure but it is for general guidance only and complete accuracy cannot be guaranteed. If there is any point, which is of importance professional verification should be sought. This brochure does not constitute a contract or part of a contract. We are not qualified to verify tenure of property. Prospective purchasers should seek clarification from their solicitor or verify the tenure of this property for themselves by visiting www.landregisteronline.gov.uk. The mention of any appliances, fixtures or fittings does not imply they are in full working order. Photographs are reproduced for general information and it cannot be inferred that any item shown is included in the sale. All dimensions are approximate. Walking times are taken from Google Maps and measured from the centre of the postcode, which may differ slightly from the individual property.

Trundleys Road, London, SE8

APPROX. GROSS INTERNAL FLOOR AREA 470 SQ FT (EXCLUDING GARAGE)

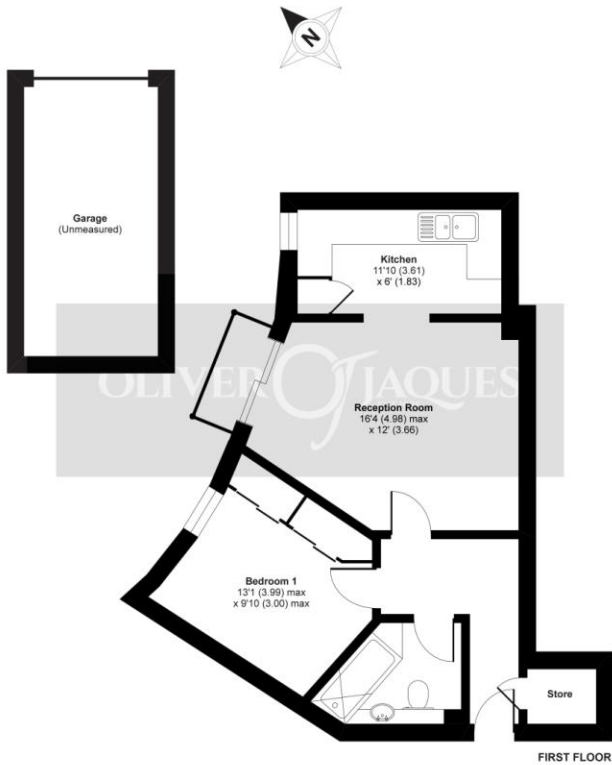

Whilst every attempt has been made to ensure the accuracy of the floor plan contained here, measurements of doors, windows and rooms are approximate and no responsibility is taken for any error, omission or misstatement. These plans are for representation purposes only as defined by RICS Code of Measuring Practice and should be used as such by any prospective purchaser. Specifically no guarantee is given on the total square footage of the property if quoted on this plan. Any figure given is for initial guidance only and should not be relied on as a basis of valuation.

Copyright nichecom.co.uk 2020 Produced for Oliver Jaques REF : 583294

