

Manhattan Building, Fairfield Road

Asking Price £475,000 Leasehold

OLIVER TYRRELL



Manhattan Building, Fairfield Road

Inside the Bow Quarter is a substantially large one/two bedroom apartment within the Manhattan Building, a period warehouse conversion that is part of the highly sought after Bow Quarter development. Internally this apartment boasts an incredibly spacious and well lit living area thanks to the period windows and double-height ceilings, with a stylish mezzanine-level and ample storage throughout. The property also benefits from an allocated, covered parking space. Amenities include exclusive access to the on-site Leisure Centre including; Gym, Pool, Sauna & Spa, 24 hour concierge and an estates office/mail room. This property is ideally located for easy access to the A12, the City, Canary Wharf and is less than a ten minute walk to both Bow Road tube and Bow Church DLR.

- Double Factory Window
- High Ceilings
- Courtyard Facing
- Gated Development
- Allocated Parking
- Swimming Pool & Gym

East London
020 8980 0999

Email east@o-j.co.uk

229-231 Lower Road, London, SE16 2LW

web www.o-j.co.uk

Every care has been taken with the preparation of this brochure but it is for general guidance only and complete accuracy cannot be guaranteed. If there is any point, which is of importance professional verification should be sought. This brochure does not constitute a contract or part of a contract. We are not qualified to verify tenure of property. Prospective purchasers should seek clarification from their solicitor or verify the tenure of this property for themselves by visiting www.gov.uk/government/organisations/land-registry. The mention of any appliances, fixtures or fittings does not imply they are in full working order. Photographs are reproduced for general information and it cannot be inferred that any item shown is included in the sale. All dimensions are approximate. Walking times are taken from Google Maps and measured from the centre of the postcode, which may differ from the individual property. We always refer prospective buyers to our panelled conveyancers and Chancery Mortgage Services Ltd. It is your decision whether to use them. Should you decide to do so you should know that we could receive a referral fee from them for recommending them to you.

Fairfield Road, Bow Quarter, London, E3

Total = 891 sq ft / 82.8 sq m
For identification only - Not to scale

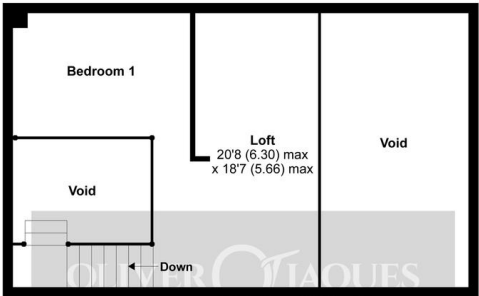

FIRST FLOOR

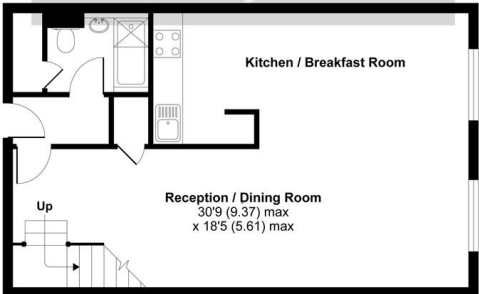

GROUND FLOOR

Certified Property Measurement Floor plan produced in accordance with RICS Property Measurement Standards incorporating International Property Measurement Standards (IPMS2 Residential). © richcom 2021. Produced for Oliver Jacques. REF: 737820

