

WAYNE & SILVER



6 Wickliffe Avenue, Finchley Central, N3 3HG

£495 Per Week





£495 Per Week

6 Wickliffe Avenue

Finchley Central, N3 3HG

Delighted to offer to rent is a recently redecorated 3 bedroom apartment set on the first floor in a purpose built block in a cul-de-sac off Hendon Lane. The building has a lift and well-tended communal gardens. The apartment benefits from a bright 20ft reception room with a full width balcony overlooking Windsor Open Space, 2 modern bathrooms (1 en-suite shower room), modern fully-fitted kitchen and a parking spot for 1 car. The local amenities and the underground station at Finchley Central (Northern Line) and within walking distance.





Floor Plans

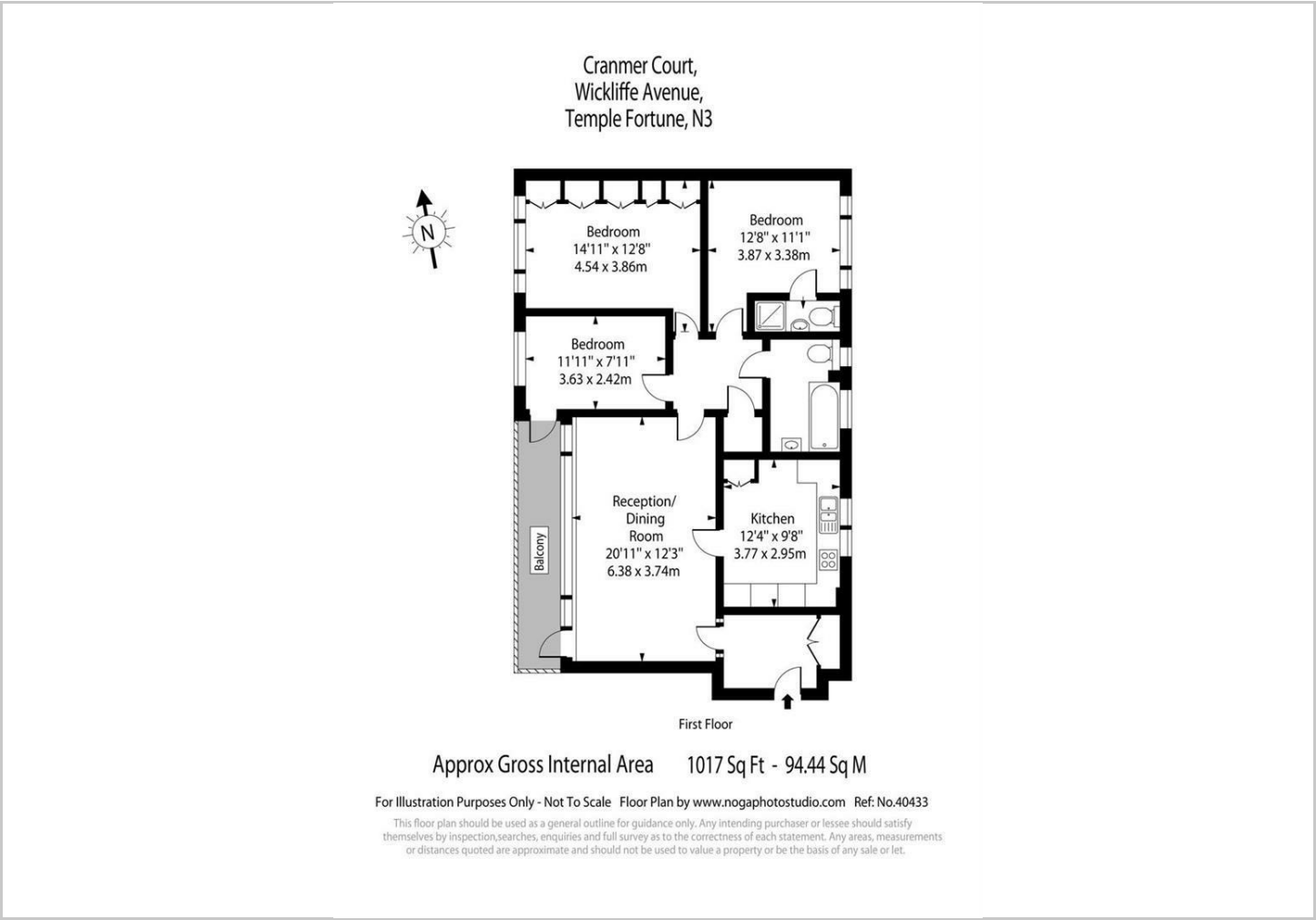

Viewing

Please contact our Hampstead Lettings Office on 020 7431 4488 if you wish to arrange a viewing appointment for this property or require further information.

The particulars are set out as a general outline only for the guidance of intended purchasers or lessees, and do not constitute, any part of a contract. Nothing in these particulars shall be deemed to be a statement that the property is in good structural condition or otherwise nor that any of the services, appliances, equipment or facilities are in good working order. Purchasers should satisfy themselves of this prior to purchasing.

92 Heath Street, Hampstead, London, NW3 1DP
Tel: 020 7431 4488 Email: info@wayne-silver.com wayne-silver.com

Location Map



Energy Performance Graph

