



**Nelson Walk, London**

**Asking Price £470,000** Leasehold

**OLIVER *OJ* JAQUES**  
EST.1986





# Nelson Walk, London

Forming part of the highly sought after gated Barratts development, this two bedroom apartment enjoys over 650 Sq Foot of internal space. The apartment has a fantastic living room featuring high ceilings and a balcony. A modern, fully integrated kitchen with two double bedrooms all with floor to ceiling windows offering the property plenty of natural light and both bedrooms overlook the communal areas/gardens. The property also includes an allocated secure parking space, on-site cycle storage, private and secure play areas for children and the development is complete with on-site concierge. The property also benefits from Schools and GP surgery (St Andrews) on the base. This development is situated a short walk away from Bromley By Bow Station, Devons Road DLR Station and plenty of local bus routes making it an easy commute to both the City and Docklands.

- 24 Hour Concierge
- Naturally Bright
- Private Balcony
- Gated Development
- Gymnasium
- Close to Train Stations

East London  
020 8980 0999

Email [east@o-j.co.uk](mailto:east@o-j.co.uk)

229-231 Lower Road, London, SE16 2LW

web [www.o-j.co.uk](http://www.o-j.co.uk)

Every care has been taken with the preparation of this brochure but it is for general guidance only and complete accuracy cannot be guaranteed. If there is any point, which is of importance professional verification should be sought. This brochure does not constitute a contract or part of a contract. We are not qualified to verify tenure of property. Prospective purchasers should seek clarification from their solicitor or verify the tenure of this property for themselves by visiting [www.gov.uk/government/organisations/land-registry](http://www.gov.uk/government/organisations/land-registry). The mention of any appliances, fixtures or fittings does not imply they are in full working order. Photographs are reproduced for general information and it cannot be inferred that any item shown is included in the sale. All dimensions are approximate. Walking times are taken from Google Maps and measured from the centre of the postcode, which may differ from the individual property. We always refer prospective buyers to our panelled conveyancers and Chancery Mortgage Services Ltd. It is your decision whether to use them. Should you decide to do so you should know that we could receive a referral fee from them for recommending them to you.

Nelson Walk, London, E3  
Approximate Area = 658 sq ft / 61.1 sq m  
For identification only - Not to scale

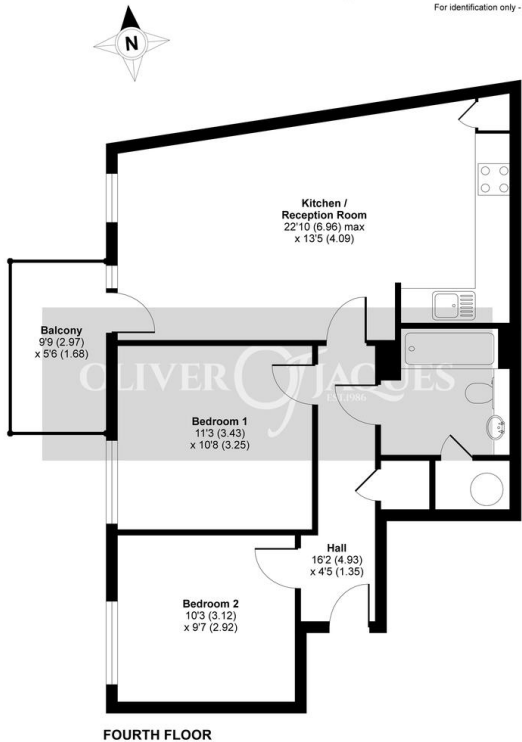

Certified Property Measurer  
Floor plan produced in accordance with RICS Property Measurement Standards incorporating International Property Measurement Standards (IPMS Residential). © richocoon 2021. Produced for Oliver Jacques - REF: 779755

