



Palladian Gardens, London, W4 2DG

Guide Price £500,000

**WHITMAN & CO.**

SALES · LETTINGS · COMMERCIAL



- Set within a luxury complex
- Residents parking and bike storage
- Fantastic location
- Private courtyard garden
- NHBC warranty
- No chain

Tenure - Leasehold  
 Lease length - 121 years  
 Service Charge - approx £3000 pa  
 Ground Rent - £400 pa  
 Local authority - Hounslow  
 Council tax - Band E

## THE PROPERTY

An immaculately presented spacious one bedroom apartment set within this luxury complex with the added benefit of a private courtyard terrace. This modern apartment offers a bright double bedroom, extensive built-in storage, a large entrance hall, 17' reception room with French doors to the garden, fully integrated kitchen/breakfast room, triple glazed, residential/visitors parking, secure bike storage, porter/concierge. Close proximity to numerous amenities. No chain.

Key :  
 CH - Ceiling Height

## Cherry Blossom Court, Chiswick Gate, W4

Approximate gross internal area

55.74 sq m / 600 sq ft

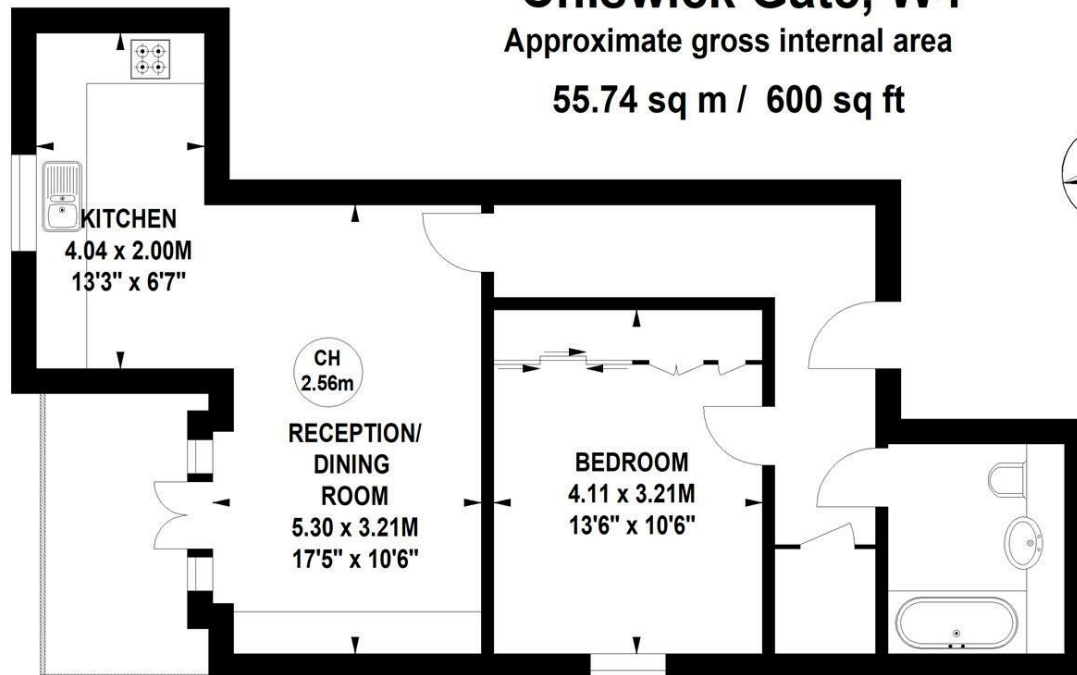

## Ground Floor

Not to scale, for guidance only and must not be relied upon as a statement of fact.  
 All measurements and areas are approximate only

## SITUATION

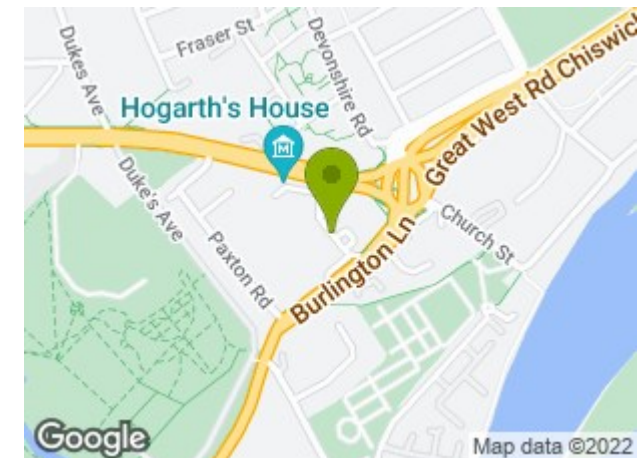

5-7 Turnham Green Terrace, Chiswick, London, W4 1RG

Tel 020 8747 8800

E-mail [sales@whitmanandco.com](mailto:sales@whitmanandco.com)

Website [www.whitmanandco.com](http://www.whitmanandco.com)