

Glebe Street, London, W4 2BD

£1,625,000

**WHITMAN & CO.**

SALES · LETTINGS · COMMERCIAL

- Fully refurbished high spec property
- Stunning 45' main living space
- Master bedroom suite
- Located in the heart of Chiswick's Glebe Estate
- Garden studio
- Bespoke fixtures and fittings throughout

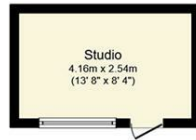

### 3 Glebe Street | Chiswick

Total floor area 151.0 sq. m. (1,625 sq. ft.) approx



Ground Floor



First Floor



Second Floor

This floor plan is for illustrative purposes only. It is not drawn to scale. Any measurements, floor areas (including any total floor area), openings and orientation are approximate. No details are guaranteed, they cannot be relied upon for any purpose and they do not form part of any agreement. No liability is taken for any error, omission or misstatement. A party must rely upon its own inspection(s). Plan produced for Purple Bricks. Powered by www.focalagent.com

Tenure - Freehold  
Local Authority - Hounslow  
Council Tax - Band TBC

## THE PROPERTY

3 Glebe street is located in the heart of Chiswick's Glebe Estate, one of the most sought after residential neighbourhoods in London.

This grid of charming Victorian terraced houses is situated moments from Chiswick High Road with its indulgent mix of bistros, cafes, bars and delis and Devonshire Road renowned for its boutiques, wine bars and the Michelin starred La Trompette. The A4 and District Line Station at Turnham Green mean access in and out of the city is fast and stress-free.

With their passion for beautiful architecture and thoughtfully planned design, the JLBD team took a year to meticulously reinstate the floors and walls to achieve maximum ceiling height, room dimensions and to flood this magnificent home with natural light.

This 4 bed fully refurbished high spec property is for sale now.

## SITUATION

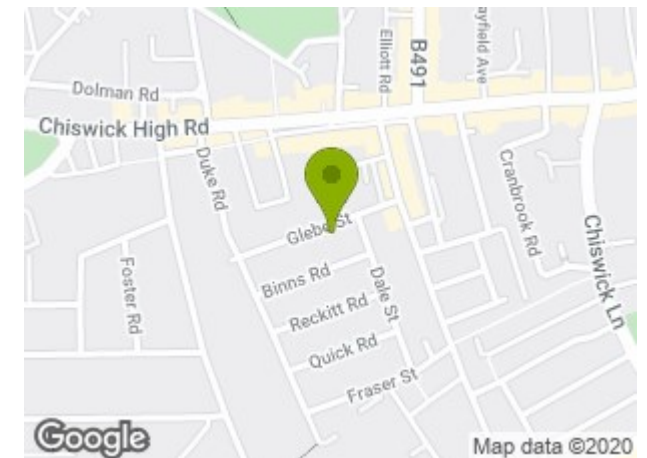

5-7 Turnham Green Terrace, Chiswick, London, W4 1RG

Tel 020 8747 8300

E-mail [sales@whitmanandco.com](mailto:sales@whitmanandco.com)

Website [www.whitmanandco.com](http://www.whitmanandco.com)



MISREPRESENTATION ACT 1967

Whitman & Co. for themselves and for the vendors give notice that these particulars do not constitute any part of, an offer of contract. All statements contained in these particulars are made without responsibility on the part of Whitman & Co. or the vendor. None of the statements contained in these particulars is to be relied upon as statements or representations of facts. Any intending purchaser must satisfy himself by inspection or otherwise as to the correctness of each of the statements contained in these particulars. The vendor does not make or give, and neither Whitman & Co. or any person in their employment has any authority to make or give, any representation or warranty whatever in relation to the property.