

## Hartfield Crescent Wimbledon, SW19 3SA

**£775,000 Freehold**



A two double bedroom Victorian family home with no onward chain located moments from Wimbledon town centre and within priority catchment of Dundonald Primary School. This lovely property has lots of character and great potential to extend subject to the usual consents. There is a front living room with feature fireplace, a dining room, separate kitchen and access out to a low maintenance garden. Upstairs are two good double bedrooms and a spacious family bathroom.



## Hartfield Crescent, SW19

Approximate Gross Internal Area = 73.4 sq m / 790 sq ft

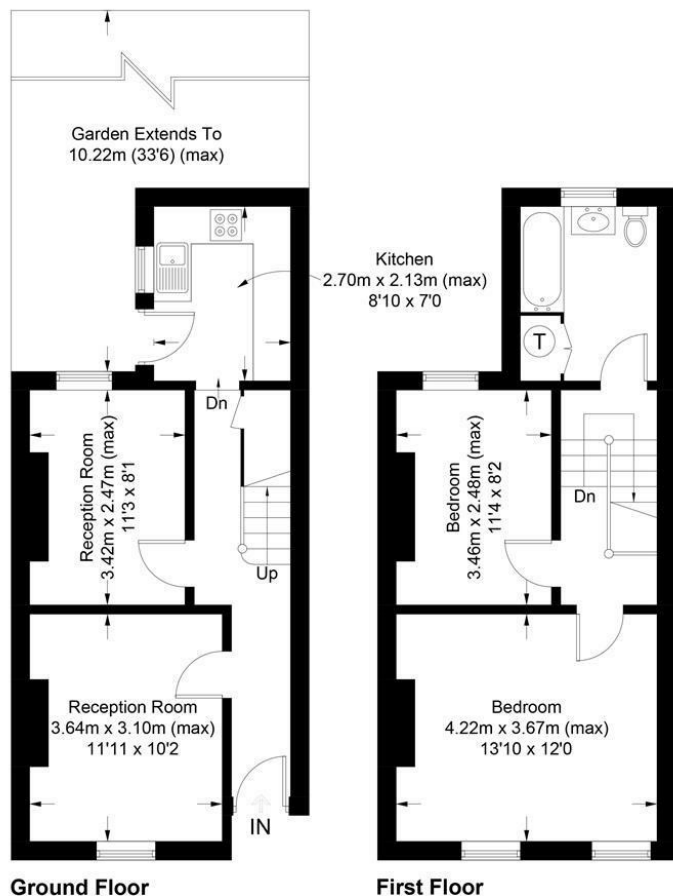

This floor plan is for representation purposes only and is not drawn to scale.  
The Gross Internal Area includes outbuildings shown on the plan.  
Whilst every attempt has been made to ensure the accuracy of the plan measurements of doors, windows and rooms are approximate only and should be checked before making any decisions reliant upon them.  
Copyright Bespokeplans.co.uk (ID827085)



- Two Bedroom Victorian Property
- Lots of Character
- Potential to Extend STPP
- No Onward Chain
- Two Reception Rooms
- Low Maintenance Garden
- Priority Catchment to Dundonald Primary School
- Close to Wimbledon Town Centre
- EPC Rating E
- Council Tax Band E

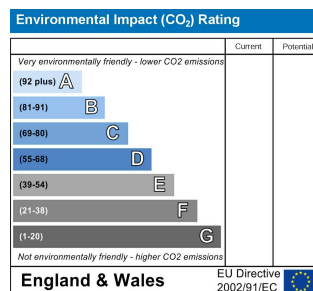
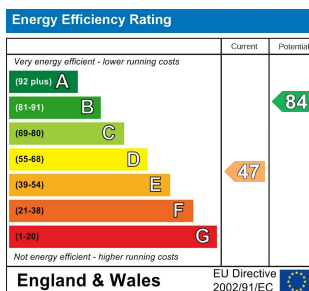

For Free Mortgage Quote and Best Mortgage Rates, call an Ellisons Mortgage Advisor on 020 8944 9494



Although these particulars are believed to be correct, their accuracy is not guaranteed and they do not form part of any contract.

**Celebrating 30 years of successful Sales and Lettings in Merton**

