



Staveley Road, London, W4 3HU

Guide Price £1,950,000

WHITMAN & CO.

SALES · LETTINGS · COMMERCIAL

- Impressive detached house
- Sought after tree-lined residential road
- Off street-parking
- Five bedrooms
- Private 40' landscaped garden
- Great transport links

Tenure - Freehold
Local Authority - Hounslow
Council Tax - Band G

THE PROPERTY

An immaculate five bedroom detached house offering an excellent balance of living and entertaining space in this sought after tree-lined residential road close to numerous amenities. This impressive property comprises a master bedroom with dressing room and ensuite, four further bedrooms, luxury family bathroom, additional shower room, large entrance hall, three reception rooms, fully integrated kitchen/breakfast room, utility room, dining room, study, cloak room, extensive storage throughout, private 40' landscaped garden and the added benefit of off-street parking. Ideally situated in the heart of Grove Park offering close proximity to parks, local shopping facilities and transport.

SITUATION

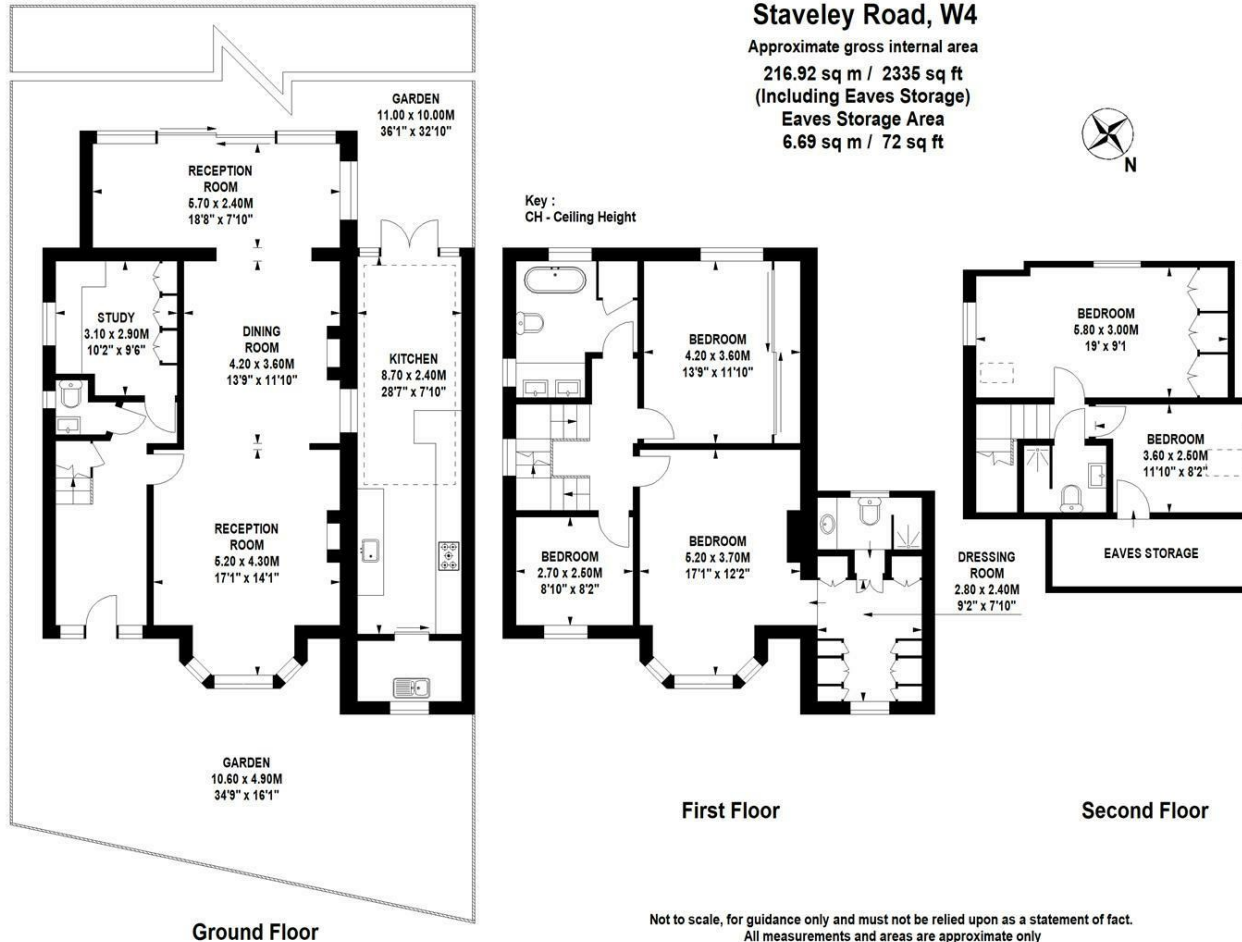
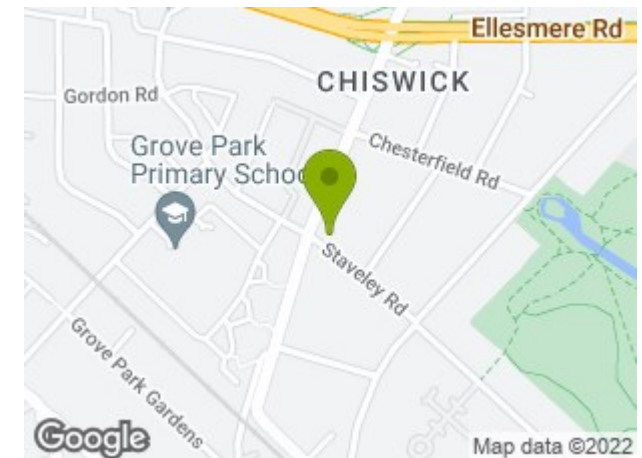

5-7 Turnham Green Terrace, Chiswick, London, W4 1RG

Tel 020 8747 8800

E-mail sales@whitmanandco.com

Website www.whitmanandco.com



MISREPRESENTATION ACT 1967

Whitman & Co. for themselves and for the vendors give notice that these particulars do not constitute any part of, an offer of contract. All statements contained in these particulars are made without responsibility on the part of Whitman & Co. or the vendor. None of the statements contained in these particulars is to be relied upon as statements or representations of facts. Any intending purchaser must satisfy himself by inspection or otherwise as to the correctness of each of the statements contained in these particulars. The vendor does not make or give, and neither Whitman & Co. or any person in their employment has any authority to make or give, any representation or warranty whatever in relation to the property.