



Cavendish Road, London, W4 3UH

Guide Price £3,500,000

**WHITMAN & CO.**

SALES · LETTINGS · COMMERCIAL

- Double fronted detached family home
- Large 1/3 acre plot with huge rear garden
- Uninterrupted views over playing fields
- Feature entrance hall and landing
- Exceptional reception space
- Off street parking for 3 cars

Tenure - Freehold  
Local Authority - Hounslow  
Council Tax - Band G

## THE PROPERTY

A unique double fronted detached family home of 3500 sqft offering an excellent balance of living and entertaining space, unrivalled views across playing fields, and sitting on a plot of approximately 1/3 acre. This superb family home offers a master bedroom with a large ensuite bathroom/dressing room and balcony overlooking the garden, four further bedrooms all with wonderful views, three further bathrooms (one ensuite), a majestic entrance hall with galleried landing, stunning reception room with feature curved glass French doors opening onto the garden, two further reception rooms, 40' bespoke kitchen/dining/family room, 125' x 91' (at maximum) private landscaped garden with stunning raised deck area and off street parking for three cars. Ideally located in this prestigious residential road as a stand-alone residence with uninterrupted views and close proximity to numerous amenities.

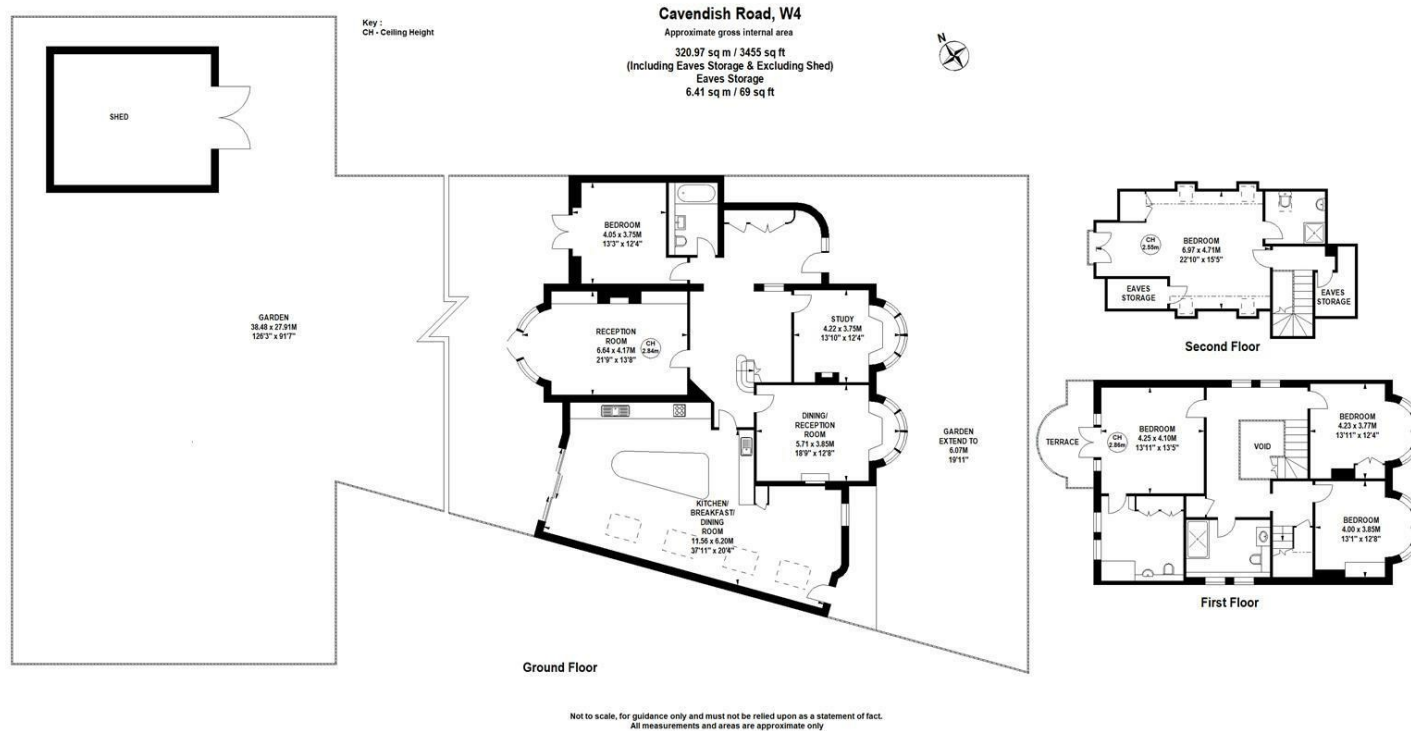

## SITUATION



5-7 Turnham Green Terrace, Chiswick, London, W4 1RG

Tel 020 8747 8800

E-mail [sales@whitmanandco.com](mailto:sales@whitmanandco.com)

Website [www.whitmanandco.com](http://www.whitmanandco.com)