

## 178 Upper Richmond Road London, SW15

Central Putney with a secure allocated parking space as well as two bedrooms and far reaching views across London, what more could you want!? This bright and spacious apartment is an ideal first purchase or investment as the location is brilliant and has the advantage of a secure allocated parking space..

Situated on the top floor of this modern block close to all of Putney's amenities with no chain this is a "must see" flat.

The property is moments from Putney overground station which is a short distance to Clapham Junction and Waterloo Stations. East Putney underground station is also about a 5 minute walk away.

EPC - C Council Tax Band D



Asking Price £425,000  
Leasehold - Share of Freehold









## Salisbury Court, SW15

Approx. Total Internal Area 620 Sq Ft - 57.60 Sq M  
(Including Restricted Height Area)

Approx. Gross Internal Area 611 Sq Ft - 56.76 Sq M  
(Excluding Restricted Height Area)

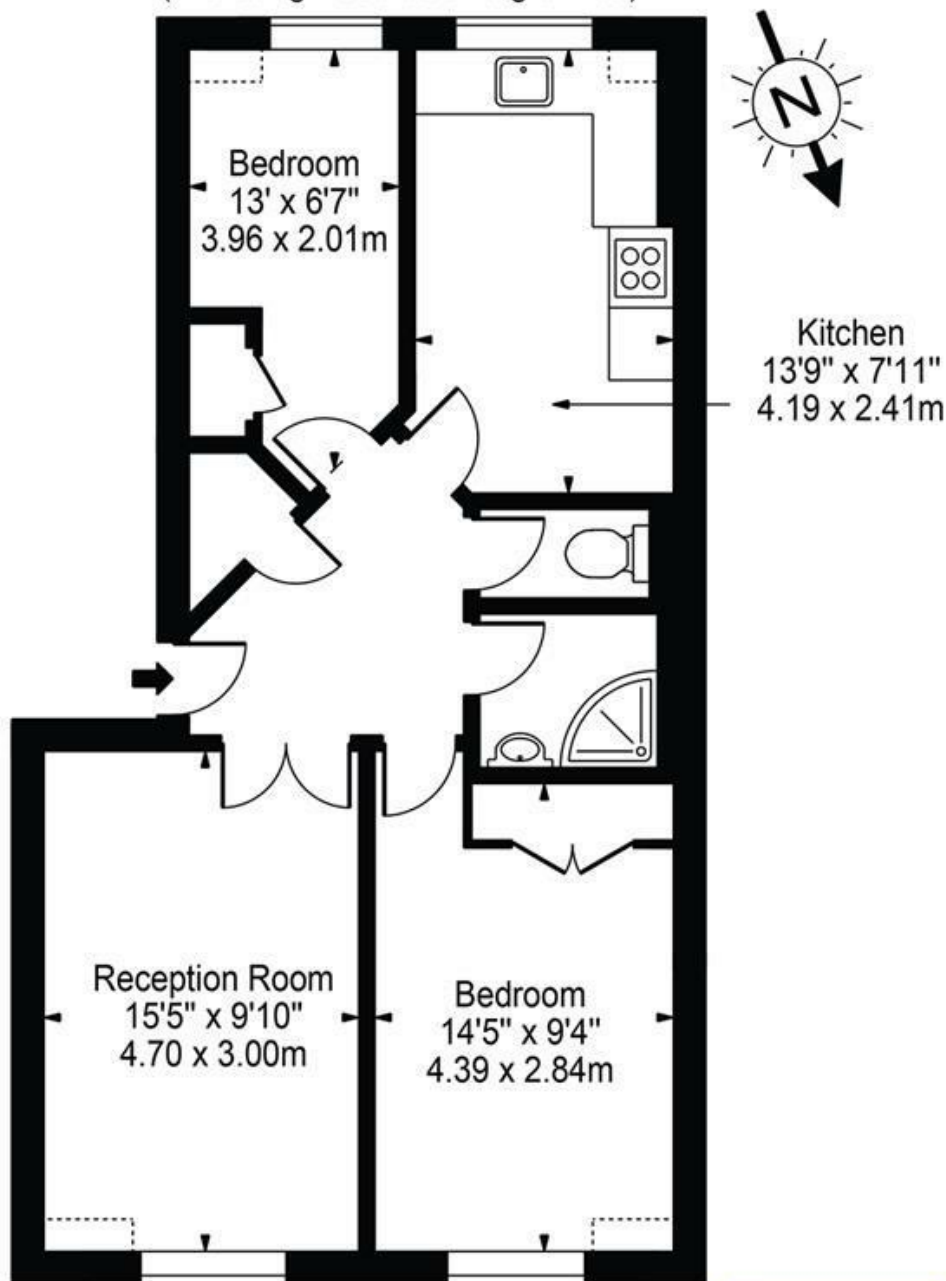

Third Floor

ALLAN FULLER

EST. 1983

©

For Illustration Purposes Only - Not To Scale Floor Plan by Mira Nikolova Photography

This floor plan should be used as a general outline for guidance only and does not constitute in whole or in part an offer or contract.  
Any intending purchaser or lessee should satisfy themselves by inspection, searches, enquiries and full survey as to the correctness of each statement.  
Any areas, measurements or distances quoted are approximate and should not be used to value a property or be the basis of any sale or let.

With regards to any information supplied by us in relation to lease, ground rent and service charge it is essential that you have this information checked by your solicitor. We have transmitted information supplied to us by the vendor of the property but we have not been able to inspect the lease to check its accuracy. Please note that we have not tested any of the equipment or utilities at this property, nothing in these particulars shall be deemed a statement that the property is in good condition or otherwise nor that any of the services or facilities are in good working order. Measurements are approximate they were taken with a sonic tape, are as accurate as possible and usually measured from the widest point of any room. Description provided herein represents the opinion of the author, is given in good faith but should not be constructed as statements of fact. The particulars and photograph are for guidance only.