

# WAYNE & SILVER



321 Shirland Road  
Maida Vale, London, W9 3JJ  
Asking Price £800,000

A brand new and extended two bedroom garden apartment. The property benefits from two ensuite shower rooms and a further guest WC. This new property has been completed renovated to include new windows, heating and electrics. There is a large kitchen leading to the reception which has attractive tiled flooring and level access to the private rear garden. There is a further separate outside seating area off the kitchen and a new video entry phone system.

## Viewing

Please contact our Wayne & Silver Sales Office on 020 7431 4488 if you wish to arrange a viewing appointment for this property or require further information.



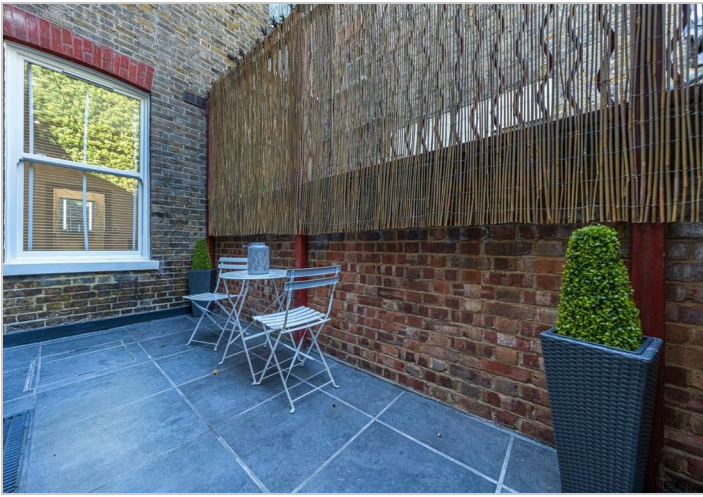

### Energy Efficiency Graph

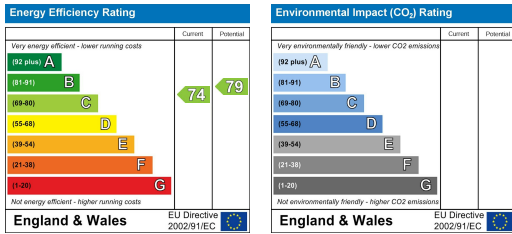

### Floor Plan

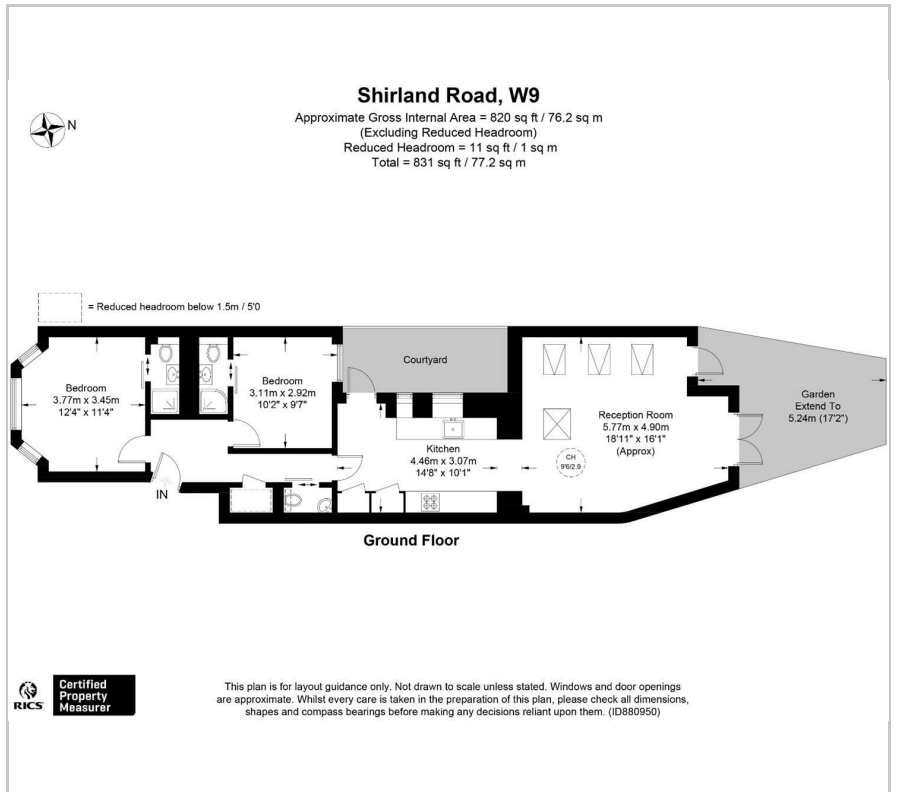

### Area Map



These particulars, whilst believed to be accurate are set out as a general outline only for guidance and do not constitute any part of an offer or contract. Intending purchasers should not rely on them as statements of representation of fact, but must satisfy themselves by inspection or otherwise as to their accuracy. No person in this firm's employment has the authority to make or give any representation or warranty in respect of the property.