



## A FOUR BEDROOM DETACHED HOUSE IN A QUIET CUL DE SAC

Kingfisher Close, Northwood, Middlesex HA6 2UGs

**ROBSONS**



# A FOUR BEDROOM HOUSE IN A QUIET CUL DE SAC LOCATION

Kingfisher Close, Northwood, Middlesex HA6 2UG

**THREE RECEPTION ROOMS • KITCHEN • CLOAKROOM • MAIN BEDROOM WITH ENSUITE BATHROOM • THREE FURTHER BEDROOMS • BATHROOM • REAR GARDEN • GARAGE • OFF STREET PARKING**

## Description

A fantastic opportunity to acquire this four bedroom, two bathroom detached house to put your own stamp on the property, available to the market with no onward chain..

Positioned on a sought after quiet cul-de-sac in Northwood, this property benefits from a detached garage and off street parking. To the ground floor there is a large reception room with French doors leading to a beautiful garden, study and a further dining room. The kitchen benefits from a great size utility. To the first floor there are four double bedrooms with an en-suite to the master bedroom.

The property also benefits of great potential to extend subject to planning permission.







### Description

Northwood provides a range of shopping facilities, a Waitrose supermarket, restaurants and the Metropolitan Line Station providing access to Baker Street and the city beyond. The area has a range of both private and state schools. Places of worship and recreational facilities are also well catered for in the surrounding area and major motorway links to M25 and M1 are nearby.

### Additional Information

Tenure: Freehold

Council: London Borough of Hillingdon

Council Tax Band: G

Energy Efficiency Rating Band: C



Kingfisher Close, Northwood  
 Approximate Gross Internal Area  
 Main House = 137 SqM/1475 SqFt  
 Garage = 15 SqM/161 SqFt  
 Total = 152 SqM/1636 SqFt

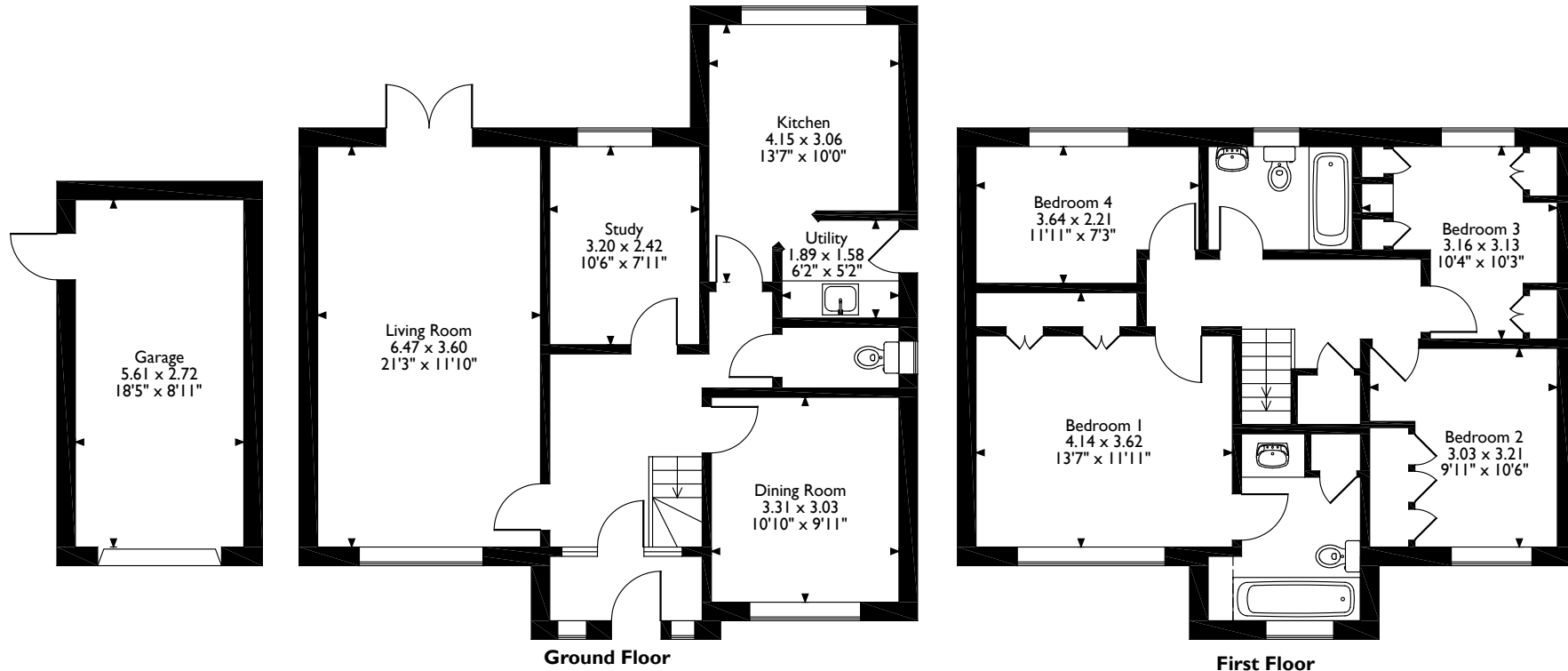

Please note that the location of doors, windows and other items are approximate and this floorplan is to be used for illustrative purposes only. Unauthorized reproduction is prohibited.

**ROBSONS**

7 Clive Parade, Northwood, Middlesex HA6 2QF  
 Tel: 01923 835355 northwood@robsonswb.com

[www.robsonswb.com](http://www.robsonswb.com)

[www.the-londonoffice.co.uk](http://www.the-londonoffice.co.uk)  
 40 ST JAMES'S PLACE SW1

Important notice: Robsons, their clients and any joint agents give notice that 1: They are not authorised to make or give any representations or warranties in relation to the property either here or elsewhere, either on their own behalf or on behalf of their client or otherwise. They assume no responsibility for any statement that may be made in these particulars. These particulars do not form part of any offer or contract and must not be relied upon as statements or representations of fact. 2: Any areas, measurements or distances are approximate. Plot sizes and dimensions are taken from Promap and are approximate. The text, photographs and plans are for guidance only and are not necessarily comprehensive. It should not be assumed that the property has all necessary planning, building regulation or other consents and Robsons have not tested any services, equipment or facilities. Purchasers must satisfy themselves by inspection or otherwise.