



Yeoman Street, Surrey Quays

Asking Price £575,000 Leasehold

OLIVER *OJ* JAQUES
EST. 1986



Yeoman Street, Surrey Quays

A remarkably bright south-west facing apartment on the top floor of Leeward Court with floor to ceiling windows throughout making the most of the already-generous proportions. Spanning 800sqft, the property occupies the end of the building allowing for a triple-aspect reception room which leads on to a spacious south-west facing balcony. The two bedrooms are more than adequate doubles, with the en suite master having built in wardrobes and access to its own separate balcony. Leeward Court was constructed by Higgins Homes less than 6 years ago and therefore this unit still has part of its New Build Warranty to run and is still presented in as high an order as when it was new. Lovingly maintained by the current devoted owners, the property makes a great home on the cusp of Surrey Quays.

- Two Double Bedrooms
- Two Bathrooms
- Two Balconies
- Top Floor Apartment with Lift Access
- Floor to Ceiling Windows
- Triple Aspect Living Areas

South East London

020 7231 5050

Email southeast@o-j.co.uk

229-231 Lower Road, London, SE16 2LW

web www.o-j.co.uk

Every care has been taken with the preparation of this brochure but it is for general guidance only and complete accuracy cannot be guaranteed. If there is any point, which is of importance professional verification should be sought. This brochure does not constitute a contract or part of a contract. We are not qualified to verify tenure of property. Prospective purchasers should seek clarification from their solicitor or verify the tenure of this property for themselves by visiting www.landregisteronline.gov.uk. The mention of any appliances, fixtures or fittings does not imply they are in full working order. Photographs are reproduced for general information and it cannot be inferred that any item shown is included in the sale. All dimensions are approximate. Walking times are taken from Google Maps and measured from the centre of the postcode, which may differ slightly from the individual property.

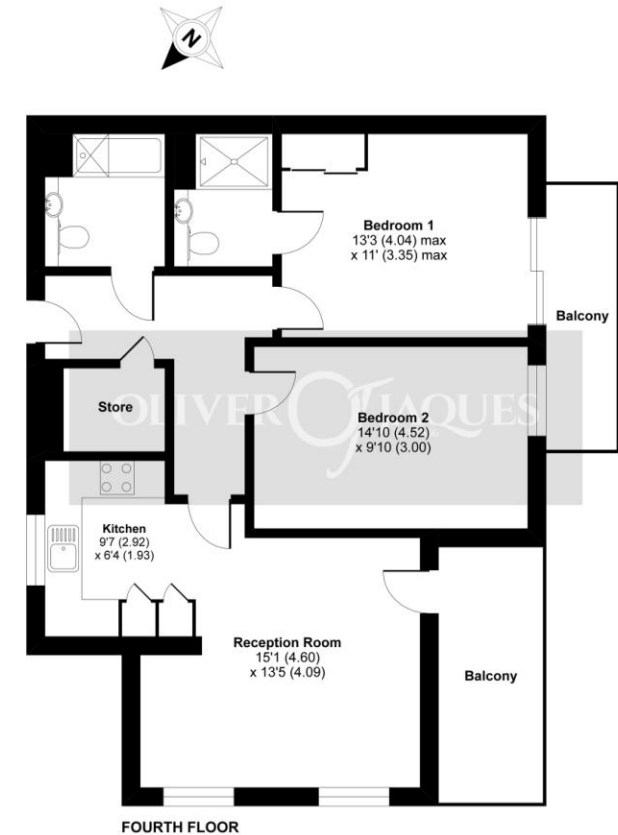

RICS Certified Property Measurer Floor plan produced in accordance with RICS Property Measurement Standards incorporating International Property Measurement Standards (IPMS2 Residential). ©ricshcom 2020. Produced for Oliver Jacques - REF: 607616

