

WAYNE & SILVER



Crooked Usage, London, N3 3HB
Price Guide £3,000,000





Crooked Usage

London, N3 3HB

A beautifully presented detached residence situated on one of Finchley's most sought after turnings, offering approx. 5,105 sq. ft of flexible accommodation over only two floors.

This substantial home comprises of two interconnecting properties, in the main building: a large 23ft drawing room, a 20 ft dining room with connecting formal reception room, a large open plan kitchen leading out to the garden, in the adjoining home a 2nd modern kitchen/living/dining room which was recently refurbished.

Master suite with dressing area and bathroom, 6 further bedrooms which benefits 4 en-suite bathrooms/shower rooms, family bathroom and guest WC.

The property further features a double height entrance hall with a gallery on the first floor, carriage driveway suitable for multiple cars. There is also great potential to create another floor of accommodation (subject to the usual local consents).

On the lower ground level there is a storage space which was previously a swimming pool and has the potential to be converted back.

Crooked Usage is positioned just a short distance from all of the local amenities and travel links that both Finchley and Temple Fortune high streets afford.

Sole Agents

Council Tax Band: H

Council: Barnet



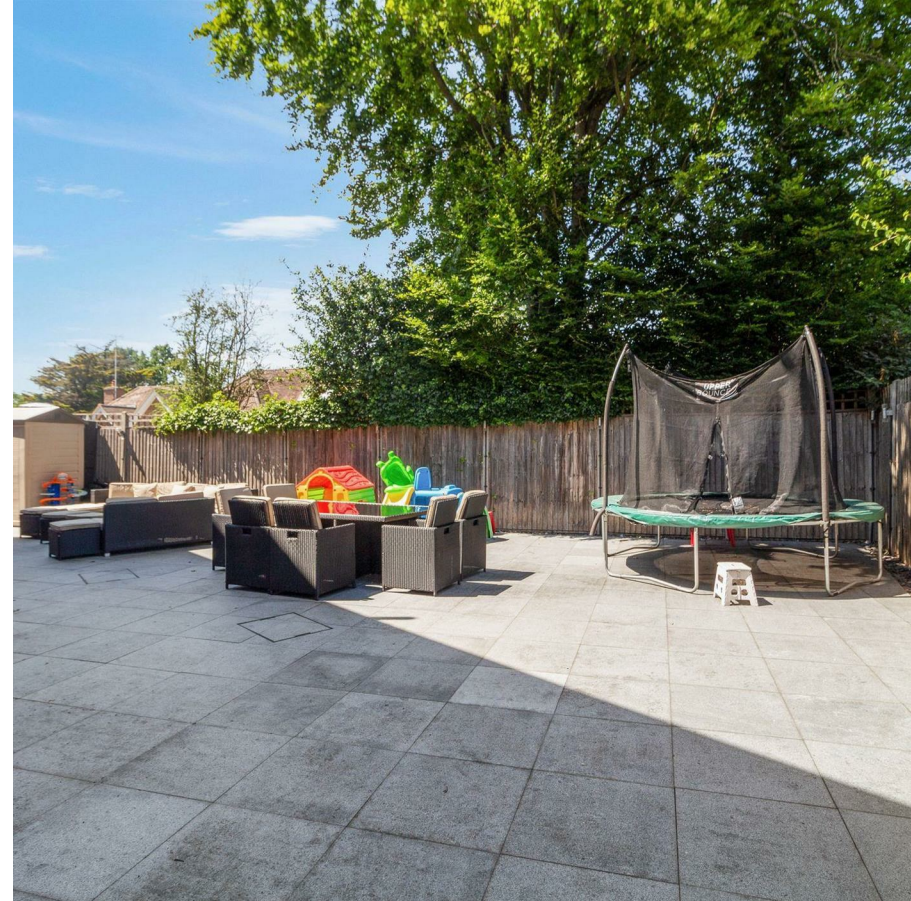



Floor Plans

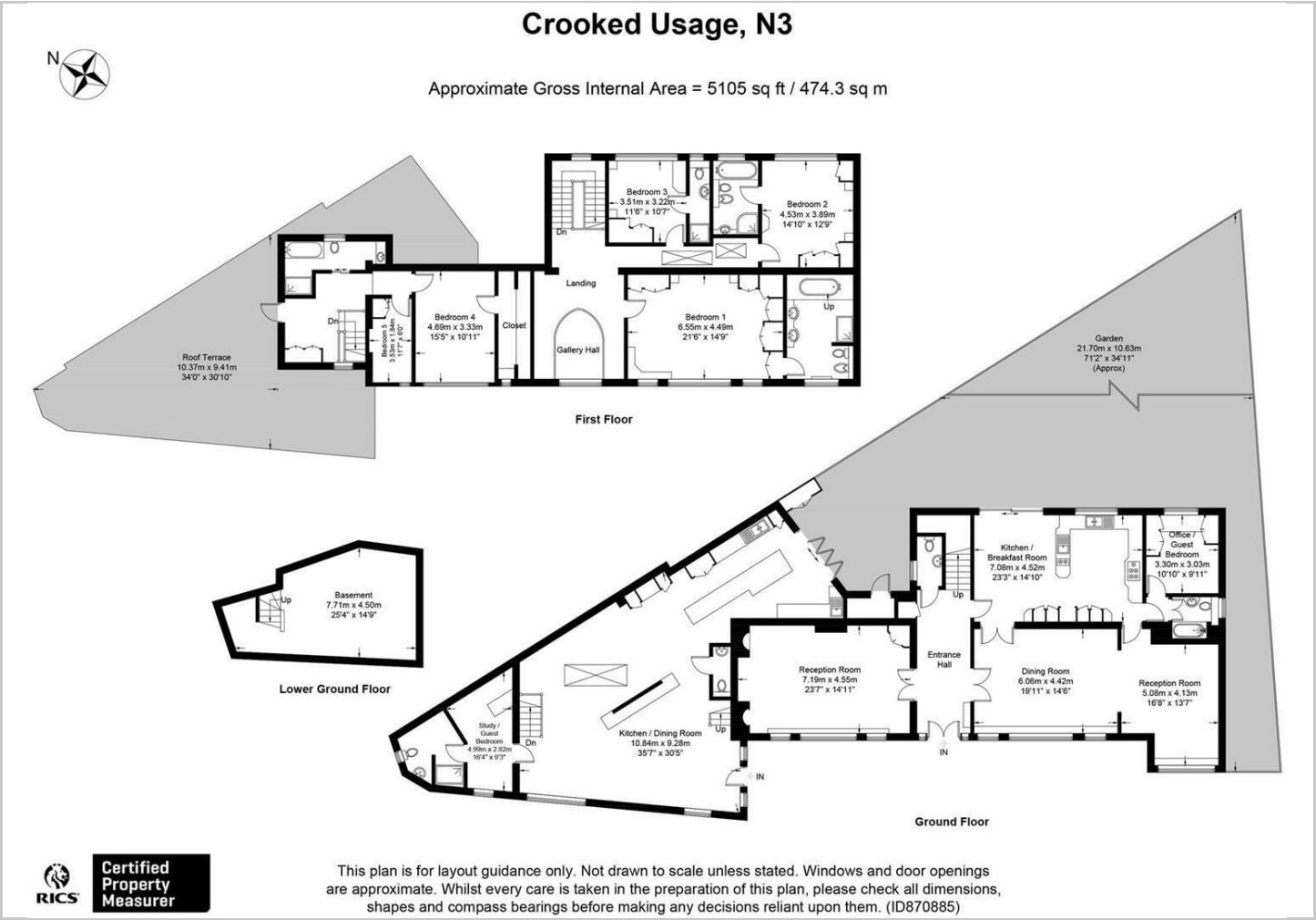

Location Map



Energy Performance Graph

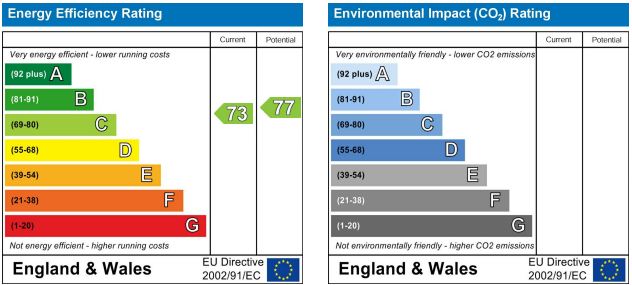

The particulars are set out as a general outline only for the guidance of intended purchasers or lessees, and do not constitute, any part of a contract. Nothing in these particulars shall be deemed to be a statement that the property is in good structural condition or otherwise nor that any of the services, appliances, equipment or facilities are in good working order. Purchasers should satisfy themselves of this prior to purchasing.