

# Ormsby Lodge W4 1HS

Approximate Gross Internal Area = 56.2 sq m / 605 sq ft

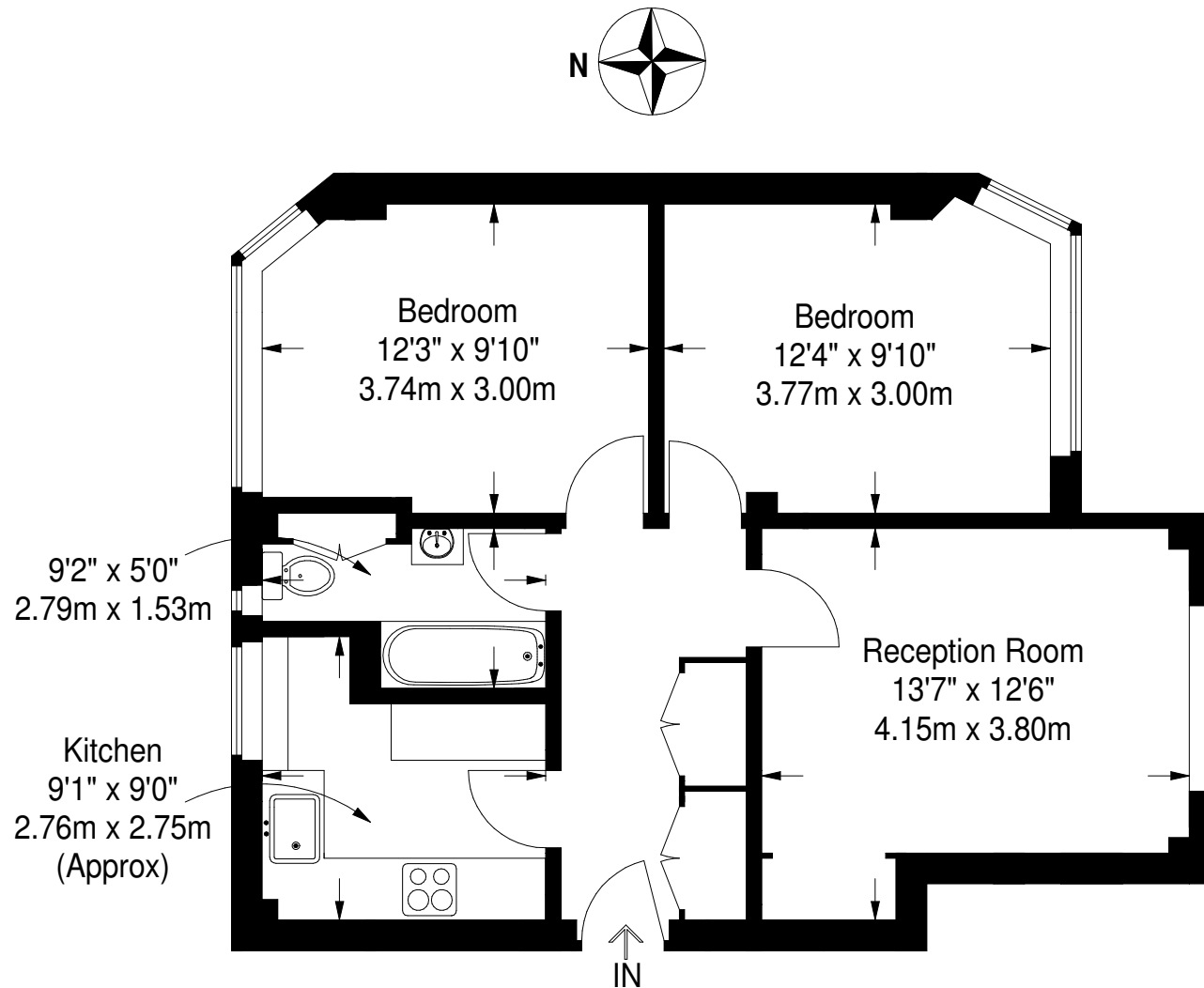

## Second Floor

Measured in accordance with RICS guidelines. To be used for identification and guidance purposes only. Not to scale.

© Photos Plans and EPCs | Tel: 07774 688 771 | info@photosplansandepcs.com | www.photosplansandepcs.com