

25 Longfield Drive
Leeds, , LS15 7UD

Asking Price Of **£139,950**

Property Features



- Great first time buyer property
- Enclosed rear garden
- Garage
- Parking
- Quiet cul-de-sac
- Shops and amenities close by
- Transport links close by
- Easy access to motorway
- Short walk to attractive parkland



Full Description

SUMMARY

Presenting a homely two bedroomed property in a very convenient location and benefitting from a garden, garage, and parking. This appealing home is situated at the end of a quiet cul-de-sac within a short walk of shops, amenities, excellent public transport links, and attractive parkland.

LOCATION

Longfield Drive is conveniently positioned within a cul-de-sac a short walk from the centre of Halton, where a range of shops, amenities, and bus connections can be found. Primrose Valley Park is within a couple of minutes walk from the doorstep. Also within easy reach are Seacroft Hospital, the outer Ring Road, and motorway access beyond. Leeds city centre is 4 miles to the west by car. Cross Gates railway station is just 1 mile from the property.





COMPRISES

GROUND FLOOR

LOUNGE

14' 10" x 8' 2" (4.54m x 2.49m)

A spacious room having an open staircase and feature fireplace with electric stove. External wooden and glass panelled door. Laminate flooring. Double glazed window. Central heating radiator



KITCHEN-DINER

13' 3" x 8' 2" (4.04m x 2.49m)

White units, laminate work surfaces. Vinyl flooring. Worcester combination gas boiler. Double glazed window. Central heating radiator



FIRST FLOOR

BATHROOM

7' 11" x 6' 2" (2.42m x 1.89m)

A white modern three piece suite and mains shower over the bath. Partially tiled walls. Storage cupboard ideal for towels and linen. Double glazed window. Central heating radiator

BEDROOM 1

13' 3" x 11' 8" (4.04 maxm x 3.58 maxm)

Laminate floor. Double glazed window. Central heating radiator

BEDROOM 2 (REAR)

11' 4" x 6' 9" (3.46m x 2.07m)

Overlooking rear garden. Laminate floor. Double glazed window. Central heating radiator



EXTERNAL

A low maintenance enclosed rear garden with pebbled areas and planted beds.

GARAGE

A single garage which can be found on the right hand end of a row of 3, just opposite the house. Parking can also be found in front of the garage, directly in front of the house, or on street close by.



Ground Floor

Approx. 28.8 sq. metres (310.5 sq. feet)

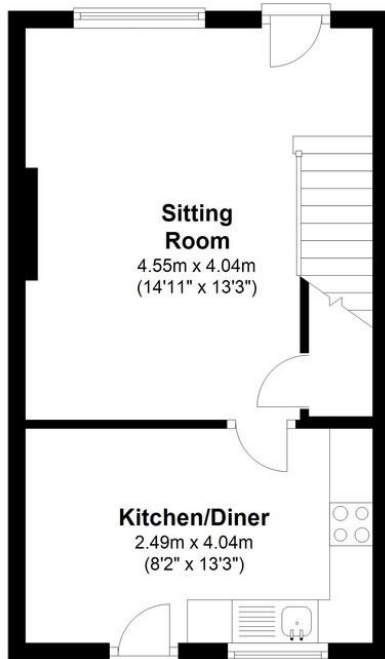

First Floor

Approx. 28.7 sq. metres (309.3 sq. feet)

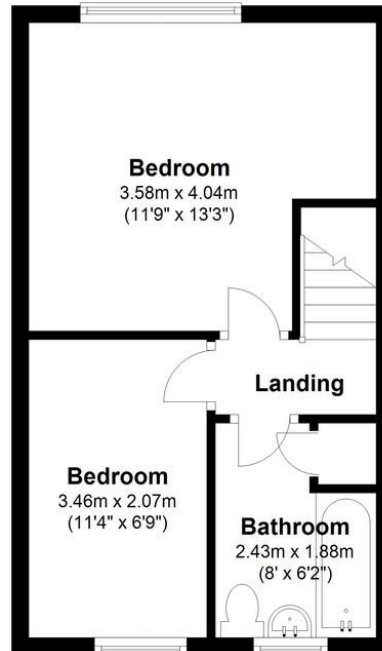

Total area: approx. 57.6 sq. metres (619.8 sq. feet)

Floor plans are for identification only. All measurements are approximate.
Plan produced using PlanUp.