

# Graham Road W4 5DR

Approximate Gross Internal Area  
 Ground Floor = 51 sq m / 549 sq ft  
 First Floor = 50.6 sq m / 545 sq ft  
 Second Floor = 34.3 sq m / 369 sq ft  
 Total = 135.9 sq m / 1463 sq ft

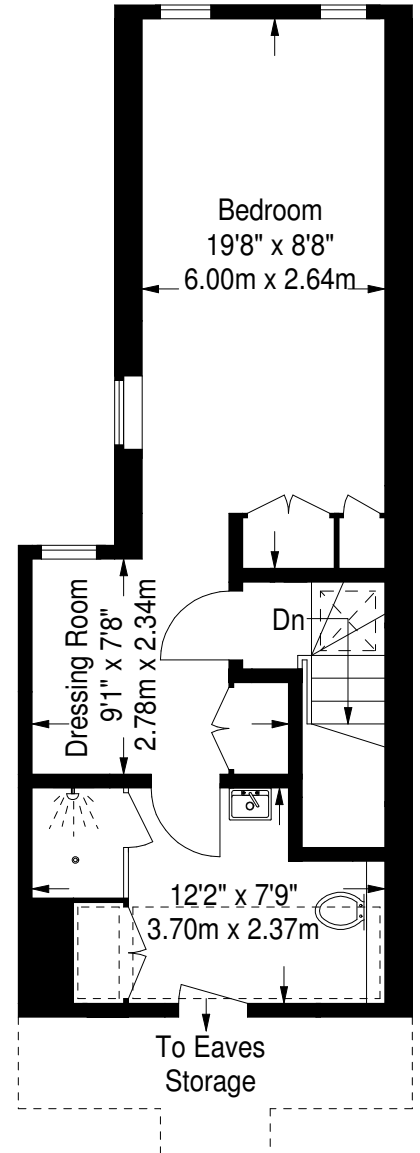
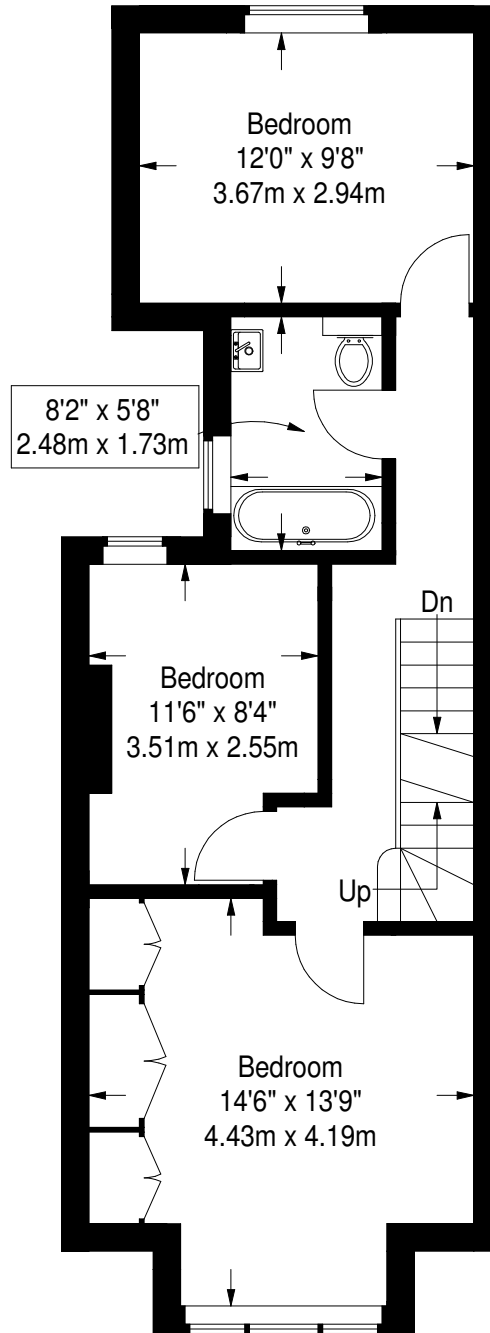
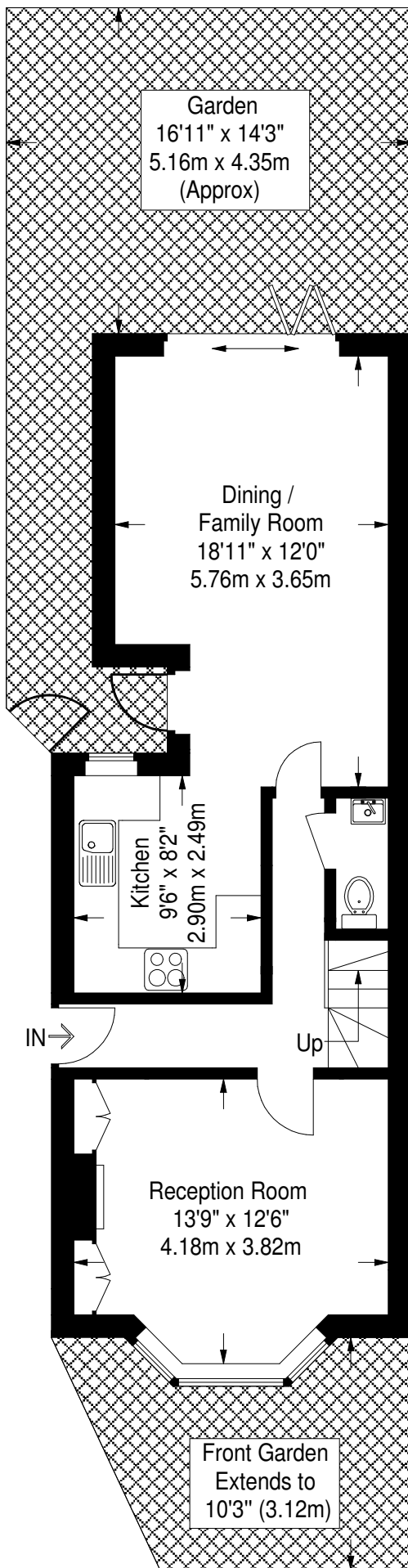

## Ground Floor

— = Reduced headroom  
 below 1.5 m / 5'0"