

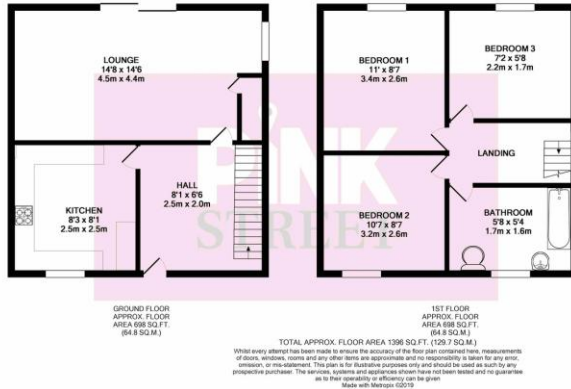

Bishops Gate  
£252,500



This charming three bedroom, end of terrace house is situated in a quiet part of Fareham close to Park Gate. With a garage, driveway and with close links to M27 this house is perfect for a family. Further benefiting from a south facing garden and up stairs bathroom this property is a must see.

**HALLWAY** 8' 1" x 6' 6" (2.46m x 1.98m) Smooth walls, soft carpet, stairs leading to upstairs landing.

**KITCHEN** 8' 3" x 8' 1" (2.51m x 2.46m) Double glazed window to front, mix of wall and base units, stainless sink and drainer, space for cooker and all white goods.

**LOUNGE** 14' 8" x 14' 6" (4.47m x 4.42m) Double glazed window to side, wood laminate flooring, smooth walls. Double glazed sliding doors leading out to garden.

**BEDROOM 1** 11' 0" x 8' 7" (3.35m x 2.62m) Double glazed window to rear, soft carpet and smooth walls.

**BEDROOM 2** 10' 7" x 8' 7" (3.23m x 2.62m) Double glazed window to front, soft carpet, smooth walls.

**BEDROOM 3** 7' 2" x 5' 8" (2.18m x 1.73m) Double glazed window to rear, soft carpet, smooth walls.

**BATHROOM** 5' 8" x 5' 4" (1.73m x 1.63m) Double glazed window to front, tiled walls and ceiling. w.c., ceramic sink, bath with shower over head.

**GARDEN** South facing, brick patio, lawn, and rear gated access.

**GARAGE & DRIVEWAY**  
**SOUTH FACING GARDEN**  
**CLOSE LINKS TO M27**  
**3 BEDROOMS**  
**END OF TERRACE**

**Notes**